

## Connector

**KLS** electronic  
www.cnkls.com

### D-SUB Series

#### KLS1-213 D-SUB 2 ROW SOLDER TYPE

##### Electrical Specification:

Current Rating: 2 AMP  
Insulator Resistance: 5000M ohms min. at DC 500V  
Contact Resistance: 20m ohms max. at DC 100mA  
Operating Temperature: -55°C~+105°C

##### Material:

Housing: 30% Glass filled PBT UL94V-0  
Contacts: Phosphor Bronze  
Shell: Steel, 100u" Tin Over 50u" min Nickel  
Clinch Nut: Brass, 100u" min Nickel Plated  
Screwlock: Brass, 100u" min Nickel Plated

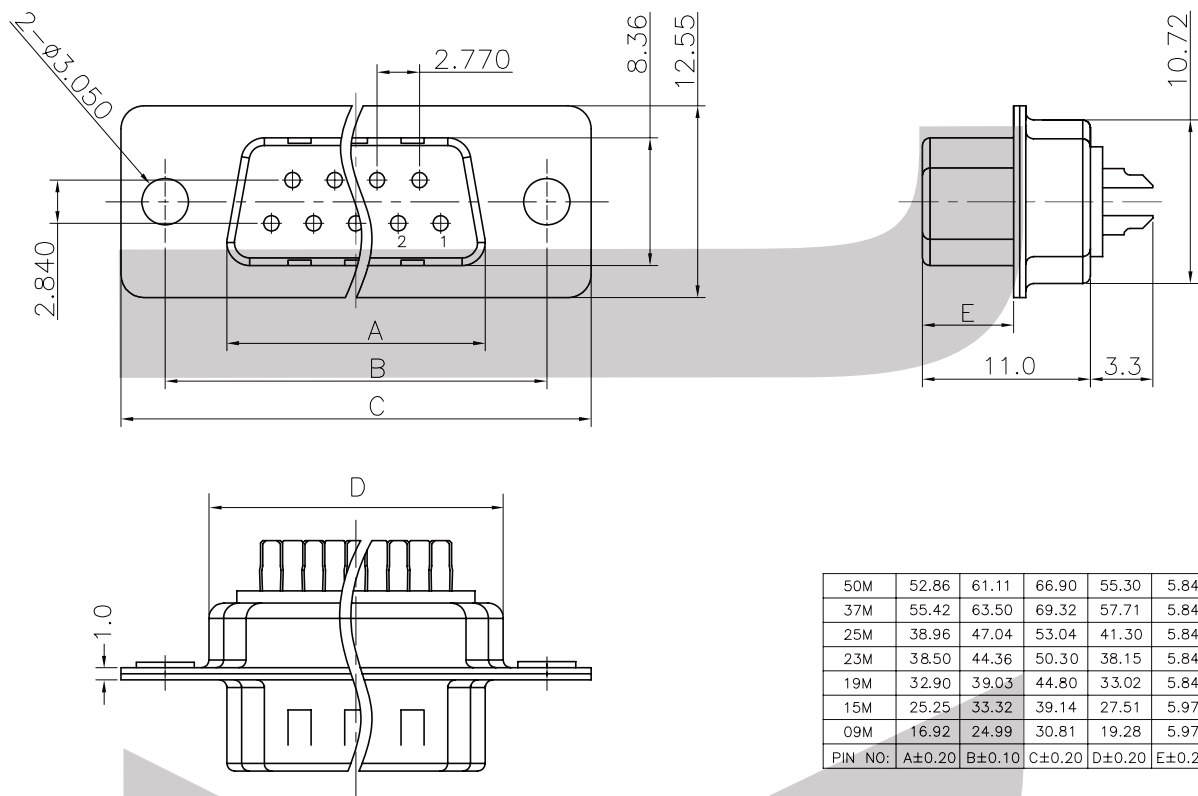
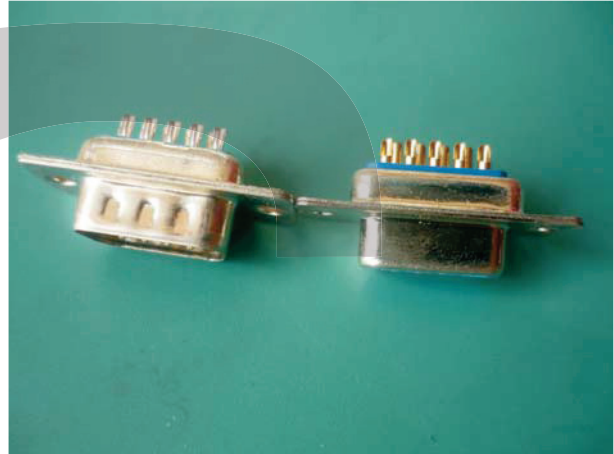

### ORDER INFORMATION

Product NO.: KLS1-213-XX - M -L

Pos. NO.  
001=001 pos.  
Contact Number of Row  
213=DB Series  
Number of Contacts

L=Blue B=Black W=White

M=Male F=Female