

KLS

1-Connectors & Connector Components-Разъемы, соединители и их узлы

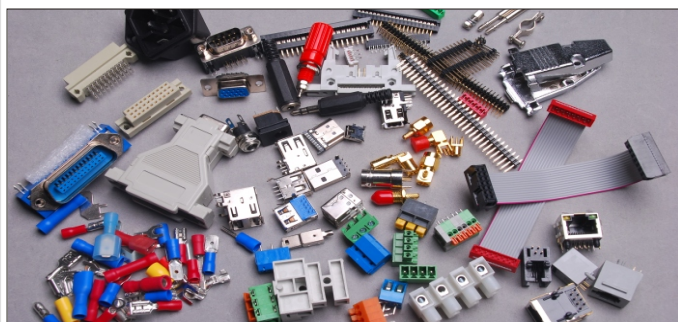

- 1-1 Wire to Board connectors
- 1-2 Board to Board connectors
- 1-3 Input/Output (Box to Box)
- 1-4 Socket & Card connectors
- 1-5 Power connectors
- 1-6 Audio & Video connectors
- 1-7 RF & Coax
- 1-8 **Terminal Blocks & Strips**
- 1-9 Terminals & Splices

More . . .

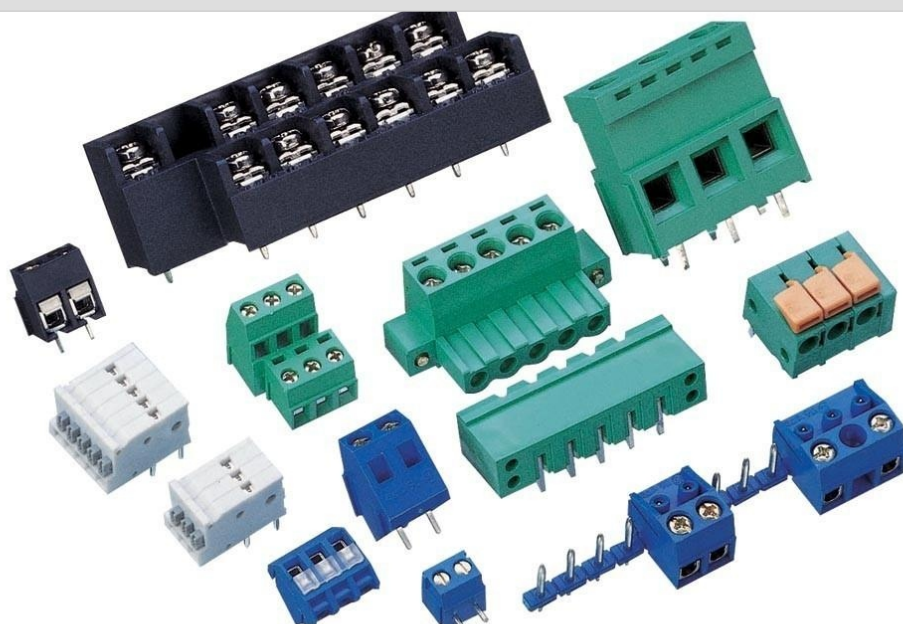

TERMINAL BLOCK Connector

KLSelectronic
www.cnkls.com

PCB Series

KLS2-350-3.50/3.96 Series Pitch=3.50mm/3.96mm

Electrical :

Rated voltage: 300V
Rated current: 10A
Contact resistance: 20mΩ
Insulation resistance: 5000MΩ/1000V
Withstanding Voltage: AC1500V/1Min
Wire range: 24-18AWG 2.5mm²

Material

Screws: M2.5 steel Zinc plated
Wire guard: phosphor bronze Ni plated or stainless steel
Pin header: Brass, Tin plated
Housing: PA66, UL94V-0

Mechanical

Temp. Range: -30°C~+120°C
MAX Soldering: +250°C for 5 Sec.
Torque: 0.5Nm (4.5lb.in)
Strip length: 4.5-5mm

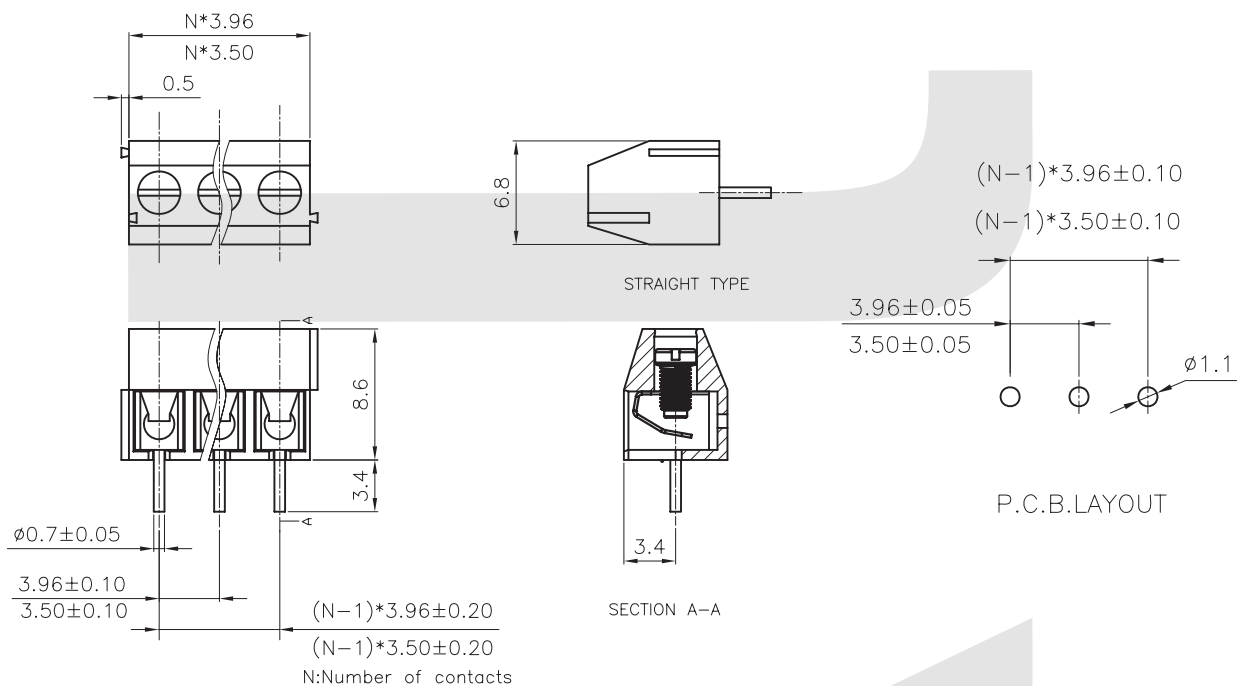
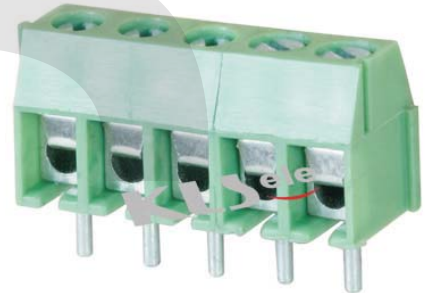

ORDER INFORMATION

Product NO.: KLS2-350-3.50-XXP X X X

Pos. NO.

Series No.

Pitch: 3.50=3.50mm 3.96=3.96mm

Number of Pole

Customer Request

Screw: C=Cross Screw
S=Slot Screw

Color: 1=Gray 2=Blue 3=Black
4=Green 5=Orange 6=Red
7=Transparent 8=Yellow 9=White

All specification & dimensions are subject to change, please call your nearest KLS sales representative for update information

TERMINAL BLOCK Connector

KLSelectronic
www.cnkls.com

PCB Series

KLS2-350R-3.50/3.96 Series Pitch=3.50mm/3.96mm

Electrical :

Rated voltage: 300V
Rated current: 10A
Contact resistance: 20mΩ
Insulation resistance: 5000MΩ/1000V
Withstanding Voltage: AC1500V/1Min
Wire range: 24-18AWG 2.5mm²

Material

Screws: M2.5 steel Zinc plated
Wire guard: phosphor bronze Ni plated or stainless steel
Pin header: Brass, Tin plated
Housing: PA66, UL94V-0

Mechanical

Temp. Range: -30°C~+120°C
MAX Soldering: +250°C for 5 Sec.
Torque: 0.5Nm (4.5lb.in)
Strip length: 4.5-5mm

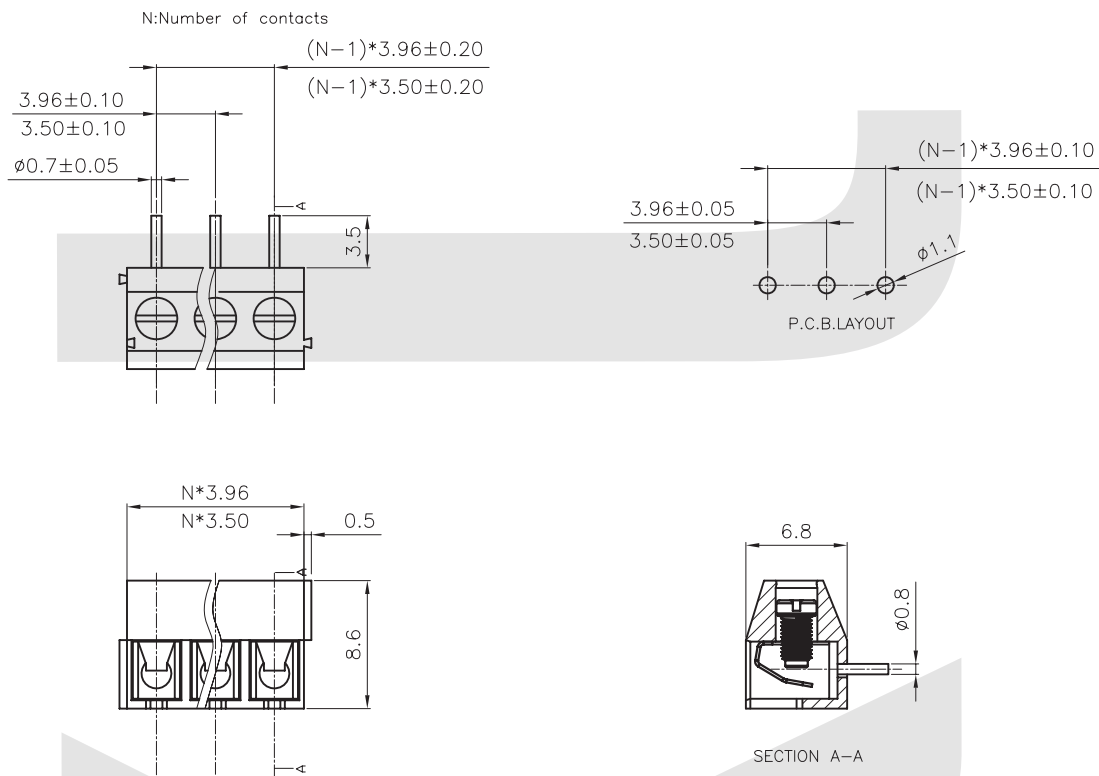
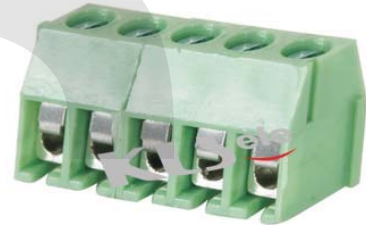

ORDER INFORMATION

Product NO.: KLS2-350R-3.50-XXP X X X

Pos. NO.

Series No.

Pitch: 3.50=3.50mm 3.96=3.96mm

Number of Pole

Customer Request

Screw: C=Cross Screw

S=Slot Screw

Color: 1=Gray

4=Green

7=Transparent

2=Blue

5=Orange

8=Yellow

3=Black

6=Red

9=White

All specification & dimensions are subject to change, please call your nearest KLS sales representative for update information

TERMINAL BLOCK Connector

KLS electronic
www.cnkls.com

PCB Series

KLS2-332K-5.00 Series Pitch=5.00mm/10.00mm

Electrical :

Rated voltage: 300V
Rated current: 16A
Contact resistance: 20mΩ
Insulation resistance: 5000MΩ/1000V
Withstanding Voltage: AC1500V/1Min
Wire range: 22-14AWG 2.5mm²

Material

Screws: M2.5 steel Zinc plated
Wire guard: phosphor bronze Ni plated or stainless steel
Housing: PBT,UL94V-0

Mechanical

Temp. Range: -40°C~+105°C
MAX Soldering: +250°C for 5 Sec.
Torque: 0.4Nm (3.6lb.in)
Strip length: 4.5-5mm

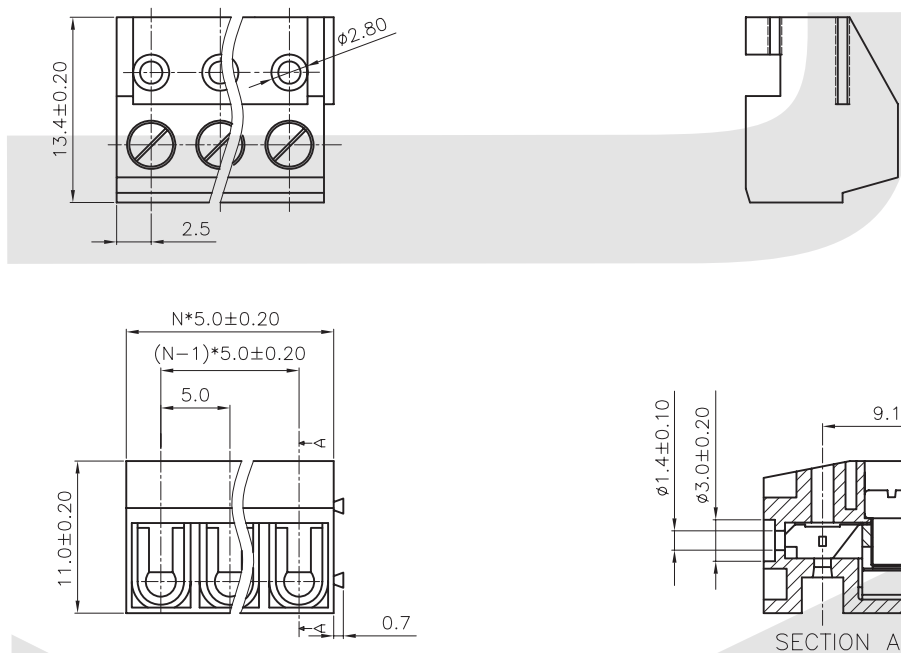

ORDER INFORMATION

Product NO.: KLS2-332K-5.00-XXP X X X

Pos. NO.	_____	Customer Request
Series No.	_____	Screw: C=Cross Screw S=Slot Screw
Pitch: 5.00=5.00mm 10.00=10.00mm	_____	Color: 1=Gray 2=Blue 3=Black 4=Green 5=Orange 6=Red 7=Transparent 8=Yellow 9=White
Number of Pole	_____	

All specification & dimensions are subject to change, please call your nearest KLS sales representative for update information

TERMINAL BLOCK Connector

KLSelectronic
www.cnkls.com

PCB Series

KLS2-332J-5.00 Series Pitch=5.00mm/10.00mm

Electrical :

Rated voltage: 300V
Rated current: 10A
Contact resistance: 20mΩ
Insulation resistance: 5000MΩ/1000V
Withstanding Voltage: AC1500V/1Min
Wire range: 22-14AWG 2.5mm²

Material

Pin header: Brass, Tin plated
Housing: PBT,UL94V-0

Mechanical

Temp. Range: -30°C~+105°C
MAX Soldering: +250°C for 5 Sec.
Torque: 0.4Nm (3.6lb.in)
Strip length: 4.5-5mm

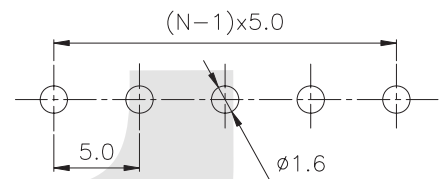

N:NUMBER OF CONTACTS
 $N \times 5.0 \pm 0.3$

RECOMMEND PCB LAYOUT
(TOLERANCE=±0.05)

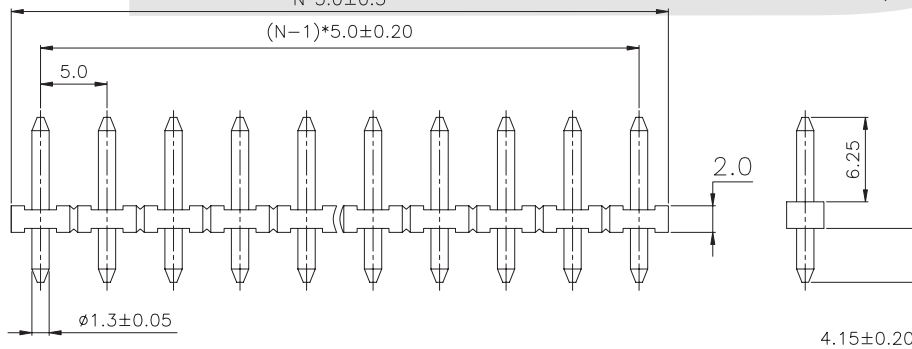

ORDER INFORMATION

Product NO.: KLS2-332J-5.00-XXP X X

Pos. NO.

Series No.

Pitch: 5.00=5.00mm
10.00=10.00mm

Number of Pole

Customer Request

Color: 1=Gray
4=Green
7=Transparent

2=Blue
5=Orange
8=Yellow

3=Black
6=Red
9=White

All specification & dimensions are subject to change, please call your nearest KLS sales representative for update information

TERMINAL BLOCK Connector

KLSelectronic
www.cnkls.com

PCB Series

KLS2-125-3.50/3.81 Series Pitch=3.50mm/3.81mm

Electrical :

Rated voltage: 300V
Rated current: 10A
Contact resistance: 20mΩ
Insulation resistance: 5000MΩ/1000V
Withstanding Voltage: AC1500V/1Min
Wire range: 24-12AWG 1.5mm²

Material

Screws: M2 steel Zinc plated
Contact: Brass
Pin header: Brass, Tin plated
Housing: PA66, UL94V-0

Mechanical

Temp. Range: -40°C~+105°C
MAX Soldering: +250°C for 5 Sec.
Torque: 0.2Nm (1.8lb.in)
Strip length: 5-6mm

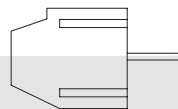
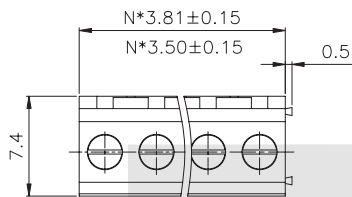

STRAIGHT TYPE

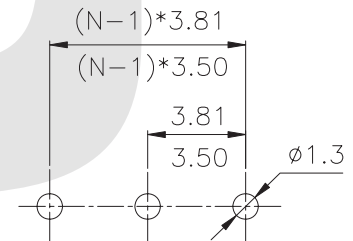

RECOMMEND PCB LAYOUT
(TOLERANCE=±0.05)

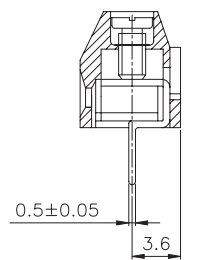
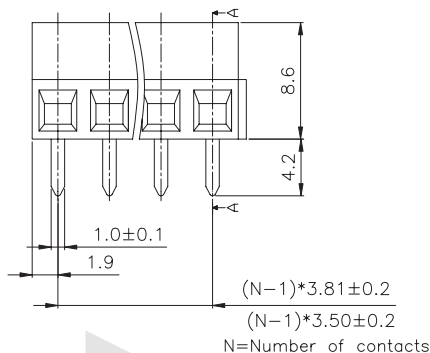

SECTION A-A

ORDER INFORMATION

Product NO.: KLS2-125-3.50-XXP X X X

Pos. NO.

Series No.

Pitch: 3.50=3.50mm 3.81=3.81mm

Number of Pole

Customer Request

Screw: C=Cross Screw
S=Slot Screw

Color: 1=Gray 2=Blue 3=Black
4=Green 5=Orange 6=Red
7=Transparent 8=Yellow 9=White

All specification & dimensions are subject to change, please call your nearest KLS sales representative for update information

TERMINAL BLOCK Connector

KLSelectronic
www.cnkls.com

PCB Series

KLS2-125H-3.50/3.81 Series Pitch=3.50mm/3.81mm

Electrical :

Rated voltage: 150V
Rated current: 10A
Contact resistance: 20mΩ
Insulation resistance: 5000MΩ/1000V
Withstanding Voltage: AC2000V/1Min
Wire range: 26-16AWG 1.5mm²

Material

Screws: M2 steel Zinc plated
Contact: Brass, Ni plated
Pin header: Brass, Tin plated
Housing: PA66, UL94V-0

Mechanical

Temp. Range: -40°C~+105°C
MAX Soldering: +250°C for 5 Sec.
Torque: 0.2Nm (1.7 lb.in)
Strip length: 5-6mm

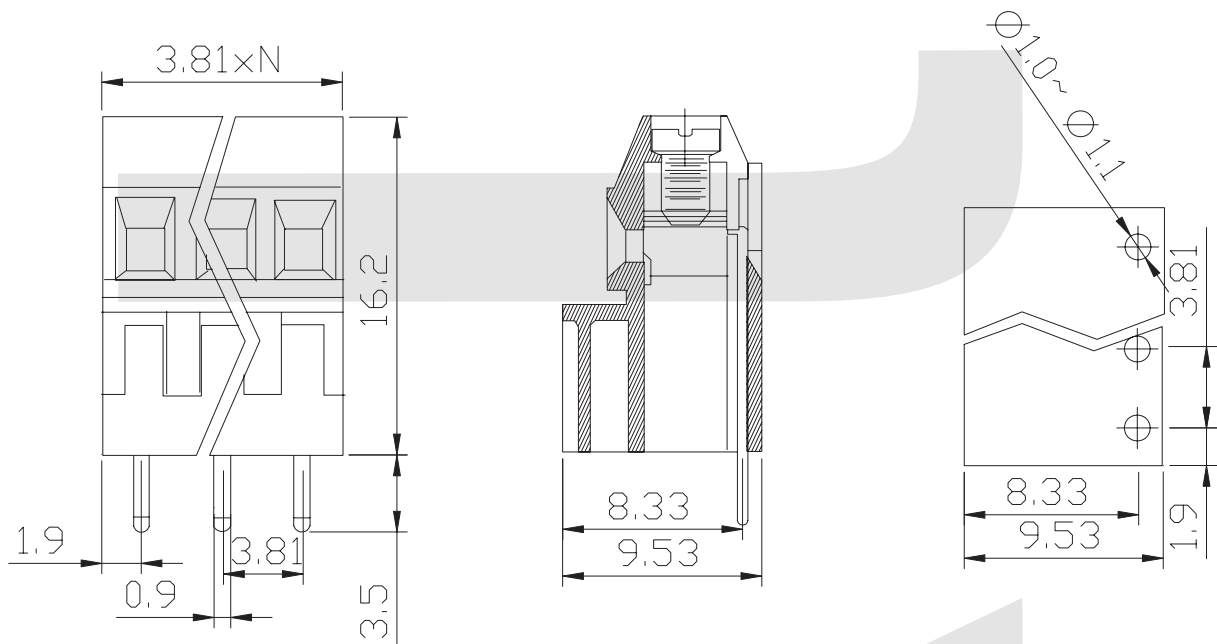

ORDER INFORMATION

Product NO.: KLS2-125H-3.81-XXP X X X

Pos. NO.

Series No.

Pitch: 3.50=3.50mm
3.81=3.81mm

Number of Pole

Customer Request

Screw: C=Cross Screw
S=Slot Screw

Color: 1=Gray 2=Blue 3=Black
4=Green 5=Orange 6=Red
7=Transparent 8=Yellow 9=White

All specification & dimensions are subject to change, please call your nearest KLS sales representative for update information

TERMINAL BLOCK Connector

KLSelectronic
www.cnkls.com

PCB Series

KLS2-125A-3.50/3.81 Series Pitch=3.50mm/3.81mm

Electrical :

Rated voltage: 150V
Rated current: 10A
Contact resistance: 20mΩ
Insulation resistance: 5000MΩ/1000V
Withstanding Voltage: AC2000V/1Min
Wire range: 26-16AWG 1.5mm²

Material

Screws: M2 steel Zinc plated
Contact: Brass, Ni plated
Pin header: Brass, Tin plated
Housing: PA66, UL94V-0

Mechanical

Temp. Range: -40°C~+105°C
MAX Soldering: +250°C for 5 Sec.
Torque: 0.2Nm (1.7 lb.in)
Strip length: 5-6mm

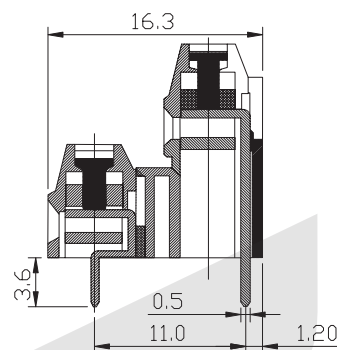
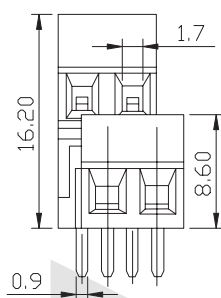
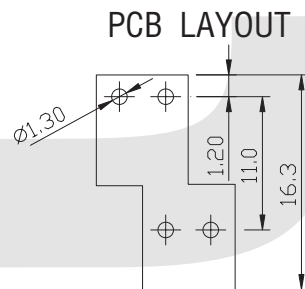
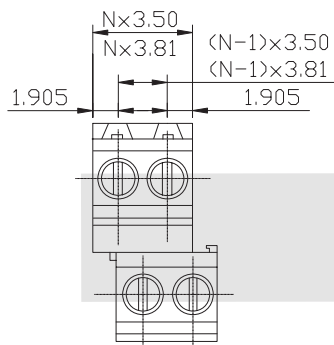
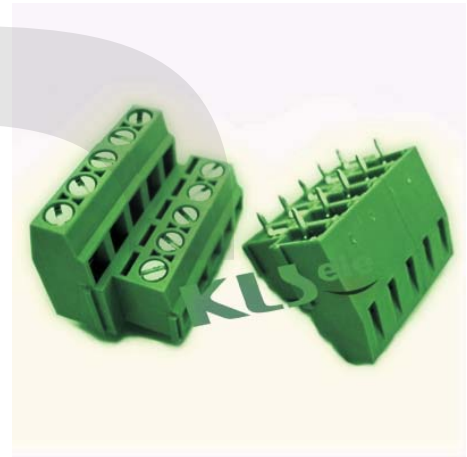

ORDER INFORMATION

Product NO.: KLS2-125A-3.81-XXP X X X

Pos. NO.

Series No.

Pitch: 3.50=3.50mm
3.81=3.81mm

Number of Pole

Customer Request

Screw: C=Cross Screw
S=Slot Screw

Color: 1=Gray 2=Blue 3=Black
4=Green 5=Orange 6=Red
7=Transparent 8=Yellow 9=White

All specification & dimensions are subject to change, please call your nearest KLS sales representative for update information

TERMINAL BLOCK Connector

KLSelectronic
www.cnkls.com

PCB Series

KLS2-125B-3.50/3.81 Series Pitch=3.50mm/3.81mm

Electrical :

Rated voltage: 150V
Rated current: 10A
Contact resistance: 20mΩ
Insulation resistance: 5000MΩ/1000V
Withstanding Voltage: AC2000V/1Min
Wire range: 26-16AWG 1.5mm²

Material

Screws: M2 steel Zinc plated
Contact: Brass, Ni plated
Pin header: Brass, Tin plated
Housing: PA66, UL94V-0

Mechanical

Temp. Range: -40°C~+105°C
MAX Soldering: +250°C for 5 Sec.
Torque: 0.2Nm (1.7 lb.in)
Strip length: 5-6mm

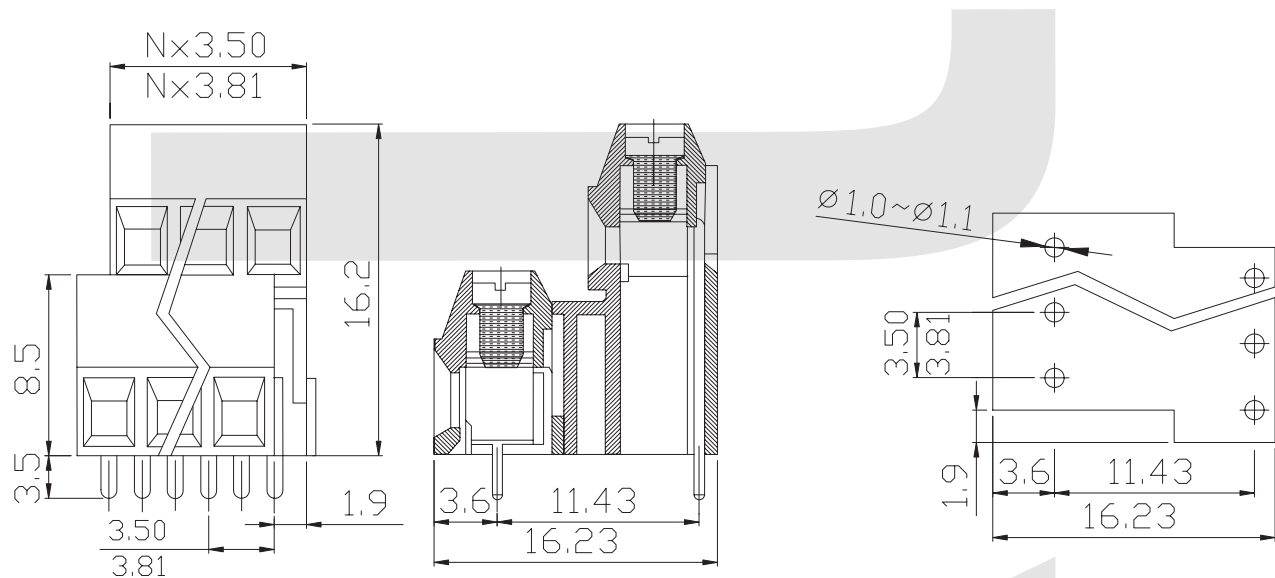

ORDER INFORMATION

Product NO.: KLS2-125B-3.81-XXP X X X

Pos. NO.	_____	Customer Request
Series No.	_____	Screw: C=Cross Screw S=Slot Screw
Pitch: 3.50=3.50mm 3.81=3.81mm	_____	Color: 1=Gray 2=Blue 3=Black 4=Green 5=Orange 6=Red 7=Transparent 8=Yellow 9=White
Number of Pole	_____	

All specification & dimensions are subject to change, please call your nearest KLS sales representative for update information

TERMINAL BLOCK Connector

KLSelectronic
www.cnkls.com

PCB Series

KLS2-308V-2.54 Series Pitch=2.54mm

Electrical :

Rated voltage: 300V
Rated current: 6A
Contact resistance: 20mΩ
Insulation resistance: 5000MΩ/1000V
Withstanding Voltage: AC2000V/1Min
Wire range: 26-18AWG 1.0mm²

Material

Screws: M1.5 steel Zinc plated
Contact: Brass, Electroless nickel
Pin header: Brass, Tin plated
Housing: PA66, UL94V-0

Mechanical

Temp. Range: -40°C~+105°C
MAX Soldering: +250°C for 5 Sec.
Torque: 0.15Nm (1.3 lb.in)
Strip length: 3.7-4.7mm

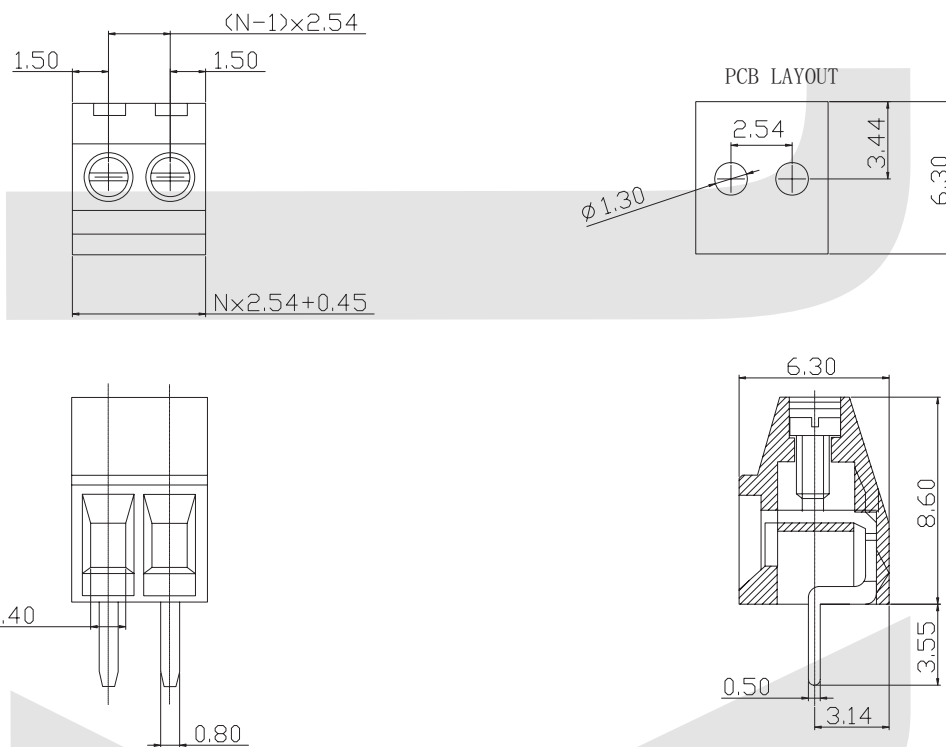

ORDER INFORMATION

Product No.: KLS2-308V-2.54-XXP-X X-X

Pos. No.	Customer Request
Series No.	Screw: C=Cross Screw S=Slot Screw
Pitch: 2.54=2.54mm	Color: 1=Gray 2=Blue 3=Black 4=Green 5=Orange 6=Red 7=Transparent 8=Yellow 9=White
Number of Pole	

All specification & dimensions are subject to change, please call your nearest KLS sales representative for update information

TERMINAL BLOCK Connector

KLSelectronic
www.cnkls.com

PCB Series

KLS2-300-5.00 Series Pitch=5.00mm/10.00mm

Electrical :

Rated Voltage: 300V
Rated Current: 16A
Contact Resistance: 20mΩ
Insulation Resistance: 5000MΩ/1000V
Withstanding Voltage: AC1500V/1Min
Wire Range: 22-14AWG 2.5mm²

Material

Screws: M3 steel Zinc plated
Wire guard: phosphor bronze Ni plated or stainless steel
Pin header: Brass, Tin plated
Housing: PBT,UL94V-0

Mechanical

Temp. Range: -30°C~+120°C
MAX Soldering: ++250°C for 5 Sec.
Torque: 0.5Nm (4.5lb.in)
Strip length: 4.5-5mm

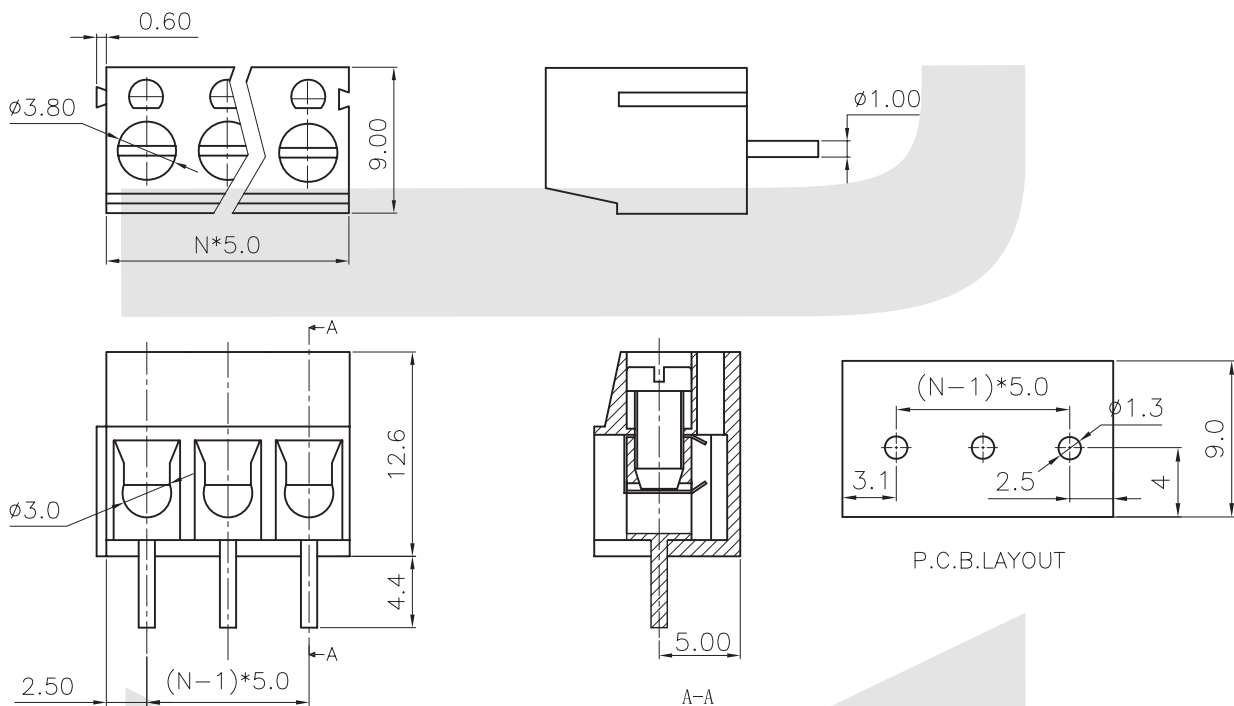

ORDER INFORMATION

Product NO.: KLS2-300-5.00-XXP X X X

Pos. NO.

Series No.

Pitch: 5.00=5.00mm
10.00=10.00mm

Number of Pole

Customer Request

Screw: C=Cross Screw
S=Slot Screw

Color: 1=Gray 2=Blue 3=Black
4=Green 5=Orange 6=Red
7=Transparent 8=Yellow 9=White

All specification & dimensions are subject to change, please call your nearest KLS sales representative for update information

TERMINAL BLOCK Connector

KLSelectronic
www.cnkls.com

PCB Series

KLS2-300R-5.00 Series Pitch=5.00mm/10.00mm

Electrical :

Rated voltage: 300V
Rated current: 16A
Contact resistance: 20mΩ
Insulation resistance: 5000MΩ/1000V
Withstanding Voltage: AC1500V/1Min
Wire range: 22-14AWG 2.5mm²

Material

Screws: M3 steel Zinc plated
Wire guard: phosphor bronze Ni plated or stainless steel
Pin header: Brass, Tin plated
Housing: PBT,UL94V-0

Mechanical

Temp. Range: -30°C~+120°C
MAX Soldering: ++250°C for 5 Sec.
Torque: 0.5Nm (4.5lb.in)
Strip length: 4.5-5mm

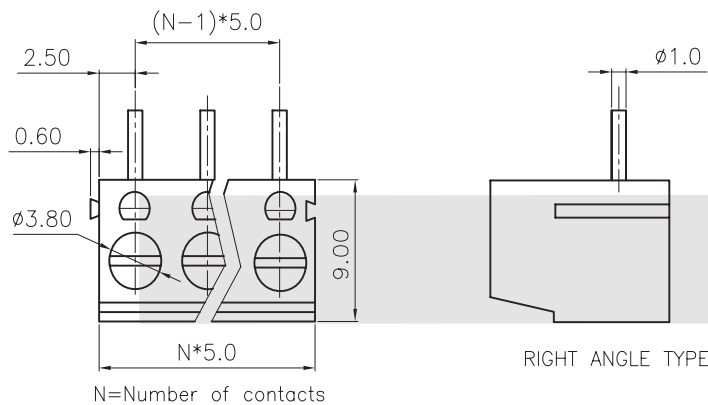

RIGHT ANGLE TYPE

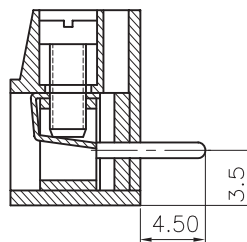
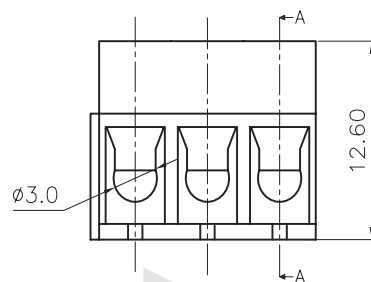
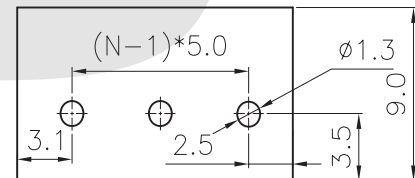

SECTION A A

RECOMMEND PCB LAYOUT
(TOLERANCE=±0.05)

ORDER INFORMATION

Product NO.: KLS2-300R-5.00-XXP X X X

Pos. NO.

Series No.

Pitch: 5.00=5.00mm
10.00=10.00mm

Number of Pole

Customer Request

Screw: C=Cross Screw
S=Slot Screw

Color: 1=Gray 2=Blue 3=Black
4=Green 5=Orange 6=Red
7=Transparent 8=Yellow 9=White

All specification & dimensions are subject to change, please call your nearest KLS sales representative for update information

TERMINAL BLOCK Connector

KLSelectronic
www.cnkls.com

PCB Series

KLS2-301-5.00 Series Pitch=5.00mm/10.00mm

Electrical :

Rated voltage: 300V
Rated current: 16A
Contact resistance: 20mΩ
Insulation resistance: 5000MΩ/1000V
Withstanding Voltage: AC1500V/1Min
Wire range: 22-14AWG 2.5mm²

Material

Screws: M3 steel Zinc plated
Wire guard: phosphor bronze Ni plated or stainless steel
Pin header: Brass, Tin plated
Housing: PBT,UL94V-0

Mechanical

Temp. Range: -30°C~+120°C
MAX Soldering: +250°C for 5 Sec.
Torque: 0.5Nm (4.5lb.in)
Strip length: 4.5-5mm

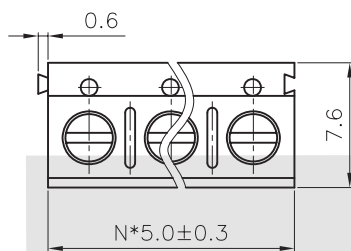

N=Number of contacts

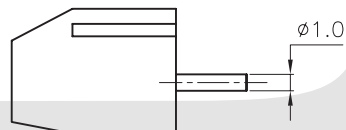

STRAIGHT TYPE

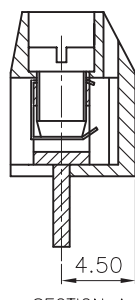
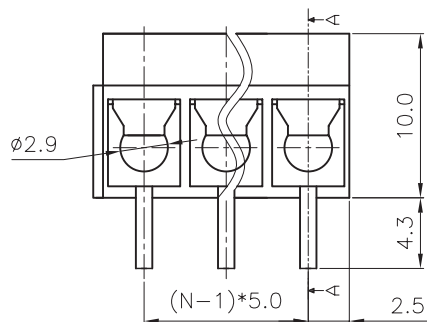

SECTION A-A

P.C.B.LAYOUT

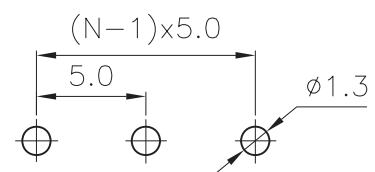

ORDER INFORMATION

Product NO.: KLS2-301-5.00-XXP X X X

Pos. NO.

Series No.

Pitch: 5.00=5.00mm
10.00=10.00mm

Number of Pole

Customer Request

Screw: C=Cross Screw
S=Slot Screw

Color: 1=Gray 2=Blue 3=Black
4=Green 5=Orange 6=Red
7=Transparent 8=Yellow 9=White

All specification & dimensions are subject to change, please call your nearest KLS sales representative for update information

TERMINAL BLOCK Connector

KLSelectronic
www.cnkls.com

PCB Series

KLS2-301R-5.00 Series Pitch=5.00mm

Electrical :

Rated voltage: 300V
Rated current: 16A
Contact resistance: 20mΩ
Insulation resistance: 5000MΩ/1000V
Withstanding Voltage: AC1500V/1Min
Wire range: 22-14AWG 2.5mm²

Material

Screws: M3 steel Zinc plated
Wire guard: phosphor bronze Ni plated or stainless steel
Pin header: Brass, Tin plated
Housing: PBT,UL94V-0

Mechanical

Temp. Range: -30°C~+120°C
MAX Soldering: +250°C for 5 Sec.
Torque: 0.5Nm (4.5lb.in)
Strip length: 4.5-5mm

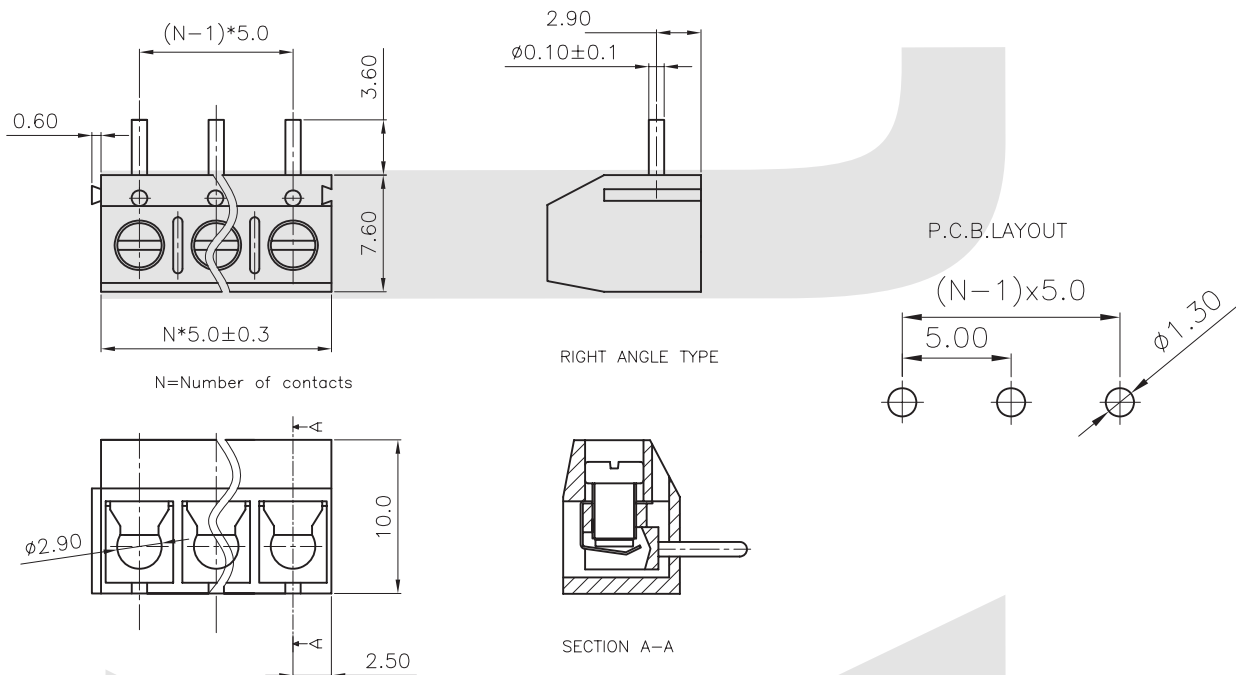
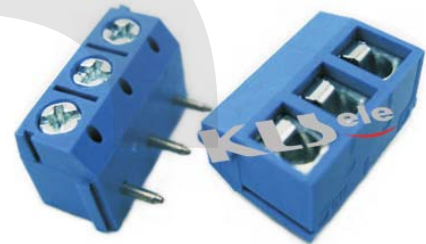

ORDER INFORMATION

Product NO.: KLS2-301R-5.00-XXP X X X

Pos. NO.

Series No.

Pitch: 5.00=5.00mm
10.00=10.00mm

Number of Pole

Customer Request

Screw: C=Cross Screw
S=Slot Screw

Color: 1=Gray 2=Blue 3=Black
4=Green 5=Orange 6=Red
7=Transparent 8=Yellow 9=White

All specification & dimensions are subject to change, please call your nearest KLS sales representative for update information

TERMINAL BLOCK Connector

KLSelectronic
www.cnkls.com

PCB Series

KLS2-305V-5.00 Series Pitch=5.00mm/10.00mm

Electrical :

Rated voltage: 300V
Rated current: 10A
Contact resistance: 20mΩ
Insulation resistance: 5000MΩ/1000V
Withstanding Voltage: AC1500V/1Min
Wire range: 22-14AWG 2.5mm²

Material

Screws: M2.5 steel Zinc plated
Wire guard: phosphor bronze Ni plated or stainless steel
Pin header: Brass, Tin plated
Housing: PBT,UL94V-0

Mechanical

Temp. Range: -30°C~+120°C
MAX Soldering: +250°C for 5 Sec.
Torque: 0.4Nm (3.6lb.in)
Strip length: 4.5-5mm

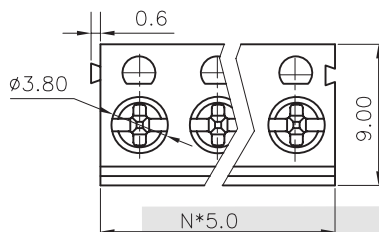

N=Number of contacts

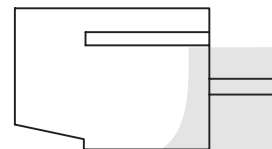

STRAIGHT TYPE

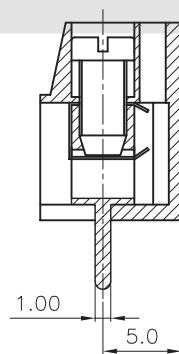
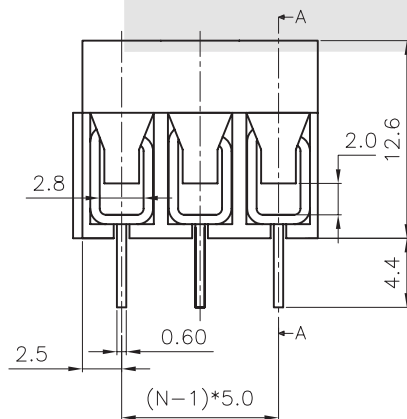

SECTION A-A

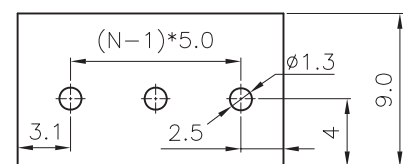

P.C.B. LAYOUT

ORDER INFORMATION

Product NO.: KLS2-305V-5.00-XXP X X X

Pos. NO.

Series No.

Pitch: 5.00=5.00mm
10.00=10.00mm

Number of Pole

Customer Request

Screw: C=Cross Screw
S=Slot Screw

Color: 1=Gray 2=Blue 3=Black
4=Green 5=Orange 6=Red
7=Transparent 8=Yellow 9=White

All specification & dimensions are subject to change, please call your nearest KLS sales representative for update information

TERMINAL BLOCK Connector

KLS electronic
www.cnkls.com

PCB Series

KLS2-306V-5.00 Series Pitch=5.00mm/10.00mm

Electrical :

Rated voltage: 300V
Rated current: 10A
Contact resistance: 20mΩ
Insulation resistance: 5000MΩ/1000V
Withstanding Voltage: AC2000V/1Min
Wire range: 22-14AWG 1.5mm²

Material

Screws: M2.5 steel Zinc plated
Wire guard: Stainless steel I
Pin header: Brass, Tin plated
Housing: PBT, UL94V-0

Mechanical

Temp. Range: -30°C~+120°C
MAX Soldering: +250°C for 5 Sec.
Torque: 0.4Nm (3.6 lb.in)
Strip length: 4.5-5mm

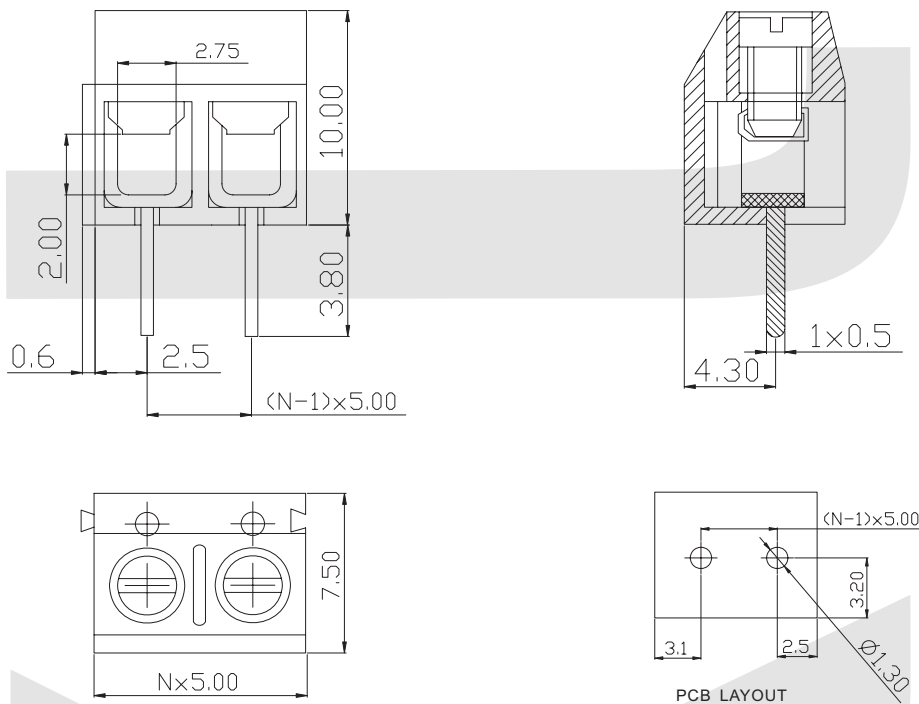

ORDER INFORMATION

Product NO.: KLS2-306V-5.00-XXP X X X

Pos. NO. _____
Series No. _____
Pitch: 5.00=5.00mm
10.00=10.00mm
Number of Pole _____

Customer Request

Screw: C=Cross Screw
S=Slot Screw

Color: 1=Gray 2=Blue 3=Black
4=Green 5=Orange 6=Red
7=Transparent 8=Yellow 9=White

All specification & dimensions are subject to change, please call your nearest KLS sales representative for update information

TERMINAL BLOCK Connector

KLS electronic
www.cnkls.com

PCB Series

KLS2-126-5.00 Series Pitch=5.00mm/10.00mm

Electrical :

Rated voltage: 300V
Rated current: 10A
Contact resistance: 20mΩ
Insulation resistance: 5000MΩ/1000V
Withstanding Voltage: AC1500V/1Min
Wire range: 24-18AWG 2.5mm²

Material

Screws: M2.5 steel Zinc plated
Wire guard: phosphor bronze Ni plated or stainless steel
Pin header: Brass, Tin plated
Housing: PA66, UL94V-0

Mechanical

Temp. Range: -40°C~+105°C
MAX Soldering: +250°C for 5 Sec.
Torque: 0.4Nm (3.6lb.in)
Strip length: 6-7mm

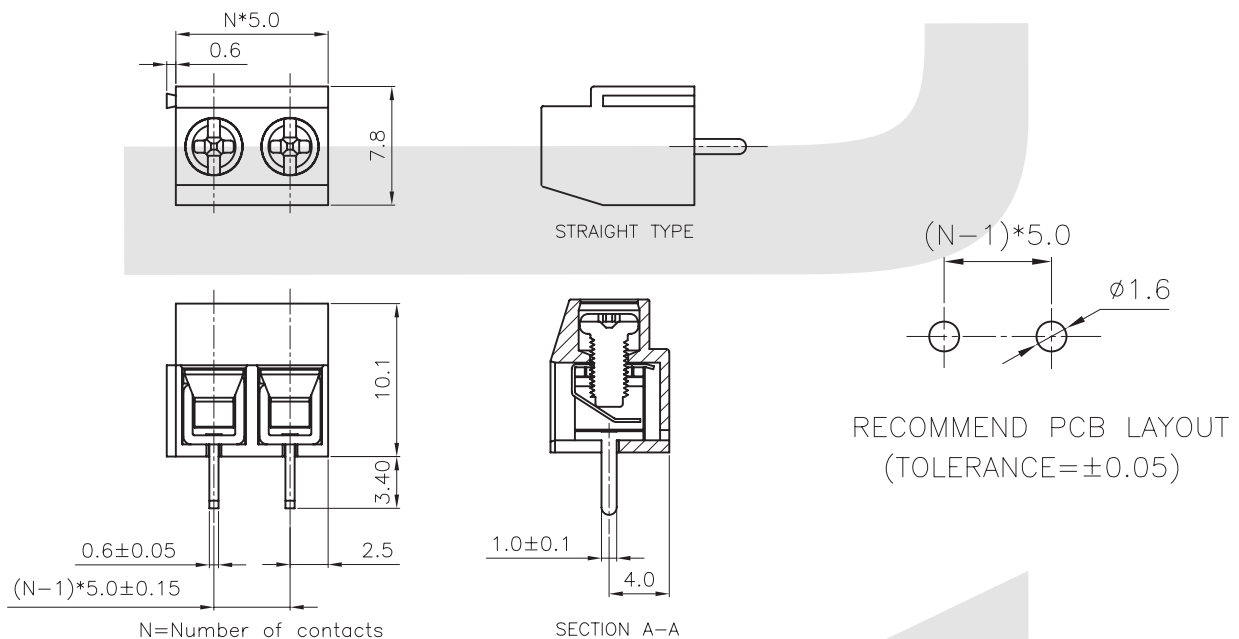

ORDER INFORMATION

Product NO.: KLS2-126-5.00-XXP X X X

Pos. NO.	Customer Request
Series No.	Screw: C=Cross Screw S=Slot Screw
Pitch: 5.00=5.00mm 10.00=10.00mm	Color: 1=Gray 2=Blue 3=Black 4=Green 5=Orange 6=Red 7=Transparent 8=Yellow 9=White
Number of Pole	

All specification & dimensions are subject to change, please call your nearest KLS sales representative for update information

TERMINAL BLOCK Connector

KLS electronic
www.cnkls.com

PCB Series

KLS2-126R-5.00 Series Pitch=5.00mm/10.00mm

Electrical :

Rated voltage: 300V
Rated current: 10A
Contact resistance: 20mΩ
Insulation resistance: 5000MΩ/1000V
Withstanding Voltage: AC1500V/1Min
Wire range: 22-14AWG 2.5mm²

Material

Screws: M2.5 steel Zinc plated
Wire guard: phosphor bronze Ni plated or stainless steel
Pin header: Brass, Tin plated
Housing: PA66, UL94V-0

Mechanical

Temp. Range: -40°C~+105°C
MAX Soldering: +250°C for 5 Sec.
Torque: 0.4Nm (3.6lb.in)
Strip length: 6-7mm

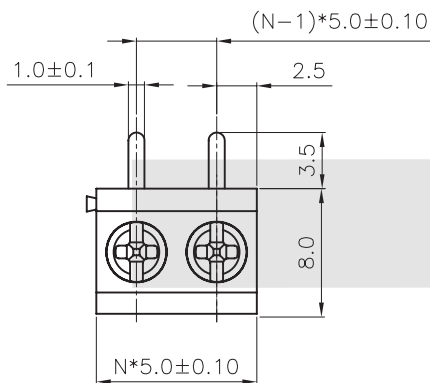

N=Number of contacts

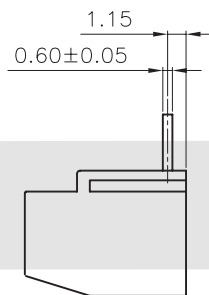

STRAIGHT TYPE

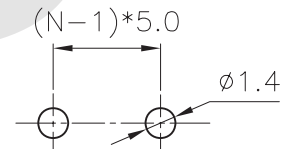

RECOMMEND PCB LAYOUT
(TOLERANCE=±0.05)

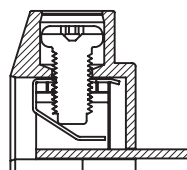
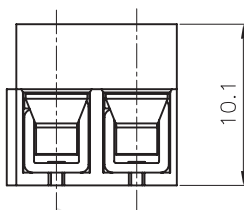

SECTION A-A

ORDER INFORMATION

Product NO.: KLS2-126R-5.00-XXP X X X

Pos. NO.

Series No.

Pitch: 5.00=5.00mm
10.00=10.00mm

Number of Pole

Customer Request

Screw: C=Cross Screw
S=Slot Screw

Color: 1=Gray 2=Blue 3=Black
4=Green 5=Orange 6=Red
7=Transparent 8=Yellow 9=White

All specification & dimensions are subject to change, please call your nearest KLS sales representative for update information

TERMINAL BLOCK Connector

KLSelectronic
www.cnkls.com

PCB Series

KLS2-127-5.00/5.08 Series Pitch=5.00mm/5.08mm

Electrical :

Rated voltage: 300V
Rated current: 12A
Contact resistance: 20mΩ
Insulation resistance: 5000MΩ/1000V
Withstanding Voltage: AC1500V/1Min
Wire range: 26-16AWG 1.5mm²

Material

Screws: M2.5 steel Zinc plated
Contact: Brass
Pin header: Brass, Tin plated
Housing: PA66, UL94V-0

Mechanical

Temp. Range: -40°C~+105°C
MAX Soldering: +250°C for 5 Sec.
Torque: 0.5Nm (4.5lb.in)
Strip length: 5-6mm

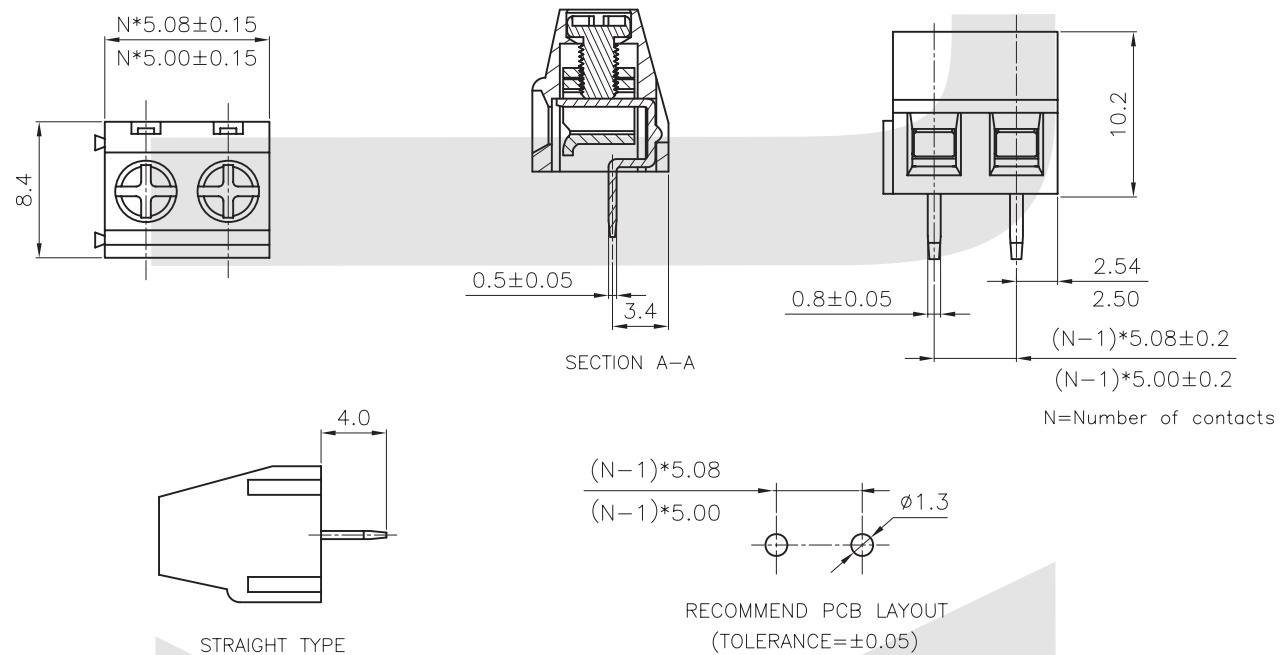

ORDER INFORMATION

Product NO.: KLS2-127-5.00-XXP X X X

Pos. NO.

Series No.

Pitch: 5.00=5.00mm
5.08=5.08mm

Number of Pole

Customer Request

Screw: C=Cross Screw
S=Slot Screw

Color: 1=Gray 2=Blue 3=Black
4=Green 5=Orange 6=Red
7=Transparent 8=Yellow 9=White

All specification & dimensions are subject to change, please call your nearest KLS sales representative for update information

TERMINAL BLOCK Connector

KLS electronic
www.cnkls.com

PCB Series

KLS2-128-5.00/7.50 Series Pitch=5.00mm/7.50mm

Electrical :

Rated voltage: 300V
Rated current: 16A
Contact resistance: 20mΩ
Insulation resistance: 5000MΩ/1000V
Withstanding Voltage: AC1500V/1Min
Wire range: 24-12AWG 2.5mm²

Material

Screws: M2.5 steel Zinc plated
Contact: Brass
Pin header: Brass, Tin plated
Housing: PA66, UL94V-0

Mechanical

Temp. Range: -40°C~+105°C
MAX Soldering: +250°C for 5 Sec.
Torque: 0.4Nm (3.6lb.in)
Strip length: 6-7mm

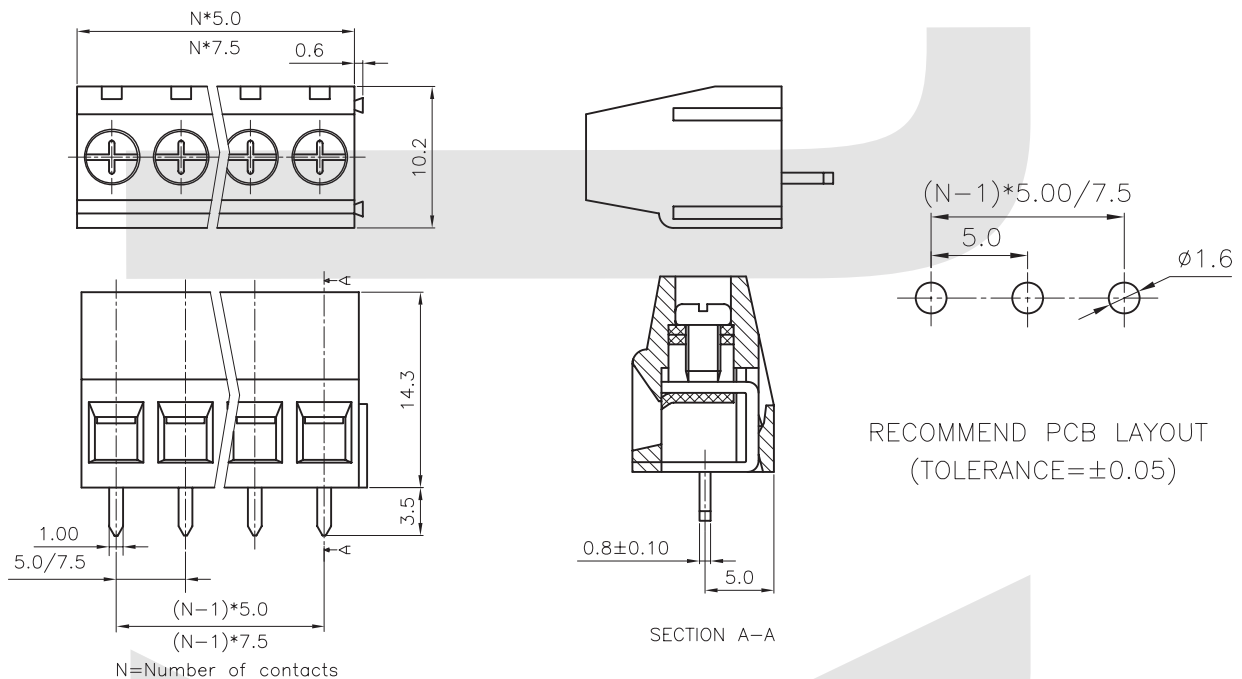
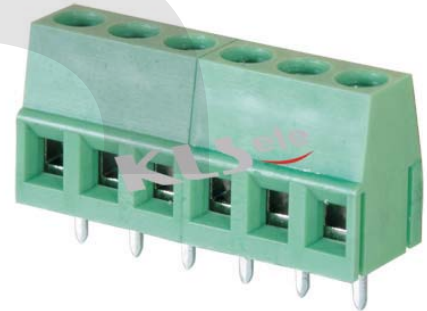

ORDER INFORMATION

Product NO.: KLS2-128-5.00-XXP X X X

Pos. NO.

Series No.

Pitch: 5.00=5.00mm
7.50=7.50mm

Number of Pole

Customer Request

Screw: C=Cross Screw
S=Slot Screw

Color: 1=Gray 2=Blue 3=Black
4=Green 5=Orange 6=Red
7=Transparent 8=Yellow 9=White

All specification & dimensions are subject to change, please call your nearest KLS sales representative for update information

TERMINAL BLOCK Connector

KLSelectronic
www.cnkls.com

PCB Series

KLS2-128R-5.00/7.50 Series Pitch=5.00mm/7.50mm

Electrical :

Rated voltage: 300V
Rated current: 16A
Contact resistance: 20mΩ
Insulation resistance: 5000MΩ/1000V
Withstanding Voltage: AC1500V/1Min
Wire range: 24-12AWG 2.5mm²

Material

Screws: M2.5 steel Zinc plated
Contact: Brass
Pin header: Brass, Tin plated
Housing: PA66, UL94V-0

Mechanical

Temp. Range: -40°C~+105°C
MAX Soldering: +250°C for 5 Sec.
Torque: 0.4Nm (3.6lb.in)
Strip length: 6-7mm

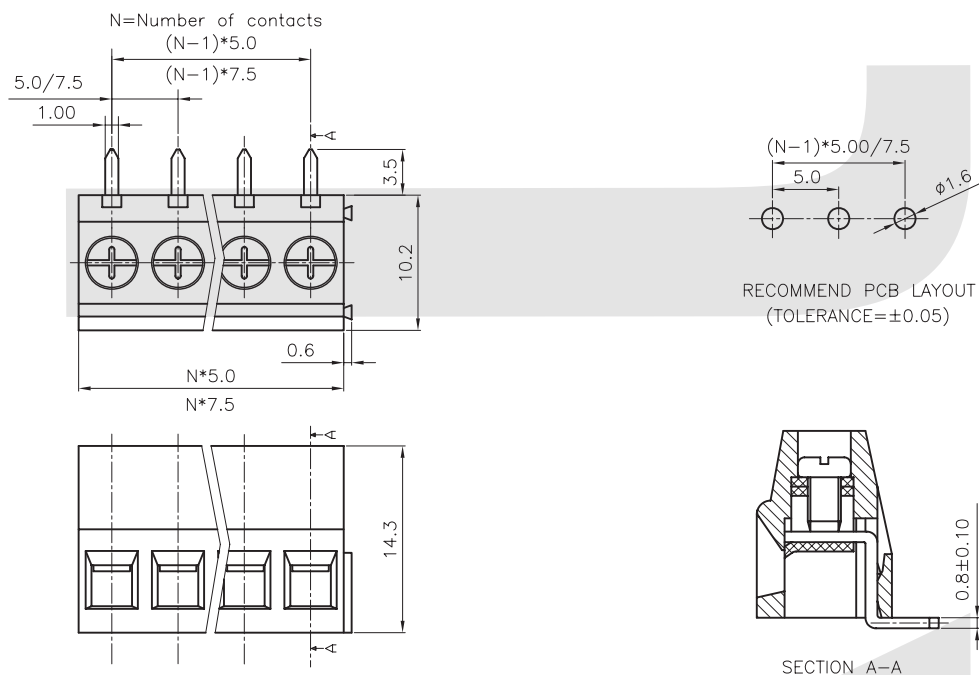

ORDER INFORMATION

Product NO.: KLS2-128R-5.00-XXP X X X

Pos. NO.

Series No.

Pitch: 5.00=5.00mm
7.50=7.50mm

Number of Pole

Customer Request

Screw: C=Cross Screw
S=Slot Screw

Color: 1=Gray 2=Blue 3=Black
4=Green 5=Orange 6=Red
7=Transparent 8=Yellow 9=White

All specification & dimensions are subject to change, please call your nearest KLS sales representative for update information

TERMINAL BLOCK Connector

KLS electronic
www.cnkls.com

PCB Series

KLS2-128I-5.00/5.08 Series Pitch=5.00mm/5.08mm

Electrical :

Rated voltage: 300V
Rated current: 16A
Contact resistance: 20mΩ
Insulation resistance: 5000MΩ/1000V
Withstanding Voltage: AC1500V/1Min
Wire range: 24-12AWG 2.5mm²

Material

Screws: M2.5 steel Zinc plated
Contact: Brass
Pin header: Brass, Tin plated
Housing: PA66, UL94V-0

Mechanical

Temp. Range: -40°C~+105°C
MAX Soldering: +250°C for 5 Sec.
Torque: 0.4Nm (3.6lb.in)
Strip length: 6-7mm

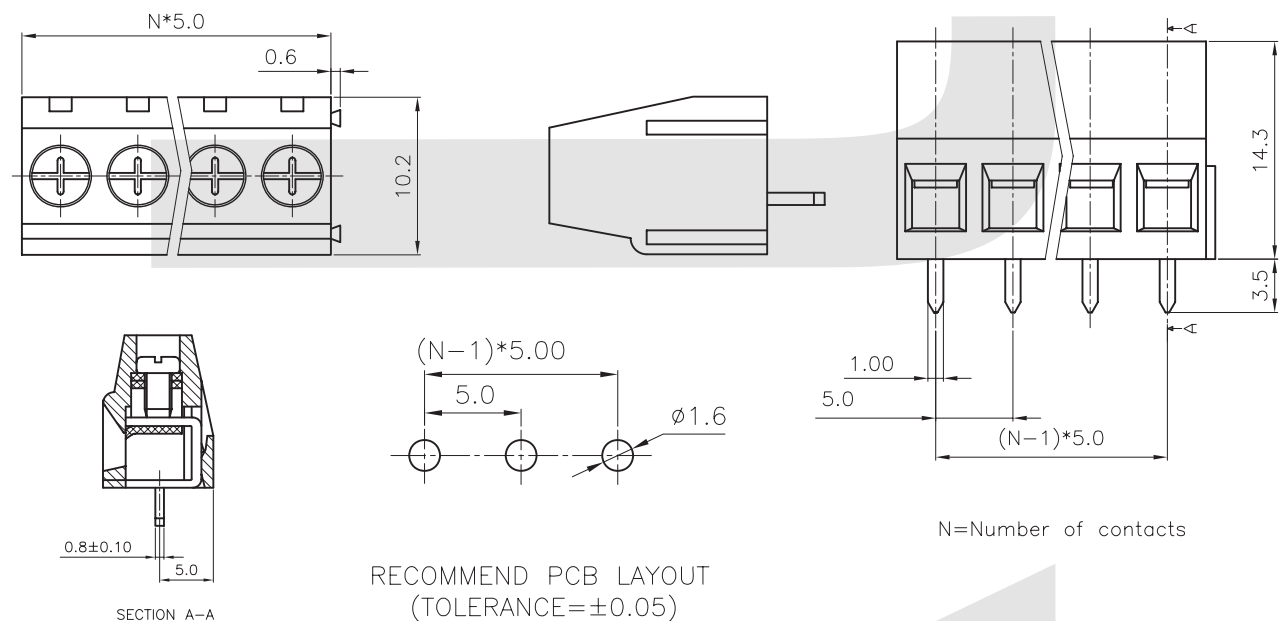

ORDER INFORMATION

Product NO.: KLS2-128I-5.00-XXP X X X

Pos. NO.

Series No.

Pitch: 5.00=5.00mm 10.00=10.00mm
5.08=5.08mm 10.16=10.16mm

Number of Pole

Customer Request

Screw: C=Cross Screw
S=Slot Screw

Color: 1=Gray 2=Blue 3=Black
4=Green 5=Orange 6=Red
7=Transparent 8=Yellow 9=White

All specification & dimensions are subject to change, please call your nearest KLS sales representative for update information

TERMINAL BLOCK Connector

KLSelectronic
www.cnkls.com

PCB Series

KLS2-128IH-5.00/5.08 Series Pitch=5.00mm/5.08mm

Electrical :

Rated voltage: 300V
Rated current: 10A
Contact resistance: 20mΩ
Insulation resistance: 5000MΩ/1000V
Withstanding Voltage: AC2000V/1Min
Wire range: 24-12AWG 2.5mm²

Material

Screws: M2.5 steel Zinc plated
Contact: Brass, Ni plated
Pin header: Brass, Tin plated
Housing: PA66, UL94V-0

Mechanical

Temp. Range: -40°C~+105°C
MAX Soldering: +250°C for 5 Sec.
Torque: 0.4Nm (3.6 lb.in)
Strip length: 6-7mm

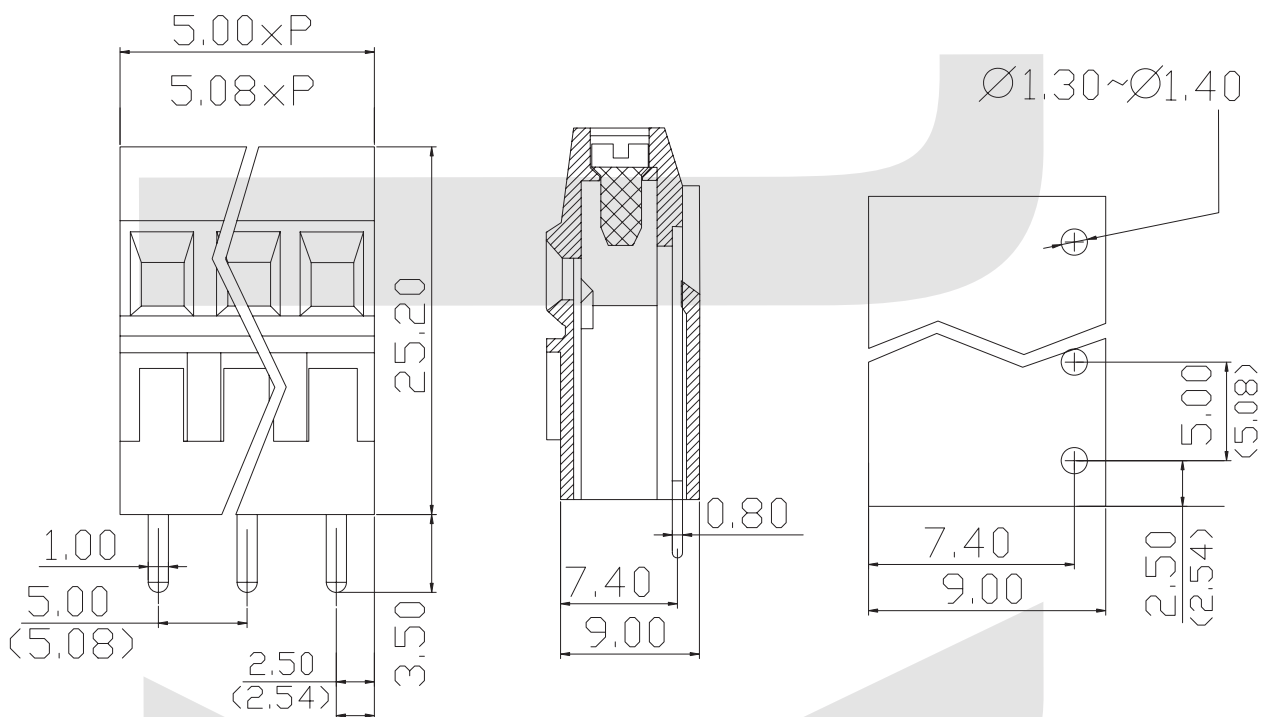

ORDER INFORMATION

Product NO.: KLS2-128IH-5.00-XXP X X X

Pos. NO.

Series No.

Pitch: 5.00=5.00mm 5.08=5.08mm
10.00=10.00mm 10.16=10.16mm

Number of Pole

Customer Request

Screw: C=Cross Screw
S=Slot Screw

Color: 1=Gray 2=Blue 3=Black
4=Green 5=Orange 6=Red
7=Transparent 8=Yellow 9=White

All specification & dimensions are subject to change, please call your nearest KLS sales representative for update information

TERMINAL BLOCK Connector

KLSelectronic
www.cnkls.com

PCB Series

KLS2-128IA-5.00/5.08 Series Pitch=5.00mm/5.08mm

Electrical :

Rated voltage: 300V
Rated current: 10A
Contact resistance: 20mΩ
Insulation resistance: 5000MΩ/1000V
Withstanding Voltage: AC2000V/1Min
Wire range: 24-12AWG 2.5mm²

Material

Screws: M2.5 steel Zinc plated
Contact: Brass, Ni plated
Pin header: Brass, Tin plated
Housing: PA66, UL94V-0

Mechanical

Temp. Range: -40°C~+105°C
MAX Soldering: +250°C for 5 Sec.
Torque: 0.4Nm (3.6 lb.in)
Strip length: 6-7mm

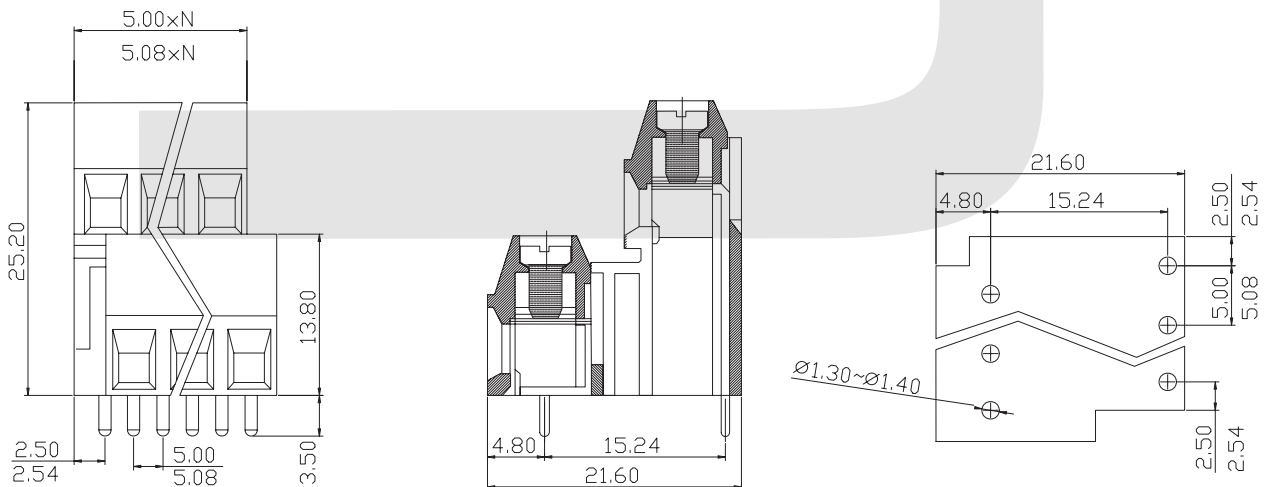

ORDER INFORMATION

Product NO.: KLS2-128IA-5.00-XXP X X X

Pos. NO.

Series No.

Pitch: 5.00=5.00mm 5.08=5.08mm
10.00=10.00mm 10.16=10.16mm

Number of Pole

Customer Request

Screw: C=Cross Screw
S=Slot Screw

Color: 1=Gray 2=Blue 3=Black
4=Green 5=Orange 6=Red
7=Transparent 8=Yellow 9=White

All specification & dimensions are subject to change, please call your nearest KLS sales representative for update information

TERMINAL BLOCK Connector

KLSelectronic
www.cnkls.com

PCB Series

KLS2-128IB-5.00/5.08 Series Pitch=5.00mm/5.08mm

Electrical :

Rated voltage: 300V
Rated current: 10A
Contact resistance: 20mΩ
Insulation resistance: 5000MΩ/1000V
Withstanding Voltage: AC2000V/1Min
Wire range: 24-12AWG 2.5mm²

Material

Screws: M2.5 steel Zinc plated
Contact: Brass, Ni plated
Pin header: Brass, Tin plated
Housing: PA66, UL94V-0

Mechanical

Temp. Range: -40°C~+105°C
MAX Soldering: +250°C for 5 Sec.
Torque: 0.4Nm (3.6 lb.in)
Strip length: 6-7mm

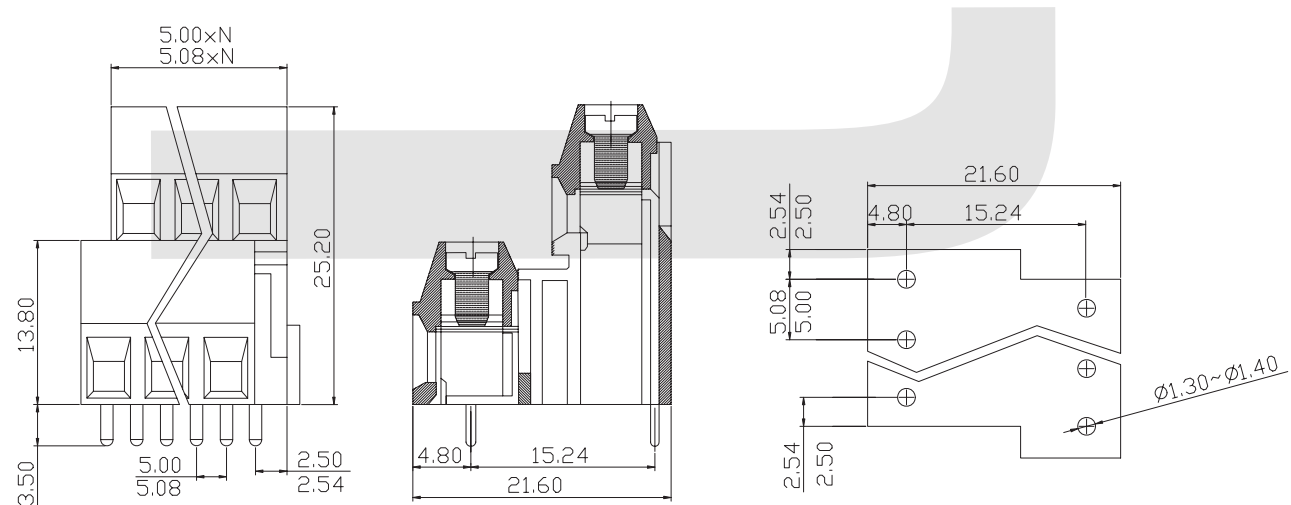

ORDER INFORMATION

Product NO.: KLS2-128IB-5.00-XXP X X X

Pos. NO.

Series No.

Pitch: 5.00=5.00mm 5.08=5.08mm
10.00=10.00mm 10.16=10.16mm

Number of Pole

Customer Request

Screw: C=Cross Screw
S=Slot Screw

Color: 1=Gray 2=Blue 3=Black
4=Green 5=Orange 6=Red
7=Transparent 8=Yellow 9=White

All specification & dimensions are subject to change, please call your nearest KLS sales representative for update information

TERMINAL BLOCK Connector

KLSelectronic
www.cnkls.com

PCB Series

KLS2-129-5.00/5.08 Series Pitch=5.00mm/5.08mm

Electrical :

Rated voltage: 300V
Rated current: 10A
Contact resistance: 20mΩ
Insulation resistance: 5000MΩ/1000V
Withstanding Voltage: AC1500V/1Min
Wire range: 24-12AWG 2.5mm²

Material

Screws: M2.5 steel Zinc plated
Contact: Brass
Pin header: Brass, Tin plated
Housing: PA66, UL94V-0

Mechanical

Temp. Range: -40°C~+105°C
MAX Soldering: +250°C for 5 Sec.
Torque: 0.4Nm (3.6lb.in)
Strip length: 6-7mm

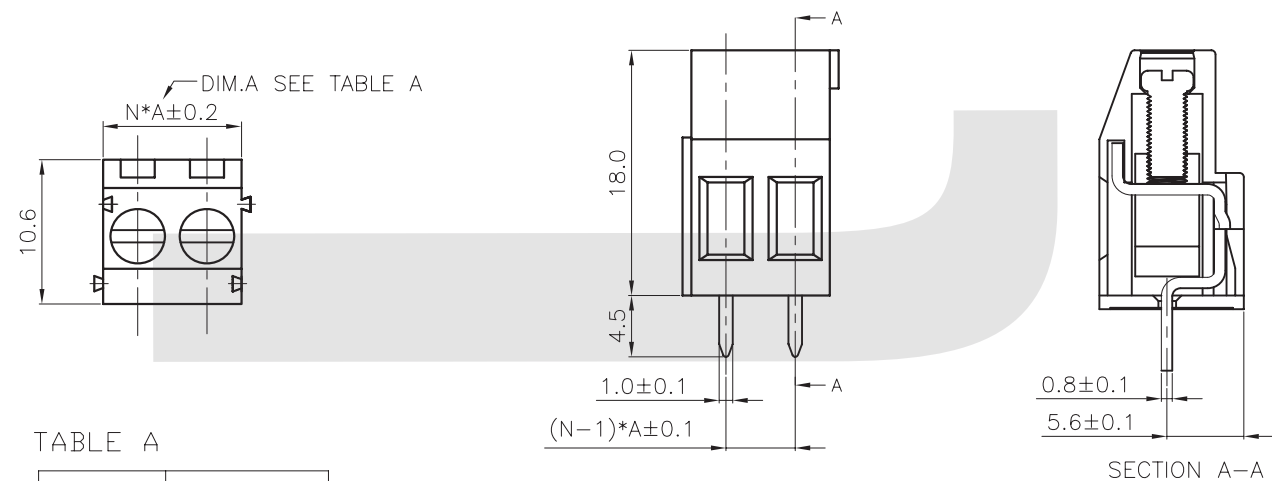
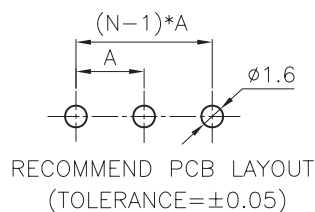

TABLE A

TYPE	Dimension
	A
1	5.00
2	5.08
3	7.62



ORDER INFORMATION

Product NO.: KLS2-129-5.08-XXP X X X

Pos. NO.	Customer Request
Series No.	Screw: C=Cross Screw S=Slot Screw
Pitch: 5.00=5.00mm 5.08=5.08mm 7.62=7.62mm 10.00=10.00mm 10.16=10.16mm	Color: 1=Gray 2=Blue 3=Black 4=Green 5=Orange 6=Red 7=Transparent 8=Yellow 9=White
Number of Pole	

All specification & dimensions are subject to change, please call your nearest KLS sales representative for update information

TERMINAL BLOCK Connector

KLSelectronic
www.cnkls.com

PCB Series

KLS2-129R-5.00/5.08 Series Pitch=5.00mm/5.08mm

Electrical :

Rated voltage: 300V
Rated current: 10A
Contact resistance: 20mΩ
Insulation resistance: 5000MΩ/1000V
Withstanding Voltage: AC1500V/1Min
Wire range: 24-12AWG 2.5mm²

Material

Screws: M2.5 steel Zinc plated
Contact: Brass
Pin header: Brass, Tin plated
Housing: PA66, UL94V-0

Mechanical

Temp. Range: -40°C~+105°C
MAX Soldering: +250°C for 5 Sec.
Torque: 0.4Nm (3.6lb.in)
Strip length: 6-7mm



II

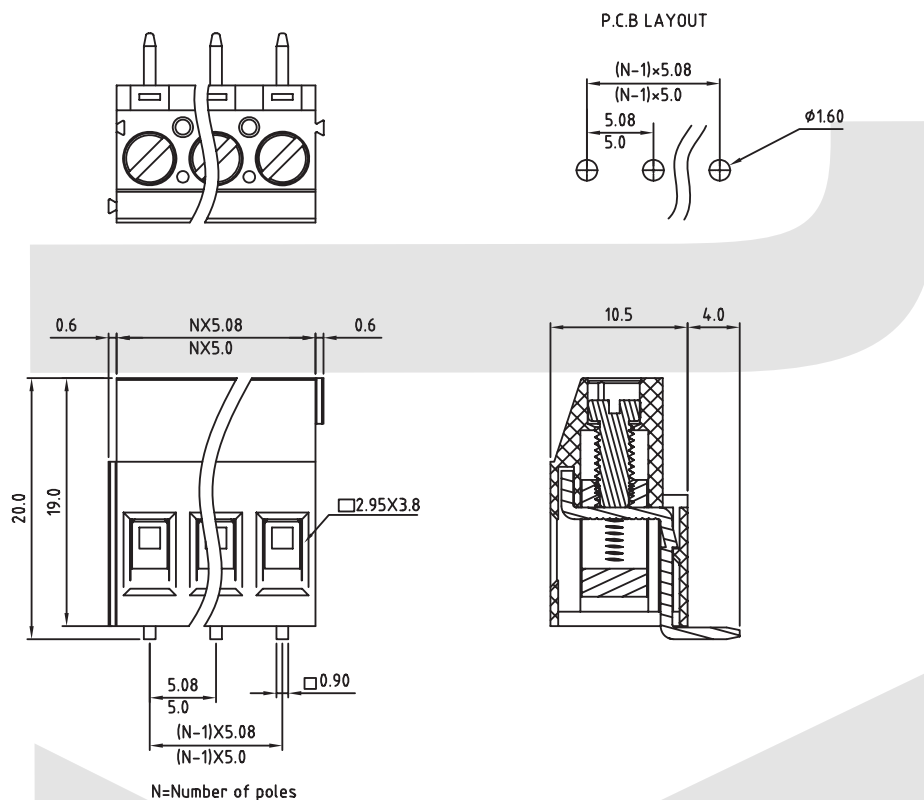

ORDER INFORMATION

Product NO.: KLS2-129R-5.08-XXP X X X

Pos. NO. _____	Customer Request
Series No. _____	Screw: C=Cross Screw S=Slot Screw
Pitch: 5.00=5.00mm 5.08=5.08mm	Color: 1=Gray 2=Blue 3=Black
7.62=7.62mm 10.00=10.00mm 10.16=10.16mm	4=Green 5=Orange 6=Red
Number of Pole _____	7=Transparent 8=Yellow 9=White

All specification & dimensions are subject to change, please call your nearest KLS sales representative for update information

TERMINAL BLOCK Connector

KLS electronic
www.cnkls.com

PCB Series

KLS2-333K-3.50 Series Pitch=3.50mm

Electrical :

Rated voltage: 300V
Rated current: 10A
Contact resistance: 20mΩ
Insulation resistance: 5000MΩ/1000V
Withstanding Voltage: AC2000V/1Min
Wire range: 28-18AWG 1.0mm²

Material

Screws: M2 steel Zinc plated
Reed: Phosphor Bronze, Electroless nickel
Pin header: Brass, Tin plated
Housing: PBT, UL94V-0

Mechanical

Temp. Range: -40°C~+105°C
MAX Soldering: +250°C for 5 Sec.
Torque: 0.2Nm (1.7 lb.in)
Strip length: 4.5-5mm

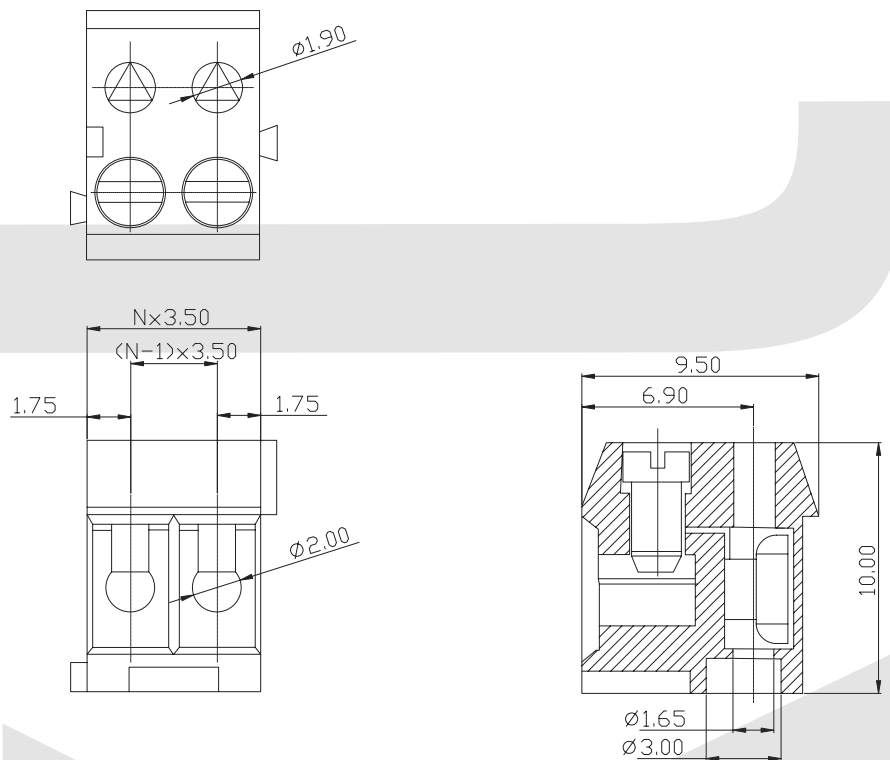

ORDER INFORMATION

Product NO.: KLS2-333K-3.50-XXP X X X

Pos. NO. _____	_____	_____	_____	_____	_____	Customer Request
Series No. _____	_____	_____	_____	_____	_____	Screw: C=Cross Screw S=Slot Screw
Pitch: 3.50=3.50mm _____	_____	_____	_____	_____	_____	Color: 1=Gray 2=Blue 3=Black 4=Green 5=Orange 6=Red 7=Transparent 8=Yellow 9=White
Number of Pole _____	_____	_____	_____	_____	_____	

All specification & dimensions are subject to change, please call your nearest KLS sales representative for update information

TERMINAL BLOCK Connector

KLSelectronic
www.cnkls.com

PCB Series

KLS2-333J-3.50 Series Pitch=3.50mm

Electrical :

Rated voltage: 300V
Rated current: 10A
Contact resistance: 20mΩ
Insulation resistance: 5000MΩ/1000V
Withstanding Voltage: AC2000V/1Min

Material

Pin header: Brass, Tin plated
Housing: PBT, UL94V-0

Mechanical

Temp. Range: -40°C~+105°C

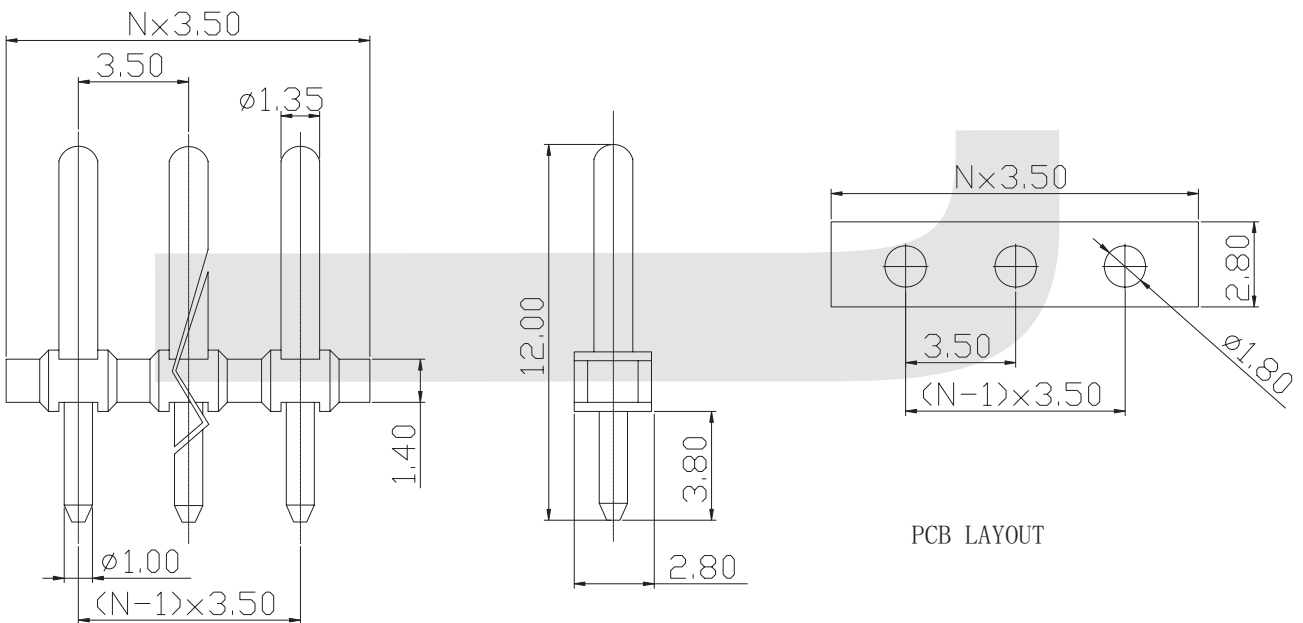

ORDER INFORMATION

Product NO.: KLS2-333J-3.50-XXP X X

Pos. NO.

Series No.

Pitch: 3.50=3.50mm

Number of Pole

Customer Request

Color: 1=Gray
4=Green
7=Transparent

2=Blue
5=Orange
8=Yellow

3=Black
6=Red
9=White

All specification & dimensions are subject to change, please call your nearest KLS sales representative for update information

KLSelectronic
www.cnkls.com

KLS2-135-6.35 Series Pitch=6.35mm

Rated voltage: 300V
Rated current: 30A
Contact resistance: 20mΩ
Insulation resistance: 5000MΩ/1000V
Withstanding Voltage: AC2000V/1Min
Wire range: 26-10AWG 4mm²

Screws: M3 steel Zinc plated
Contact: Brass, Ni plated
Pin header: Brass, Tin plated
Housing: PA66, UL94V-0

Temp. Range: -40°C ~ +105°C
MAX Soldering: +250°C for 5 Sec.
Torque: 0.5Nm (4.5 lb.in)
Strip length: 6-7mm

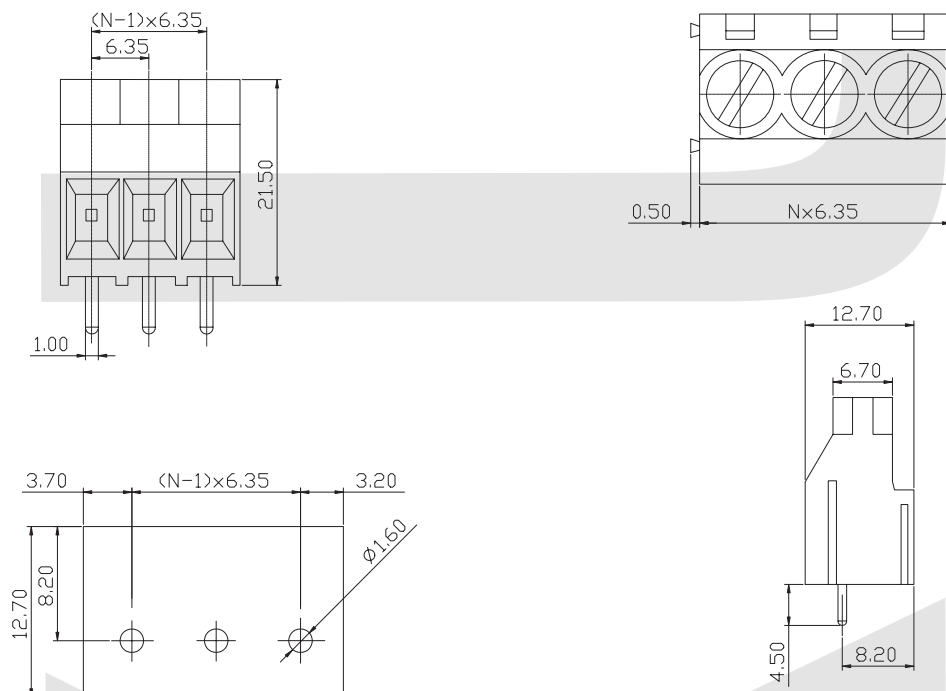
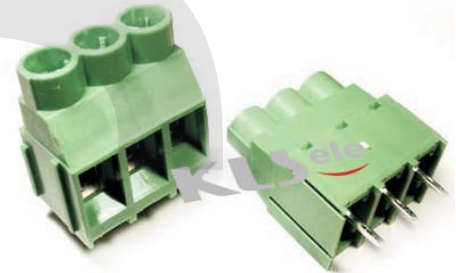

Product NO.: KLS2-135-6.35-XXP X X X

Pos. NO. _____ Customer Request _____

Series No. _____ Screw: C=Cross Screw _____

Pitch: 6.35=6.35mm _____ S=Slot Screw _____

Number of Pole _____ Color: 1=Gray 2=Blue 3=Black
 4=Green 5=Orange 6=Red
 7=Transparent 8=Yellow 9=White

All specification & dimensions are subject to change, please call your nearest KLS sales representative for update information

TERMINAL BLOCK Connector

KLS electronic
www.cnkls.com

PCB Series

KLS2-128-5.00/7.50 Series Pitch=5.00mm/7.50mm

Electrical :

Rated voltage: 300V
Rated current: 16A
Contact resistance: 20mΩ
Insulation resistance: 5000MΩ/1000V
Withstanding Voltage: AC1500V/1Min
Wire range: 24-12AWG 2.5mm²

Material

Screws: M2.5 steel Zinc plated
Contact: Brass
Pin header: Brass, Tin plated
Housing: PA66, UL94V-0

Mechanical

Temp. Range: -40°C~+105°C
MAX Soldering: +250°C for 5 Sec.
Torque: 0.4Nm (3.6lb.in)
Strip length: 6-7mm

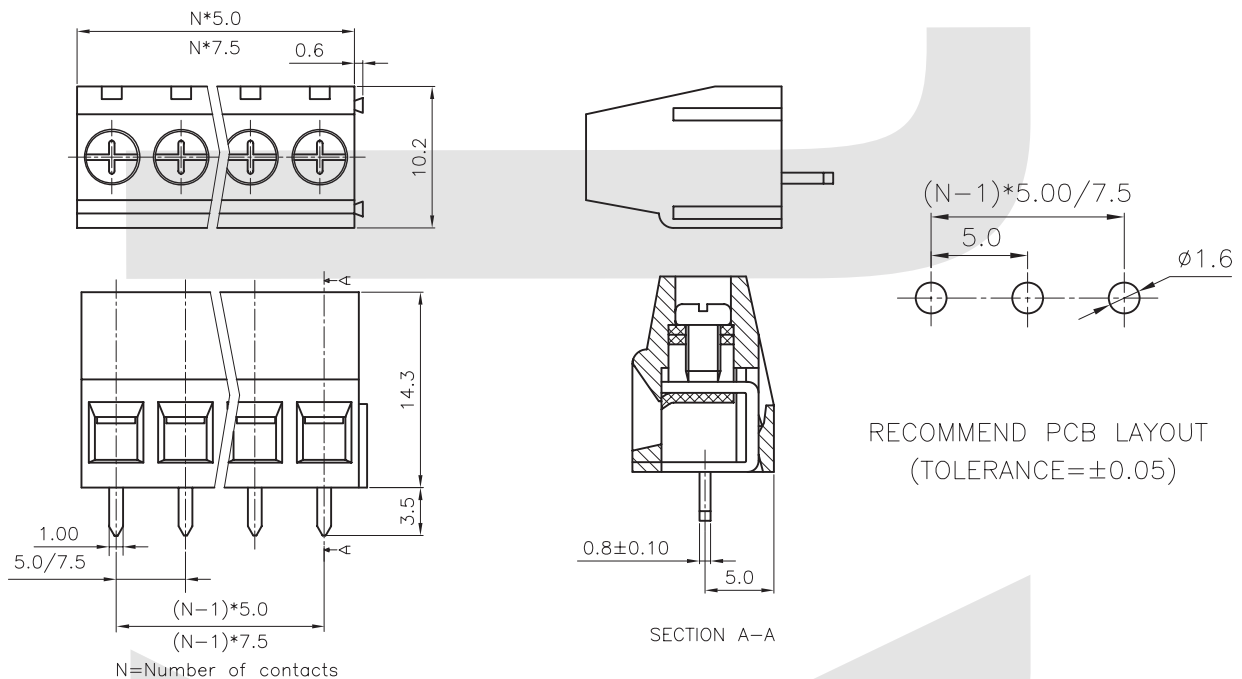
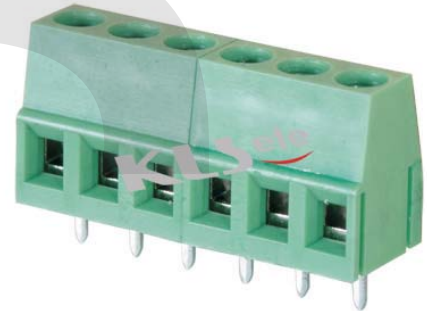

ORDER INFORMATION

Product NO.: KLS2-128-5.00-XXP X X X

Pos. NO.

Series No.

Pitch: 5.00=5.00mm
7.50=7.50mm

Number of Pole

Customer Request

Screw: C=Cross Screw
S=Slot Screw

Color: 1=Gray 2=Blue 3=Black
4=Green 5=Orange 6=Red
7=Transparent 8=Yellow 9=White

All specification & dimensions are subject to change, please call your nearest KLS sales representative for update information

TERMINAL BLOCK Connector

KLSelectronic
www.cnkls.com

PCB Series

KLS2-128R-5.00/7.50 Series Pitch=5.00mm/7.50mm

Electrical :

Rated voltage: 300V
Rated current: 16A
Contact resistance: 20mΩ
Insulation resistance: 5000MΩ/1000V
Withstanding Voltage: AC1500V/1Min
Wire range: 24-12AWG 2.5mm²

Material

Screws: M2.5 steel Zinc plated
Contact: Brass
Pin header: Brass, Tin plated
Housing: PA66, UL94V-0

Mechanical

Temp. Range: -40°C~+105°C
MAX Soldering: +250°C for 5 Sec.
Torque: 0.4Nm (3.6lb.in)
Strip length: 6-7mm

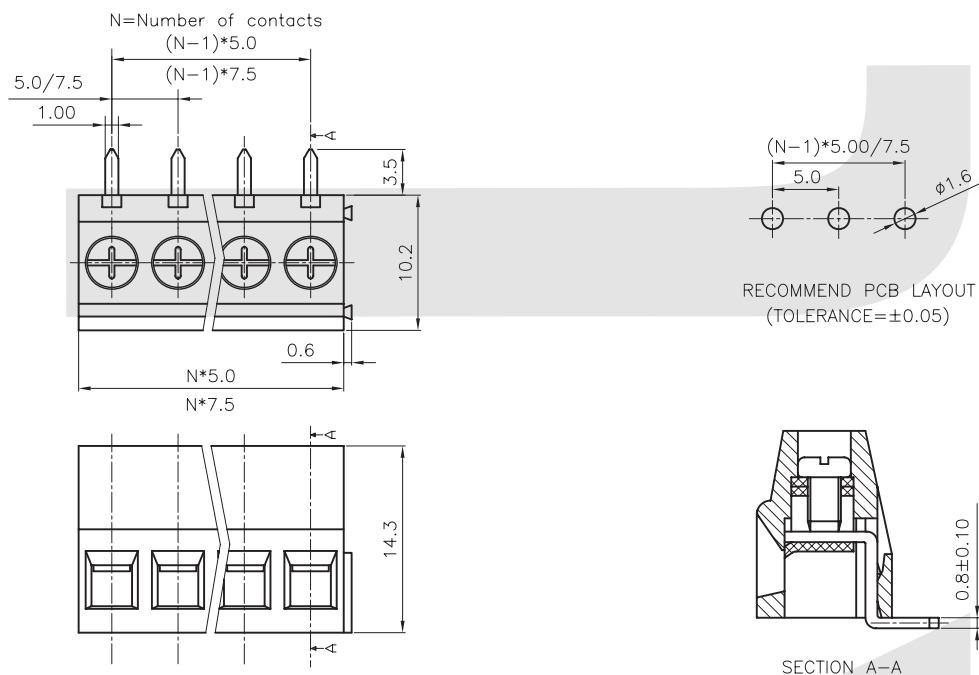

ORDER INFORMATION

Product NO.: KLS2-128R-5.00-XXP X X X

Pos. NO.

Series No.

Pitch: 5.00=5.00mm
7.50=7.50mm

Number of Pole

Customer Request

Screw: C=Cross Screw
S=Slot Screw

Color: 1=Gray 2=Blue 3=Black
4=Green 5=Orange 6=Red
7=Transparent 8=Yellow 9=White

All specification & dimensions are subject to change, please call your nearest KLS sales representative for update information

TERMINAL BLOCK Connector

KLS electronic
www.cnkls.com

PCB Series

KLS2-300-7.50 Series Pitch=7.50mm

Electrical :

Rated voltage: 300V
Rated current: 16A
Contact resistance: 20mΩ
Insulation resistance: 5000MΩ/1000V
Withstanding Voltage: AC1500V/1Min
Wire range: 22-14AWG 2.5mm²

Material

Screws: M3 steel Zinc plated
Wire guard: phosphor bronze Ni plated or stainless steel
Pin header: Brass, Tin plated
Housing: PBT,UL94V-0

Mechanical

Temp. Range: -30°C~+120°C
MAX Soldering: +250°C for 5 Sec.
Torque: 0.5Nm (4.5lb.in)
Strip length: 4.5-5mm

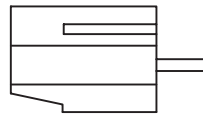
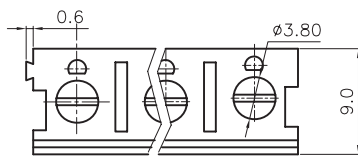

N=Number of contacts

STRAIGHT TYPE

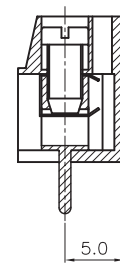
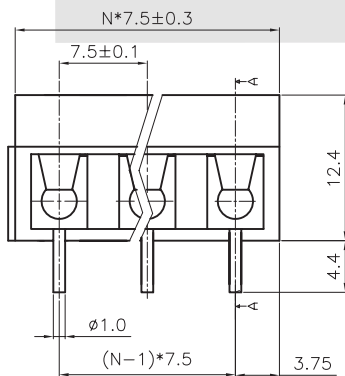

SECTION A-A

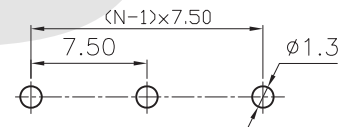

P.C.B. LAYOUT

ORDER INFORMATION

Product NO.: KLS2-300-7.50-XXP X X X

Pos. NO.

Series No.

Pitch: 7.50=7.50mm

Number of Pole

Customer Request

Screw: C=Cross Screw
S=Slot Screw

Color: 1=Gray 2=Blue 3=Black
4=Green 5=Orange 6=Red
7=Transparent 8=Yellow 9=White

All specification & dimensions are subject to change, please call your nearest KLS sales representative for update information

TERMINAL BLOCK Connector

KLSelectronic
www.cnkls.com

PCB Series

KLS2-150-9.50 Series Pitch=9.50mm

Electrical :

Rated voltage: 300V
Rated current: 30A
Contact resistance: 20mΩ
Insulation resistance: 5000MΩ/1000V
Withstanding Voltage: AC2000V/1Min
Wire range: 26-10AWG 4mm²

Material

Screws: M3 steel Zinc plated
Contact: Brass, Ni plated
Pin header: Brass, Tin plated
Housing: PA66, UL94V-0

Mechanical

Temp. Range: -40°C~+105°C
MAX Soldering: +250°C for 5 Sec.
Torque: 0.5Nm (4.5 lb.in)
Strip length: 6-7mm

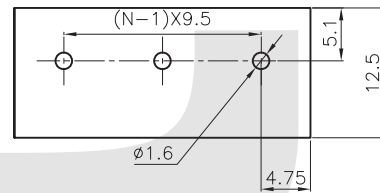
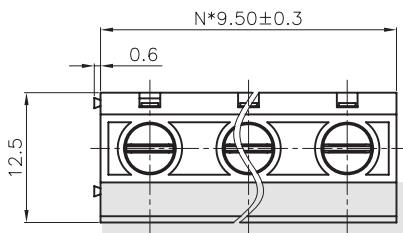

RECOMMEND PCB LAYOUT(TOLERANCE=±0.05)

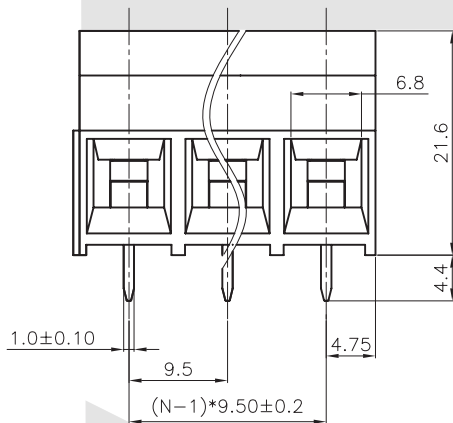

N表示端子的数量

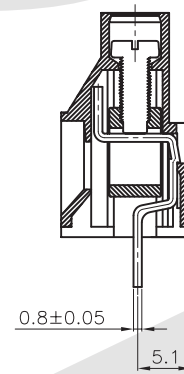

剖面 A-A

ORDER INFORMATION

Product NO.: KLS2-150-9.50-XXP X X X

Pos. NO.

Series No.

Pitch: 9.50=9.50mm

Number of Pole

Customer Request

Screw: C=Cross Screw
S=Slot Screw

Color: 1=Gray 2=Blue 3=Black
4=Green 5=Orange 6=Red
7=Transparent 8=Yellow 9=White

All specification & dimensions are subject to change, please call your nearest KLS sales representative for update information