

Wiring Accessories

Cable Clamp Series

KLS8-0408 (PUSH TIE MOUNT)

Material : UL Approved Nylon66, 94V-2

Color : Nature

Fix wires on board.Easy to maintenance.Do not take up spaces.
Drill 6.2mm hole on board to fix tie mount and then insert tie into
the mount for bundling cables.



Unit: mm

Item No.	T	Mounting Hole	Packing
PHC-4	3.8	4.8	100pcs
PHC-5	5	7.6	
PHC-6.5	6.5	8.5	
PHC-8	8.1	6.2	
PHC-9	9.4	7.9	
PHC-1509	7.8	4.5	

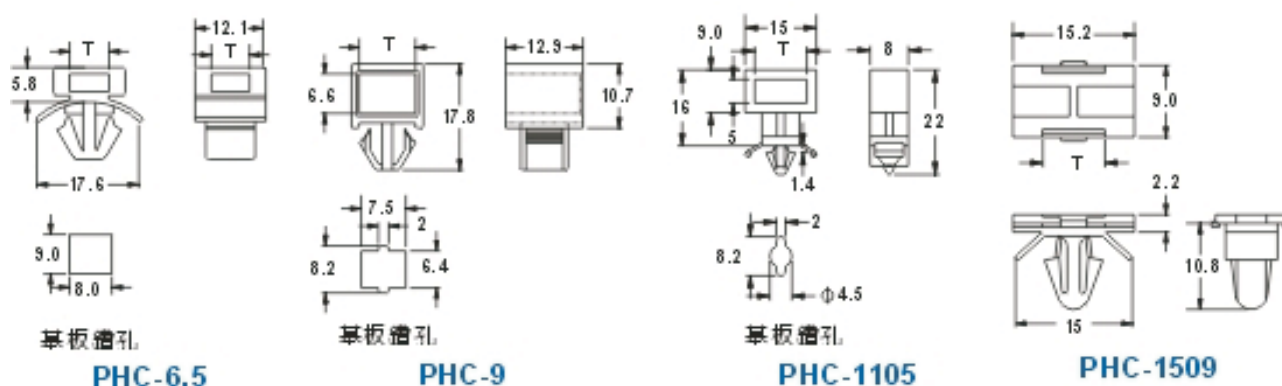
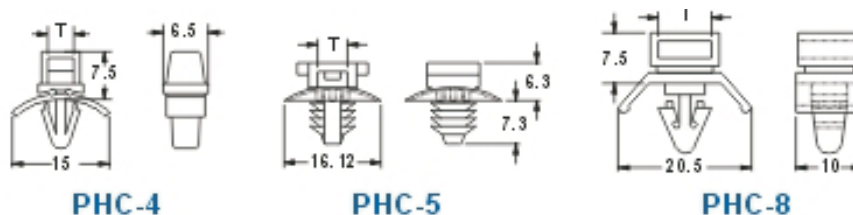

Order Information

Product No.: KLS8-0408

Pos. No. _____

PUSH TIE MOUNT Series _____



Cable Clamp Series

KLS8-0412 (ADJUSTABLE CABLE CLAMP)

Material: UL approved Natural NYLON 66, 94V-2

Unit: mm

Item No.	A	B	C	L / Max.Bundle Dia		Packing
ATC-17	25.0	18.0	7.9	70	/ 17.0	100pcs
ATC-22	30.5	21.0	12.0	90	/ 22.0	
ATC-26	30.5	21.0	12.0	108	/ 26.0	

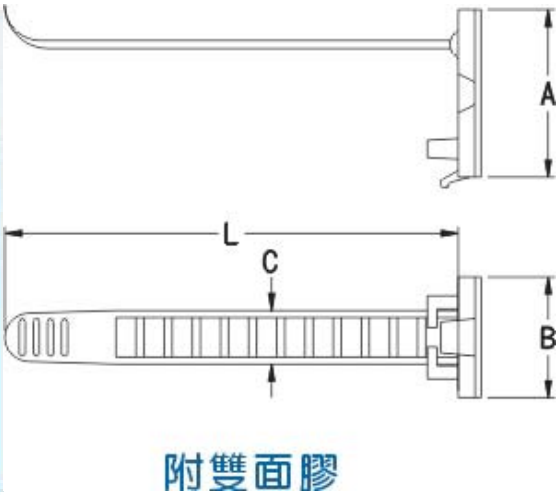

Order Information

Product No.: KLS8-0412

Pos. No. _____
ADJUSTABLE CABLE CLAMP Series

Cable Clamp Series

KLS8-0415 (SELF-ADHESIVE WIRE CLIP)

Material: UL approved Natural Nylon 66, 94V-2. (Backed with Adhesive tape)
Self-adhesive wire clip is designed to support light weight wire bundles
when properly applied on any clear, smooth, grease-free surface.
Color: Natural

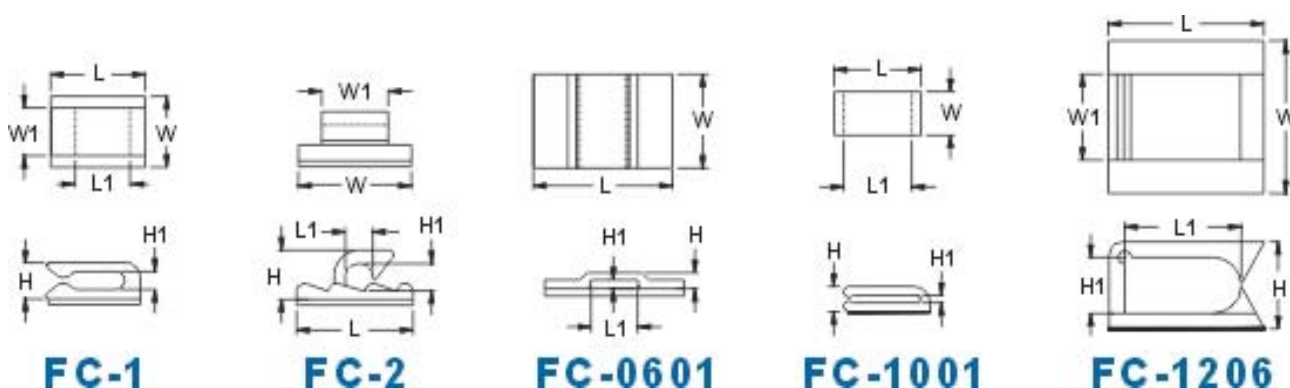
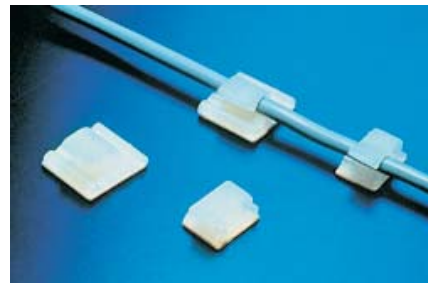

Unit: mm

Item No.	L	L1	W	W1	H	H1	Packing
FC-1	13.0	9.0	9.5	6.5	5.2	2.8	100pcs
FC-2	16.0	4.0	15.5	9.0	6.8	4.0	
FC-1001	11.9	9.3	6.0	=	3.5	1.0	
FC-1206	16.0	11.9	15.8	8.9	9.0	5.8	

Order Information

Product No.: KLS8-0415

Pos. No. _____

SELF-ADHESIVE WIRE CLIP Series

Cable Clamp Series

KLS8-0417 (SELF-ADHESIVE WIRE CLIP)

Material: UL approved Natural Nylon 66, 94V-2. (Backed with Adhesive tape)
Color: Natural

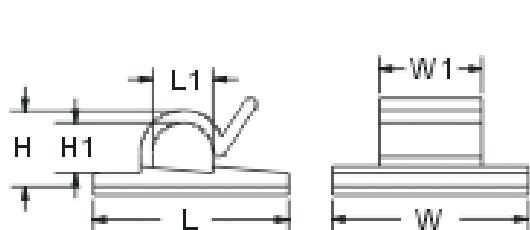

FC-0605

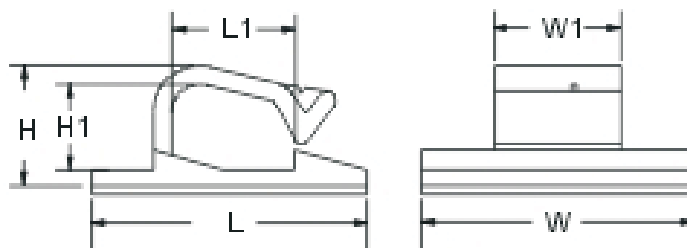

FC-1208

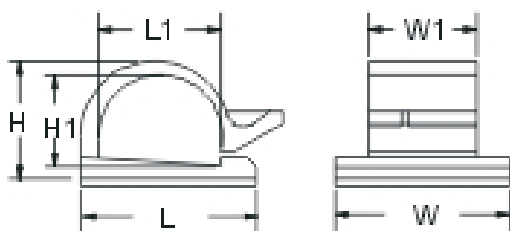

FC-1813

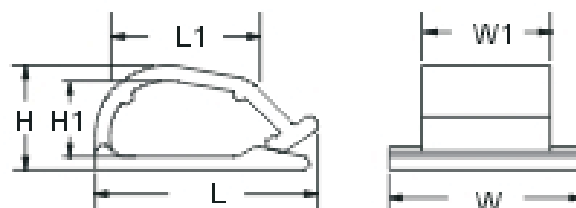

FC-2211

Unit: mm

Item No.	L	L1	W	W1	H	H1	Packing
PC-0605	19.0	5.9	19	10.0	7.2	4.9	100pcs
PC-1208	26.8	11.9	26.5	12.3	11.7	8.3	
PC-1813	25.6	17.8	25.5	15.8	17.2	13.3	
PC-2211	32.5	22.2	28.3	18.7	15.2	11.1	

Order Information

Product No.: KLS8-0417

Pos. No. _____

SELF-ADHESIVE WIRE CLIP Series

Cable Clamp Series

KLS8-0424 (SELF-ADHESIVE WIRE CLIP)

Material: UL approved Natural Nylon 66, 94V-2. (Backed with Adhesive tape)
Color: Natural

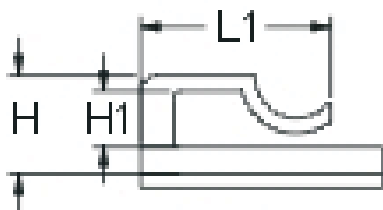
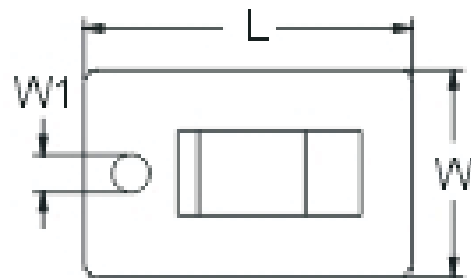
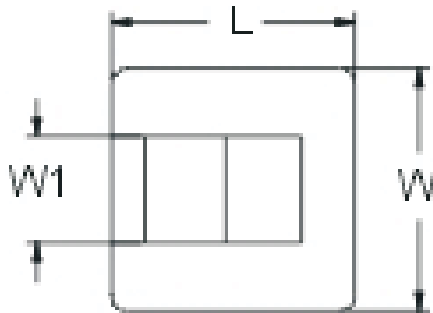

FC-3

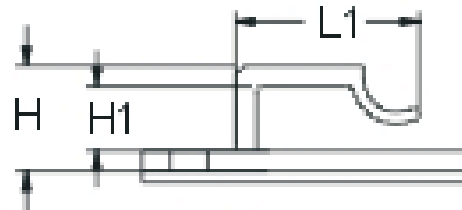

FC-4

Unit: mm

Item No.	L	L1	W	Aperture /W1	H	H1	Packing
FC-3	16	12.5	16	0 / 8.8	8.7	3.7	100pcs
FC-4	25	14.8	16	3.1/8.8	5.5	4.2	
FC-5	27	14.8	17	3.1/8.8	8.7	6.0	

Order Information

Product No.: KLS8-0424

Pos. No. _____

SELF-ADHESIVE WIRE CLIP Series

Cable Clamp Series

KLS8-0426

Material : UL Approved Nylon66, 94V-2
Color : Nature
Easy Mounting with adhesive tape.

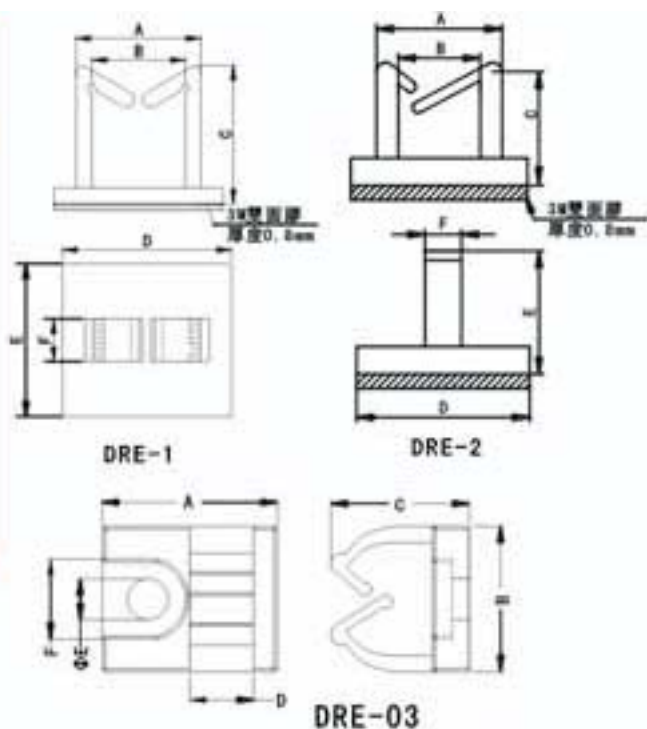

單位：mm

型 號 Item No.	A	B	C	D	E	F	包 裝 Packing
DRE-01	15.5	11.6	17.2	21.0	19.0	5.3	100pcs
DRE-02	6.9	4.5	4.7	9.5	6.7	2.0	
DRE-03	10.7	8.9	8.4	3.9	2.5	4.9	

材 質：UL合格之NYLON66 (本色)，防火等級94V-2。
使用方法：背膠式，固定電線於機器中，整齊完美。

Cable Clamp Series

KLS8-0211

- Material: UL approved Nylon 66, 94V-2.
- Color: Natural, available in other colors.
- To be fixed by 2 sets of 3mm flat-head screw.
- BT-90A,BT-155A,BT-160A with snap in design



VIII

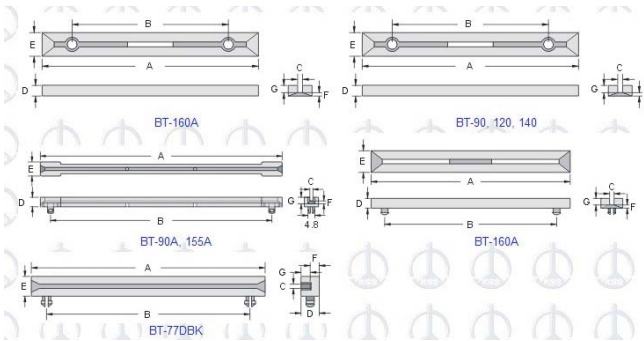

Unit: mm

Item No.	A	B	C	D	E	F	G	Packing
BT-90A	89.5	77.5	2.0	4.5	9.5	1.5	3.0	100 pcs / Bag
BT-90	89.5	64.4	2.0	4.5	9.5	1.5	3.0	
BT-120	119.0	94.5	2.0	4.5	9.5	1.5	3.0	
BT-140	141.0	115.4	2.0	4.5	9.5	1.5	3.0	
BT-155A	154.0	141.0	2.0	4.6	6.5	1.3	3.3	
BT-160	160.5	134.5	2.0	4.5	9.5	1.5	3.0	
BT-160A	163.0	149.5	2.0	6.5	9.5	2.2	2.3	

KLS8-0211B (CIRCUIT BOARD TRACK)

Material: UL approved Nylon 66, 94V-2

Unit:mm

Model No.	A	B	Packaging
CG-250	63.5	50.8	250
CG-300	76.2	63.5	
CG-350	88.9	76.2	
CG-400	101.6	88.9	
CG-450	114.3	101.6	
CG-500	127.0	114.3	
CG-550	139.7	127.0	
CG-600	152.4	139.7	

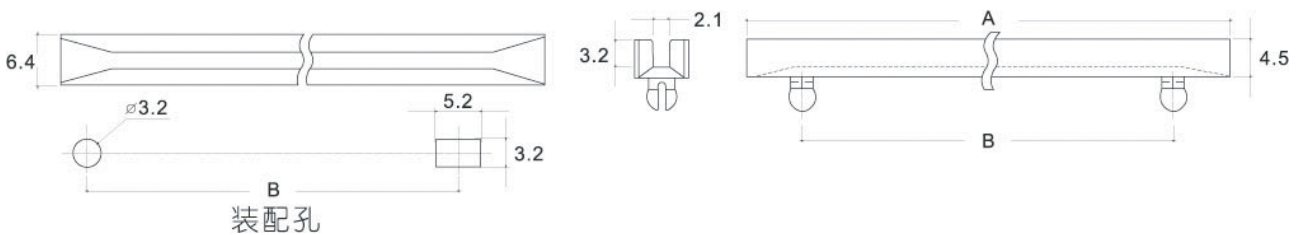

Cable Clamp Series

KLS8-0231 (CIRCUIT BOARD TRACK)

Material: UL approved Nylon 66, 94V-2



Unit:mm

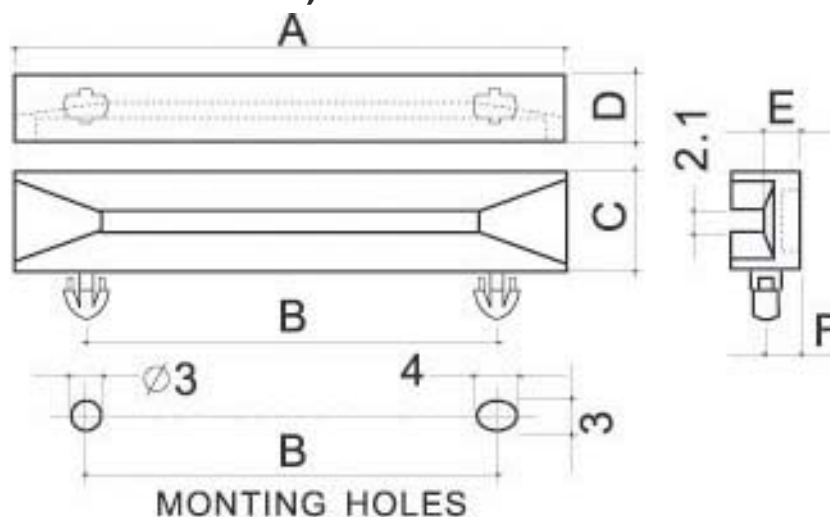

Model No.	A	B	C	D	E	F		Packaging
BCL-40A	38.4	20.0	9.2	6.4	3.4	3.2		500
BCL-40B	38.4	20.0	9.2	6.4	3.4	3.2		
BCL-40C	40.0	20.0	8.0	6.0	3.0	3.0		
BCL-50A	51.0	38.2	9.2	6.4	3.4	3.2		
BCL-80A	81.0	60.0	8.0	6.0	3.0	3.0		250
BCL-80B	81.0	60.0	8.0	6.0	3.0	3.0		
BCL-80C	81.0	60.0	8.0	6.0	3.0	3.0		
BCL-90A	91.5	71.0	8.0	6.0	3.0	3.0		
BCL-90B	91.5	71.0	8.0	6.0	3.0	3.0		

KLS8-0425 (LADDER TYPE CABLE HOLDER)

Material: UL approved grey Nylon 66, 94V-2



Item No.	L	W	H	Packing
LCH-60BK	28	19	60	50pcs
LCH-120BK	28	19	120	
LCH-160BK	28	19	160	

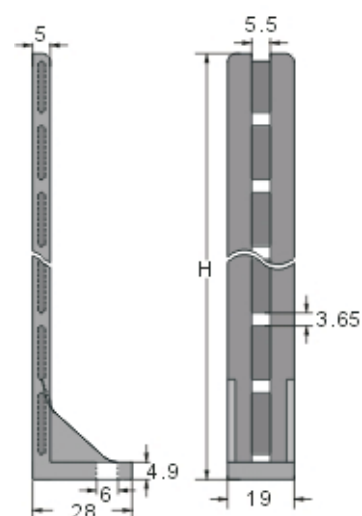

Cable Clamp Series

KLS8-0427 (CABLE CLAMP)

- Material: Made of finest PVC backed with quality adhesive tape.
- Color: Grey.



Item No.	L	W1	W2	Packing
CL-15	15	18.5	16	100pcs
CL-20	20	18.5	16	
CL-25	25	18.5	16	
CL-28	28	18.5	16	

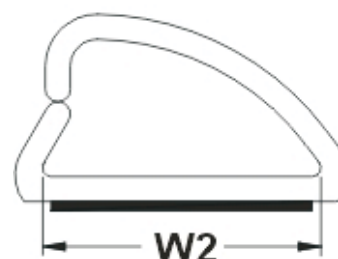

KLS8-0428 (CABLE CLAMP)

- Material: Made of finest PVC backed with quality adhesive tape.
- Color: Grey.

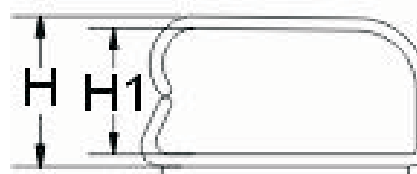
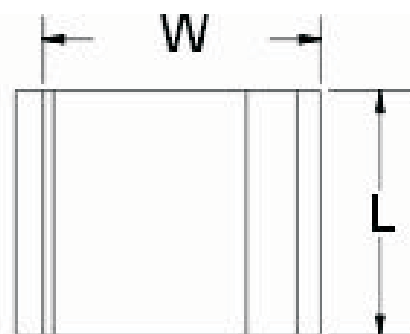
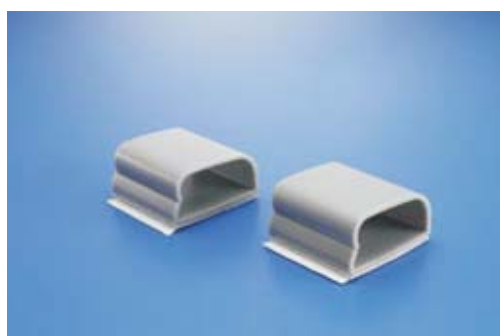

Item No.	L	W	H/H1	Packing
RCL-12	25.4	28.5	13.8/11.4	100pcs

Cable Clamp Series

KLS8-0310 (WIRE HOLDERS)

Material : UL Approved Nylon66, 94V-2
Mounting Hold Diameter:Ø4.8±0.1mm
Assures precision routing
Lifts wires off board to avoid hot components and minimize transient interference.

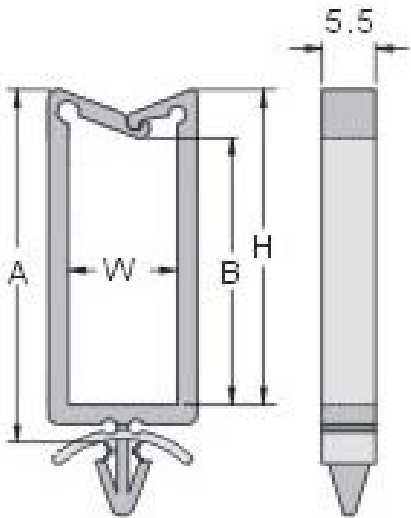

Unit: mm

Item No.	Dimension				PCB		Packing
	H	A	B	W	hole	thickness	
KWS-0	9.0	13.0	4.0	11.0	4.8	2.0	100 pcs / 1000pcs Bag
KWS-1	14.2	19.0	10.5	11.0	4.8	2.0	
KWS-2	23.0	27.0	19.0	11.0	4.8	2.0	
KWS-2L	15.0	18.0	12.0	10.4	4.8	2.0	
KWS-3	31.1	35.8	28.0	11.0	4.8	2.0	

KLS8-0311 (WIRE HOLDERS)

Material : UL Approved Nylon66, 94V-2.
Color : Nature
Safely isolates cable wire from board components.
Lock is releasable for repair, replacement or addition of wire or cable.

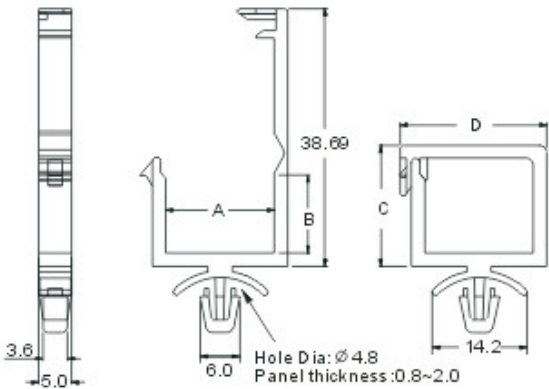

Part No.	A	B	C	D	Package
CH-D	16.2	15.0	18.1	21.84	1000

Unit:mm

Cable Clamp Series

KLS8-0306 (WIRE HOLDERS)

Material: UL approved Nylon 66, 94V-2
Drill holes on chasis board as shown. borad
Push support into the larger hole and slide onto the smaller one
as fixation and then press the PCB board onto the support.



Item No.	Dimension		Mounting Hole/PCB thickness	Packing
	A	B		
RH-5	5.1	8	5.5/2.0	100pcs (1000pcs)
RH-6	6.2	9.5	8.0/1.8	
RH-8	7.5	8.8	6.2/2.0	

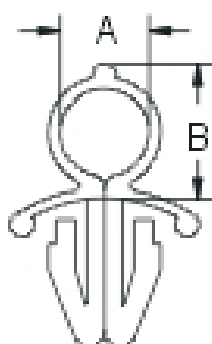

RH-5,8

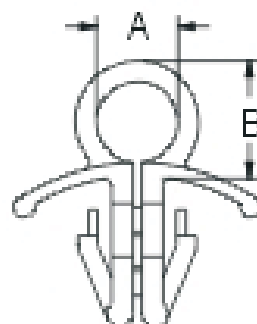

RH-6,9

KLS8-0429 (WIRE SADDLE)

Material : UL Approved Nylon6/6, 94V-2
Color : Nature

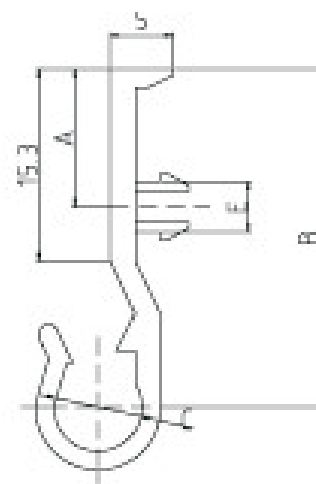

Part No.	A	B	C	D	E	Package
FGH-02	11	27	Φ7	10	4	100

Unit:mm

Cable Clamp Series

KLS8-0405 (FLAT CABLE CLAMP)

Material:UL Approved Nylon 6/6,94V-2
Tensioning device holds cables firmly place.

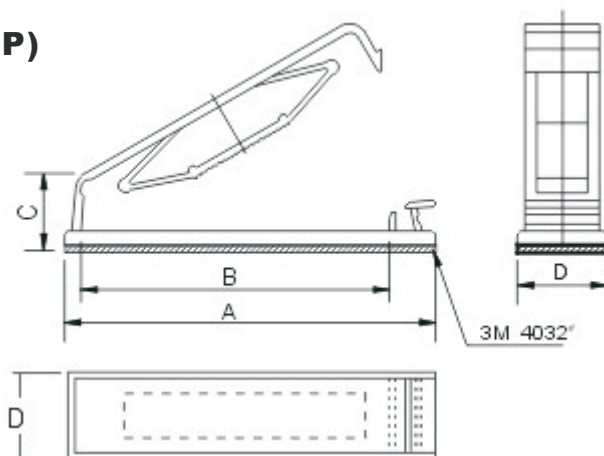

Part NO.	A	B	C	D	Package
FCC-40	67	54	13.0	8.0	100
FCC-50	78	64.9	16.3	18.8	100

KLS8-0301 (TWIST LOCK)

Material: UL approved Nylon 66, 94V-2 (Black)
To hold separate running cable bundles.

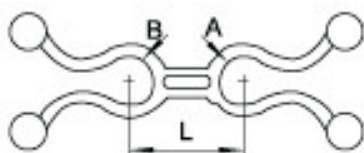

PL-08

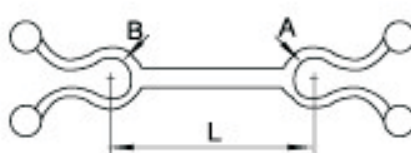

PL-0740

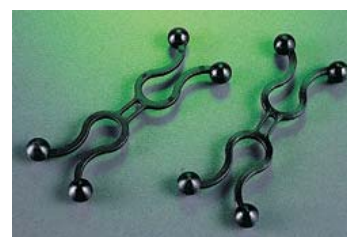

Unit:mm

Item No.	Dimension			Packing
	A	B	L	
PL-8	8	8	18	100pcs
PL-0740	7.5	7.5	40	(1000pcs)

Cable Clamp Series

KLS8-0302 (TWIST LOCK)

Material: UL approved Nylon 66, 94V-2 (Available in P.P. or P.E.)
Colors available upon request.
Tie-up cables at economical cost.
Open the ties to feed cable and twist on to fix.

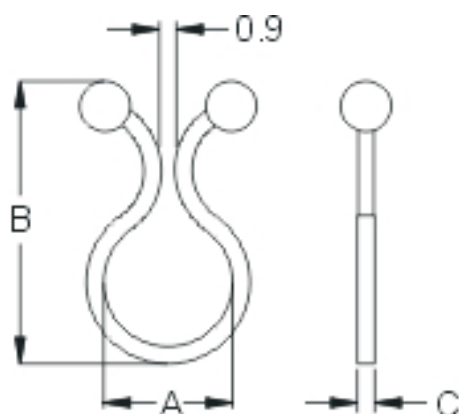
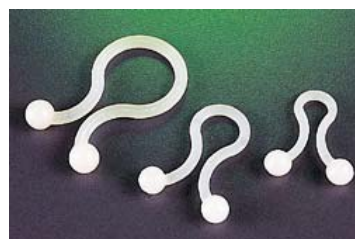

Standard design

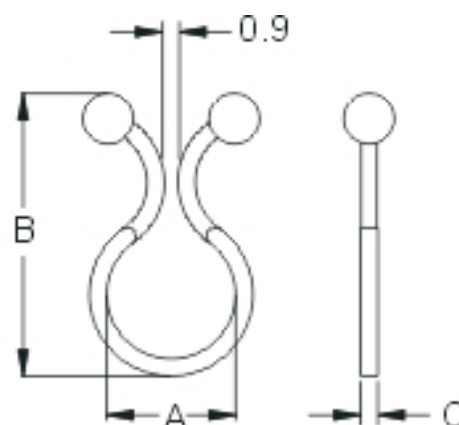

TTU-08, -11, -15, -28

Item No.	Dimension			Bundls Diameter	Packing
	A	B	C		
TT-05	5.1	21.6	1.5	4.4	100pcs (1000pcs)
TT-08	7.0	25.0	2.0	7.0	
TT-11	11.6	29.8	1.7	10.1	
TT-15	15.0	33.8	1.9	13.4	
TT-18	18.6	40.0	1.9	16.2	
TT-24	23.6	45.0	2.0	21.3	

Item No.	Dimension			Bundls Diameter	Packing
	A	B	C		
TTU-05	5.0	22.0	1.8	4.2	100pcs (1000pcs)
TTU-08	8.1	26.2	2.3	7.2	
TTU-11	11.3	29.7	2.3	10.0	
TTU-15	14.8	36.6	2.0	13.2	
TTU-18	18.0	38.0	2.0	16.5	
TTU-28	28.0	55.1	2.0	26.7	

Cable Clamp Series

KLS8-0303 (ADHESIVE TWIST LOCK)

Material: UL approved Nylon 66, 94-2 (Backed with adhesive tape)
Peel off adhesive paper before usage and insert cables into the twist lock and general twist ties.

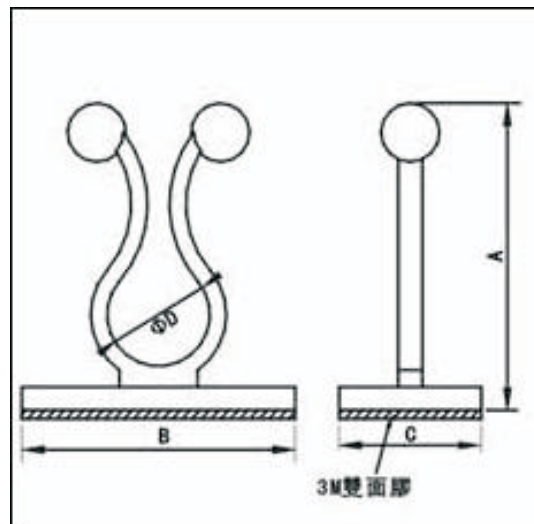
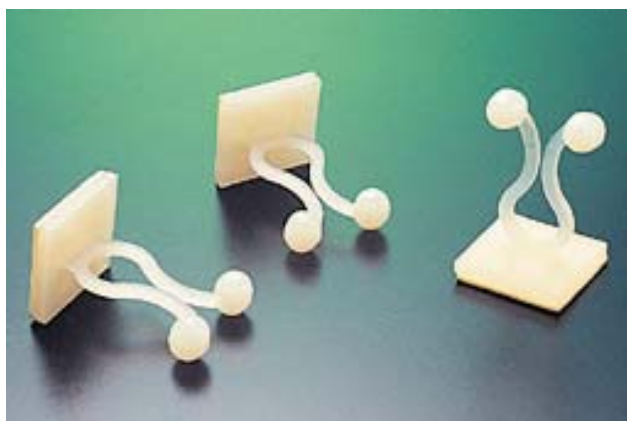

型 號 Item No.	A	B	C	D	包 裝 Packing
CTB-01	32.3	20.0	20.0	15.0	100pcs (1000pcs)
CTB-02	26.1	20.0	14.0	9.2	
CTB-02L	28.0	25.0	13.0	9.4	
CTB-03	28.1	21.0	19.0	11.1	
CTB-05	55.8	38.0	20.0	36.0	
CTB-06	27.6	10.0	19.8	6.6	
CTB-07	21.9	20.0	13.0	8.5	
CTB-08	27.5	17.4	13.5	7.9	
CTB-15	35.2	22.0	13.5	14.8	
CTB-16	37.0	25.0	13.0	18.0	
CTB-19	39.2	25.0	13.0	21.0	
CTB-20	40.0	25.5	15.0	20.6	
CTB-22	41.3	28.0	15.0	24.0	

Cable Clamp Series

KLS8-0315 (TWIST LOCK)

Material: UL approved Nylon 66, 94V-2
Locking into pre-drilled 4.8mm hole, Assembles cables into 'W' part and locks with a twist.

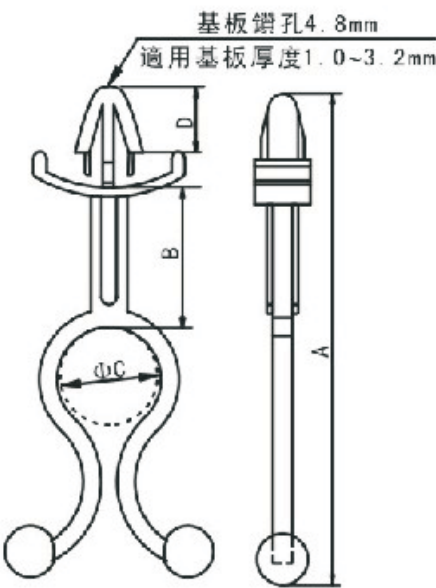
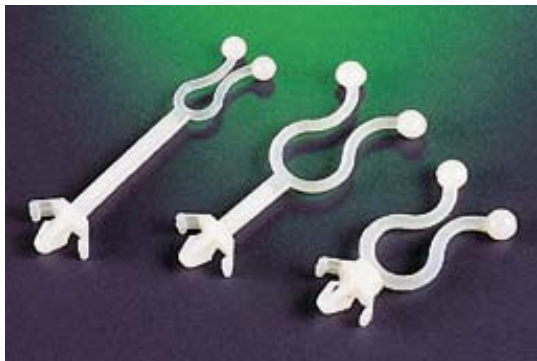

Unit: mm

型號 Item No.	A	B	C	D	包裝 Packing
CTS-01	33.8	3.1	7.1	10.6	1000PCS
CTS-02	51.0	20.0	7.1	10.6	500PCS
CTS-03	66.0	35.3	7.1	10.6	
CTS-04	39.6	2.8	10.8	10.6	1000PCS
CTS-05	56.8	20.0	10.8	10.6	500PCS
CTS-06	71.5	35.2	10.8	10.6	
CTS-07	42.0	3.0	15.0	10.6	1000PCS
CTS-08	59.3	20.4	15.0	10.6	500PCS
CTS-09	74.7	35.8	15.0	10.6	
CTS-10	63.5	16.2	20.0	10.6	
CTS-11	56.8	3.0	24.3	9.8	
CTS-12	53.1	15.3	11.0	10.6	
CTS-13	102.8	60.4	16.0	10.6	
CTS-14	55.3	5.0	20.3	10.6	
CTS-15	43.8	10.5	8.0	10.6	
CTS-16	34.7	5.6	8.8	10.6	
CTS-17	51.7	12.2	11	10.6	
CTS-18	87.2	46.6	12	10.6	

材質：UL合格之NYLON66(本色)，防火等級94V-2。

Cable Clamp Series

KLS8-0303 (ADHESIVE TWIST LOCK)

Material: UL approved Nylon 66, 94-2 (Backed with adhesive tape)
Peel off adhesive paper before usage and insert cables into the twist lock and general twist ties.

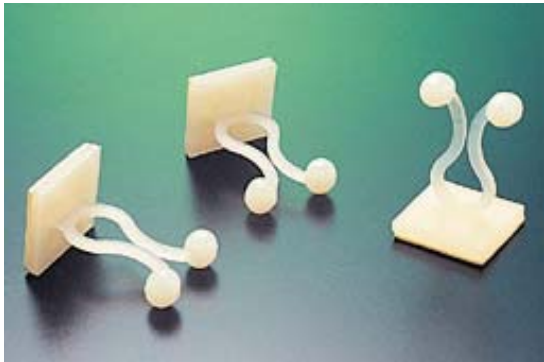

Unit: mm

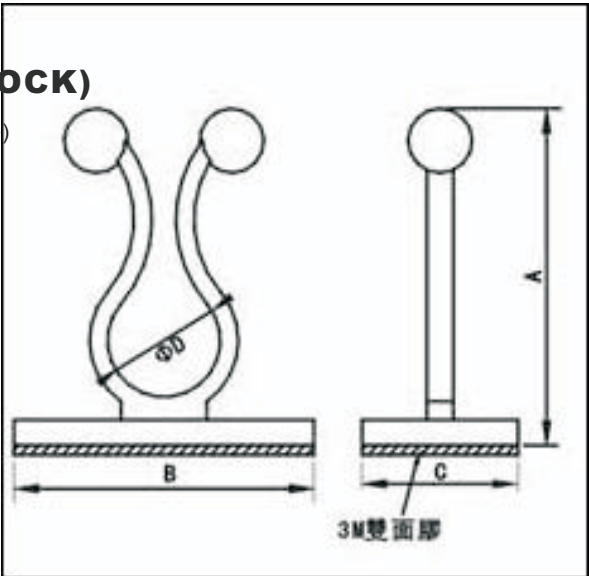

型 號 Item No.	A	B	C	D	包 裝 Packing
CTB-01	32.3	20.0	20.0	15.0	100pcs (1000pcs)
CTB-02	26.1	20.0	14.0	9.2	
CTB-02L	28.0	25.0	13.0	9.4	
CTB-03	28.1	21.0	19.0	11.1	
CTB-05	55.8	38.0	20.0	36.0	
CTB-06	27.6	10.0	19.8	6.6	
CTB-07	21.9	20.0	13.0	8.5	
CTB-08	27.5	17.4	13.5	7.9	
CTB-15	35.2	22.0	13.5	14.8	
CTB-16	37.0	25.0	13.0	18.0	
CTB-19	39.2	25.0	13.0	21.0	
CTB-20	40.0	25.5	15.0	20.6	
CTB-22	41.3	28.0	15.0	24.0	

材質：UL合格之NYLON66(本色)，防火等级94V-2。

Cable Clamp Series

KLS8-0315 (TWIST LOCK)

Material: UL approved Nylon 66, 94V-2

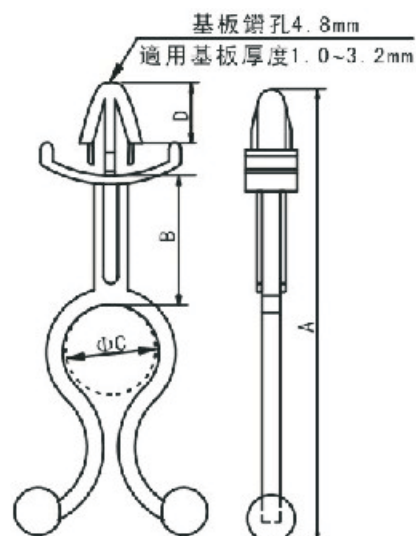

Unit: mm

型號 Item No.	A	B	C	D	包裝 Packing
CTS-01	33.8	3.1	7.1	10.6	1000PCS
CTS-02	51.0	20.0	7.1	10.6	500PCS
CTS-03	66.0	35.3	7.1	10.6	
CTS-04	39.6	2.8	10.8	10.6	1000PCS
CTS-05	56.8	20.0	10.8	10.6	500PCS
CTS-06	71.5	35.2	10.8	10.6	
CTS-07	42.0	3.0	15.0	10.6	1000PCS
CTS-08	59.3	20.4	15.0	10.6	500PCS
CTS-09	74.7	35.8	15.0	10.6	
CTS-10	63.5	16.2	20.0	10.6	
CTS-11	56.8	3.0	24.3	9.8	
CTS-12	53.1	15.3	11.0	10.6	
CTS-13	102.8	60.4	16.0	10.6	
CTS-14	55.3	5.0	20.3	10.6	
CTS-15	43.8	10.5	8.0	10.6	
CTS-16	34.7	5.6	8.8	10.6	
CTS-17	51.7	12.2	11	10.6	
CTS-18	87.2	46.6	12	10.6	

材質：UL合格之NYLON66(本色)，防火等級94V-2。