

Switch

Tact Switch Series

KLS7-TS4401 4.80 x 4.80mm Tact Switch Series



ELECTRICAL

1. Rating: 20mA 12Vdc
2. Contact Resistance : 50mΩ Max.
3. Insulation Resistance: 100MΩ Min.
4. Dielectric Strength : AC250V(50/60Hz for 1minute)
5. Electrically Life: 100, 000cycles
6. Environment temperature: -25°C~+70°C
7. Operating Force: 120/150±10gf
8. Seal temperature: 260°C~ 280°C

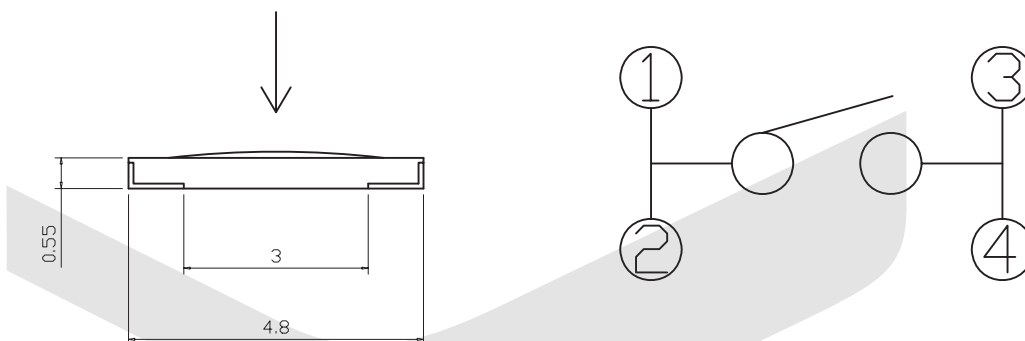
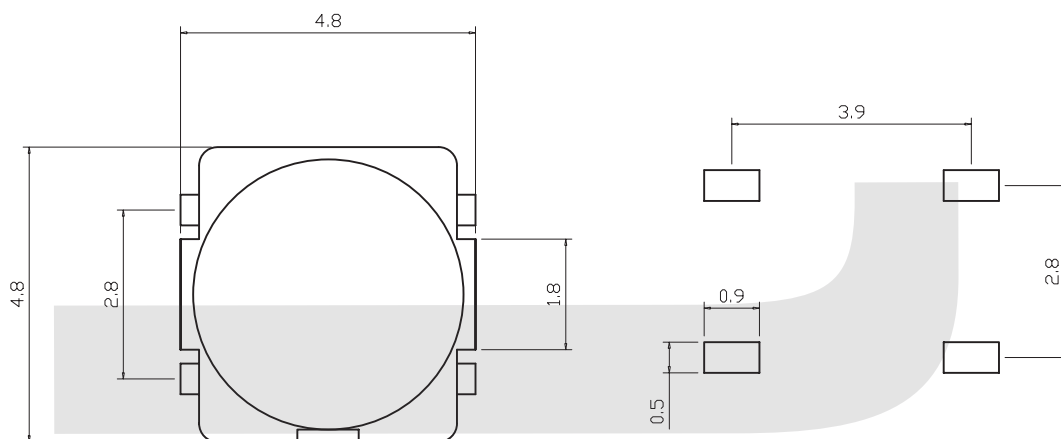
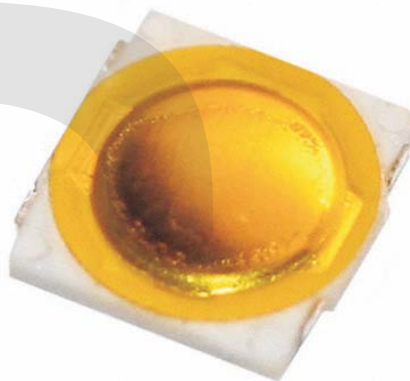

ORDER INFORMATION

KLS7-TS4401 - 120 -B

Part Number _____ Packing: B-Bulk T-Tape
Operating Force :120±10gf or 150±10gf

Switch

Tact Switch Series

KLS7-TS4402 5.10 x 5.10mm Tact Switch Series

ELECTRICAL

- 1.Rating: 20mA 12Vdc
- 2.Contact Resistance : 50mΩ Max.
- 3.Insulation Resistance: 100MΩ Min.
- 4.Dielectric Strength : AC250V(50/60Hz for 1minute)
- 5.Electrically Life: 100, 000cycles
- 6.Environment temperature:-25°C~+70°C
- 7.Operating Force: 180±30gf
- 8.Seal temperature:260°C~ 280°C

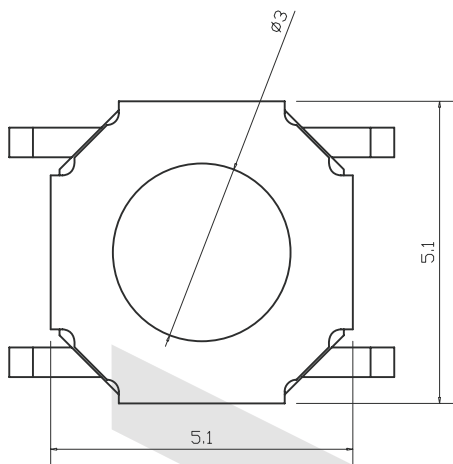
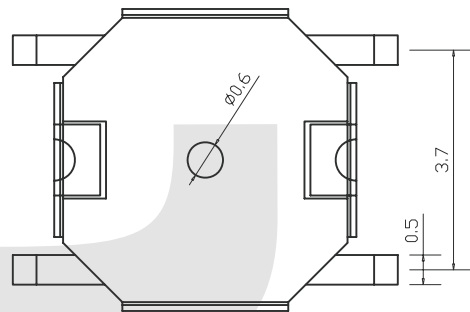
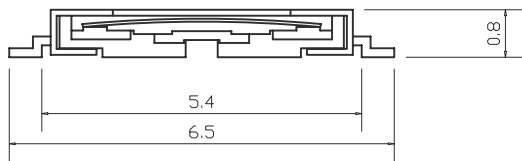
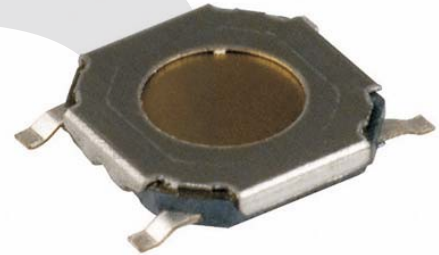

ORDER INFORMATION

KLS7-TS4402 - 180 -B

Series No.

Packing: B-Bulk T-Tape
Operating Force :180±30gf

Switch

Tact Switch Series

KLS7-TS4404 4.80 x 4.80mm Tact Switch Series

ELECTRICAL

1. Rating: 20mA 12Vdc
2. Contact Resistance : 50mΩ Max.
3. Insulation Resistance: 100MΩ Min.
4. Dielectric Strength : AC250V(50/60Hz for 1minute)
5. Electrically Life: 100, 000cycles
6. Environment temperature: -25°C~+70°C
7. Operating Force: 180~250±30gf
8. Seal temperature: 260°C~ 280°C

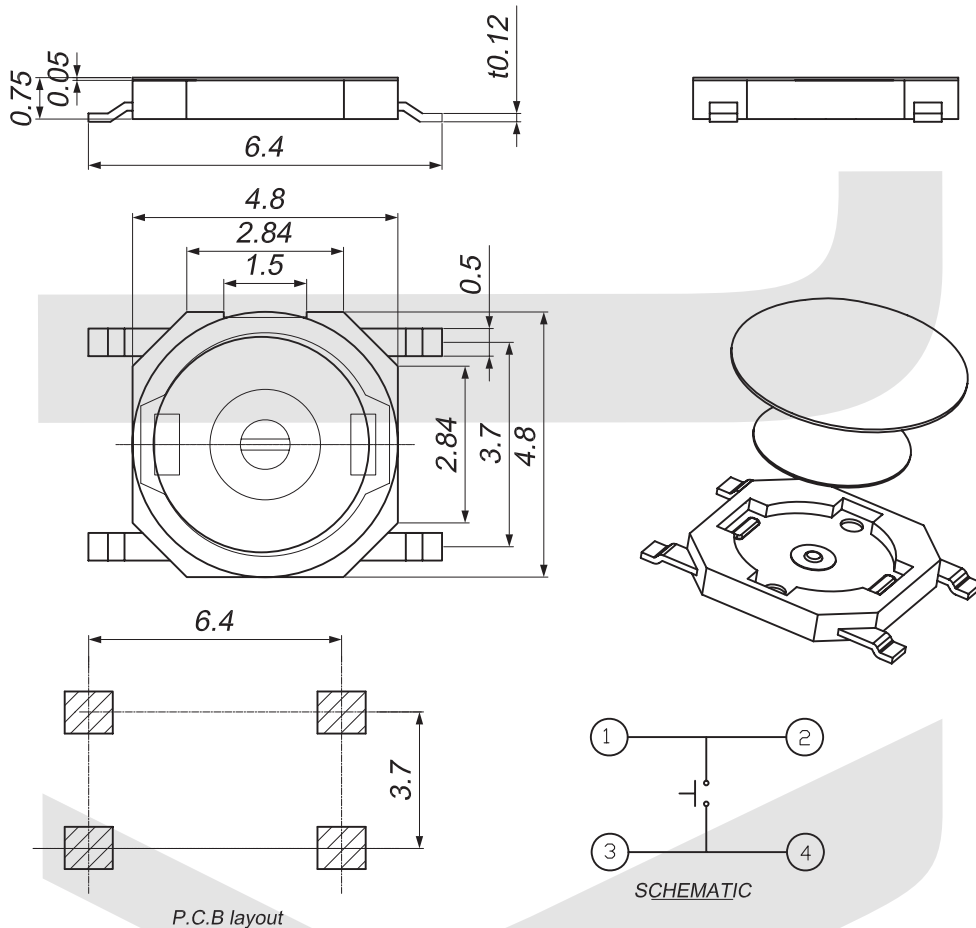
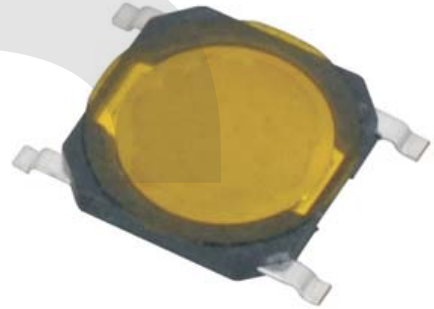

ORDER INFORMATION

KLS7-TS4404 - 180 -B

Series No. _____ Packing: B-Bulk T-Tape
Operating Force :180±30gf

Switch

DIP Switch Series

KLS7-TS4407

SPECIFICATIONS

SIZE: 4.2*4.5mm
Rating:50mA 12 VDC
Contact Resistance:50MΩ Max.
Insulation Resistance:100 MΩ Mim
Dielectric Strength:AC 250V/(50/60Hz for 1minute)
Electrical life:50000cycles
Environment Temp: -20°C-70°C
Operation Force :180/250(30gf)
Seal temperature:260°C-280°C

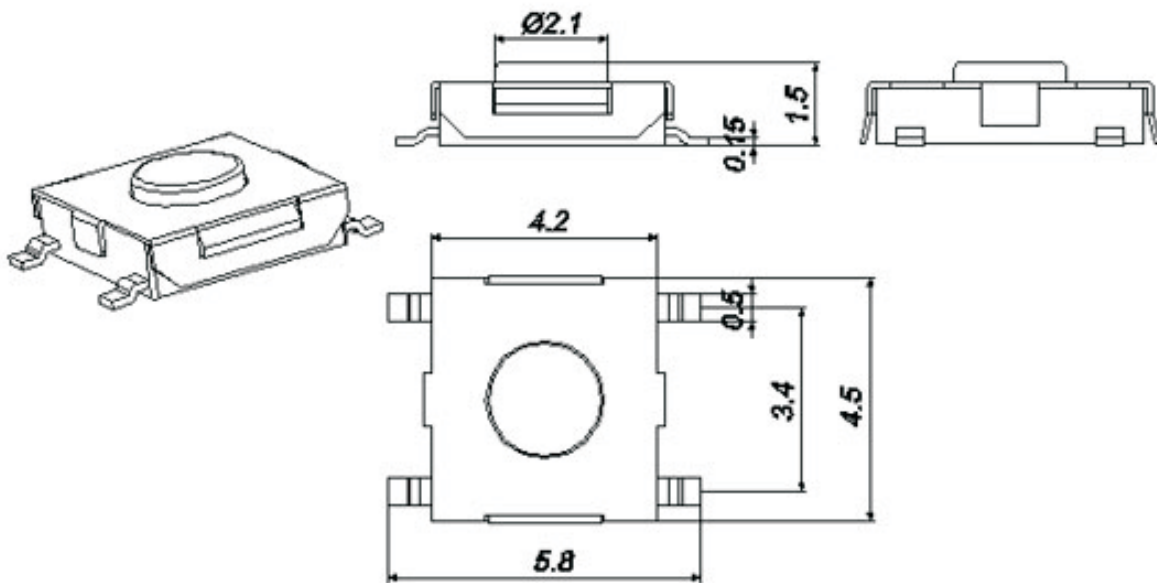
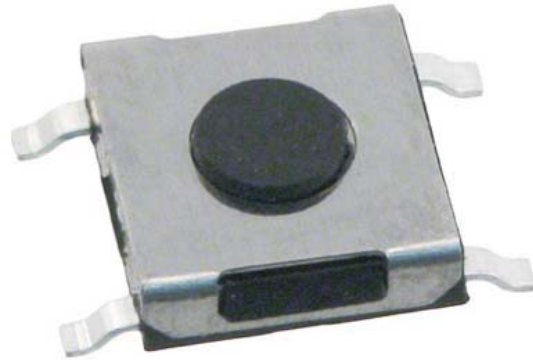

ORDER INFORMATION

KLS7-TS4470-180-B

(1) (2)

(1)-Operating Force :180~250g

(2)-Packing: B=Bulk T=Tape

Tact Switch Series

KLS7-TS4501 4.5x4.5mm Tact Switch Series

ELECTRICAL

1. Rating: 50mA 12VDC
2. Contact Resistance : 50mΩ max(initial)
3. Insulation Resistance: 100MΩ(minDC 250V)
4. Dielectric Strength : AC250V(50/60Hz for 1minute)
5. Electrically Life: 100000cycles
6. Environment temperature: -20°C~+70°C
7. Operating Force: 180/250(±30gf)
8. Seal temperature: 260°C~ 280°C

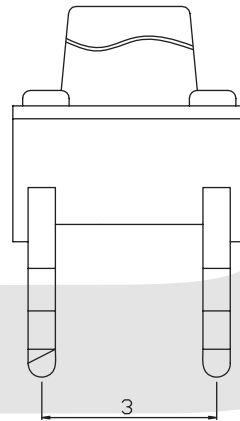
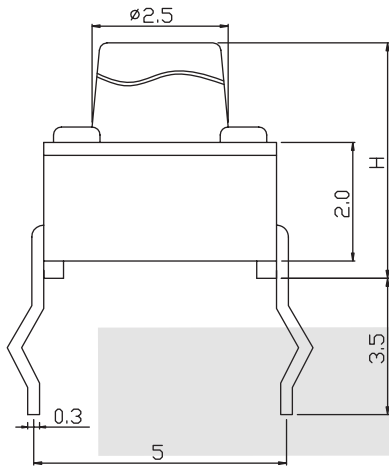

| H |
|-----|
| 3.8 |
| 4.8 |
| 7.0 |
| 8.5 |

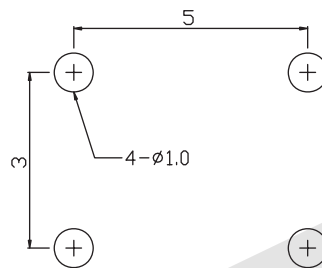
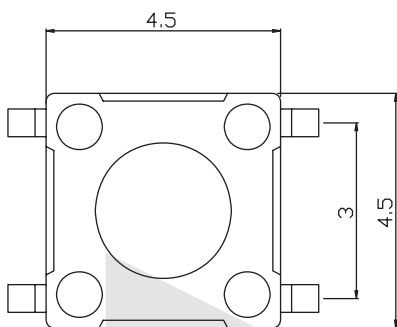

PCB LAYOUT

ORDER INFORMATION

KLS7-TS4501 - 4.3 - 180 - B

Series No. _____
Hight: 3.8mm/4.8mm/
7.0mm/8.5mm

Packing: B=Bulk T=Tape
Operating Force : 180~250gf

Switch

Tact Switch Series

KLS7-TS4503 4.50 x 4.50mm Tact Switch Series

ELECTRICAL

- 1.Rating: 20mA 12Vdc
- 2.Contact Resistance : 50mΩ Max.
- 3.Insulation Resistance: 100MΩ Min.
- 4.Dielectric Strength : AC250V(50/60Hz for 1minute)
- 5.Electrically Life: 100, 000cycles
- 6.Environment temperature:-25°C~+70°C
- 7.Operating Force: 180~250±30gf
- 8.Seal temperature:260°C~ 280°C

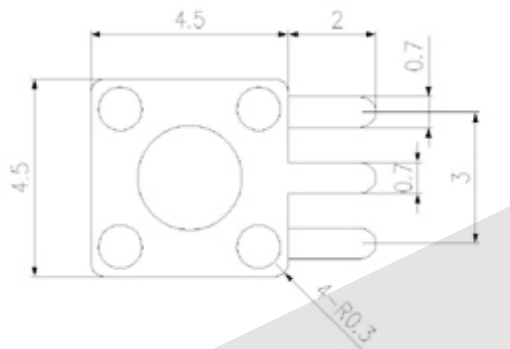
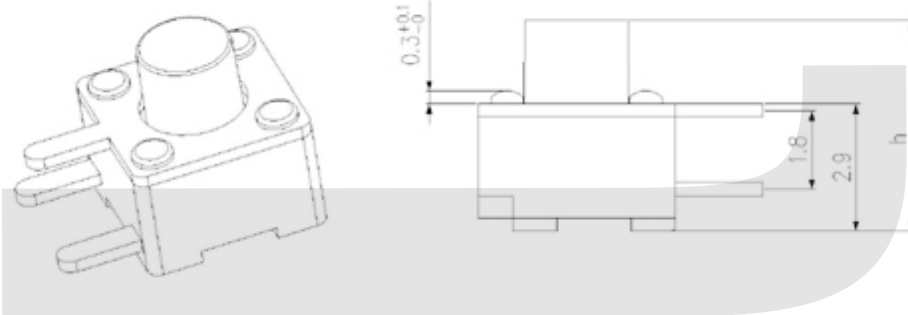

ORDER INFORMATION

KLS7-TS4503 - 3.8 - 180
Series No. Operating Force :180±30gf
Hight: 3.8mm/ 4.8mm/ 7.0mm/ 8.5mm

Tact Switch Series

KLS7-TS4502 4.5x4.5 Tact Switch Series

ELECTRICAL

1. Rating: 50mA 12VDC
2. Contact Resistance : 50mΩ max(initial)
3. Insulation Resistance: 100MΩ(minDC 250V)
4. Dielectric Strength : AC250V(50/60Hz for 1minute)
5. Electrically Life: 100000cycles
6. Environment temperature: -20°C~+70°C
7. Operating Force: 180/250(±30gf)
8. Seal temperature: 260°C~ 280°C

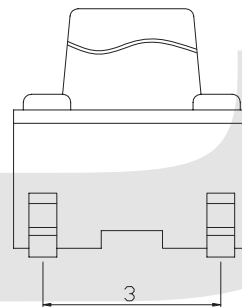
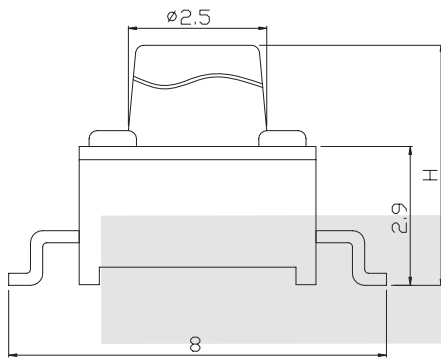

| |
|-----|
| H |
| 3.8 |
| 4.8 |
| 7.0 |
| 8.5 |

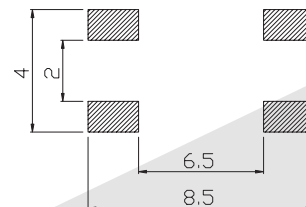
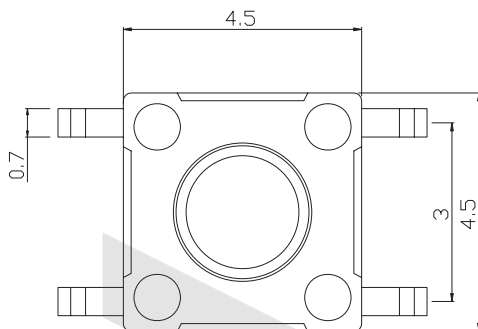

PCB LAYOUT

ORDER INFORMATION

KLS7-TS4502 - H1 - 180 -B

Series No. _____ Packing: B=Bulk T=Tape
 Hight: 3.8mm/4.8mm/7.0mm/8.5mm _____ Operating Force : 180~250gf