

Switch

Tact Switch Series

KLS7-TS6602 6x6mm Tact Switch Series

ELECTRICAL

1. Rating: 50mA 12VDC
2. Contact Resistance : 50mΩ max(initial)
3. Insulation Resistance: 100MΩ(minDC 250V)
4. Dielectric Strength : AC250V(50/60Hz for 1minute)
5. Electrically Life: 100000cycles
6. Environment temperature: -20°C~+70°C
7. Operating Force: 180/250(±30gf)
8. Seal temperature: 260°C~ 280°C

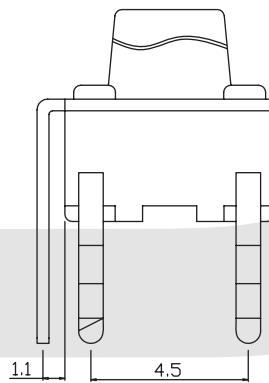
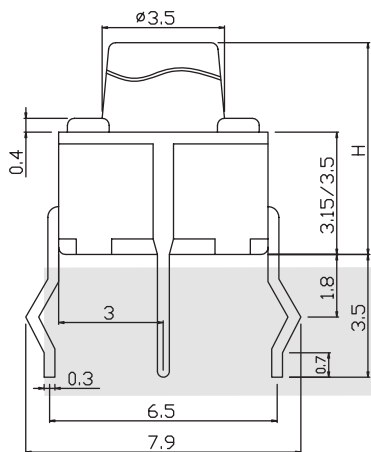

H
4.3
5.0
6.0
7.0
8.0

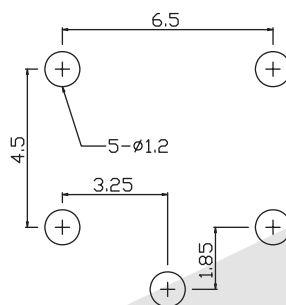
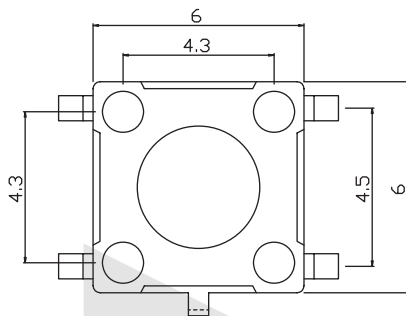

PCB LAYOUT

ORDER INFORMATION

KLS7-TS6602 - 4.3 - 180

Series No.

Operating Force : 180~250gf

Hight: 4.3mm / 5.0mm / 6.0mm / 7.0mm / 8.0mm

Switch

Tact Switch Series

KLS7-TS6603 6x6 Tact Switch Series

ELECTRICAL

1. Rating: 50mA 12VDC
2. Contact Resistance : 50mΩ max(initial)
3. Insulation Resistance: 100MΩ(minDC 250V)
4. Dielectric Strength : AC250V(50/60Hz for 1minute)
5. Electrically Life: 100000cycles
6. Environment temperature: -20°C~+70°C
7. Operating Force: 180/250(±30gf)
8. Seal temperature: 260°C~ 280°C



VII

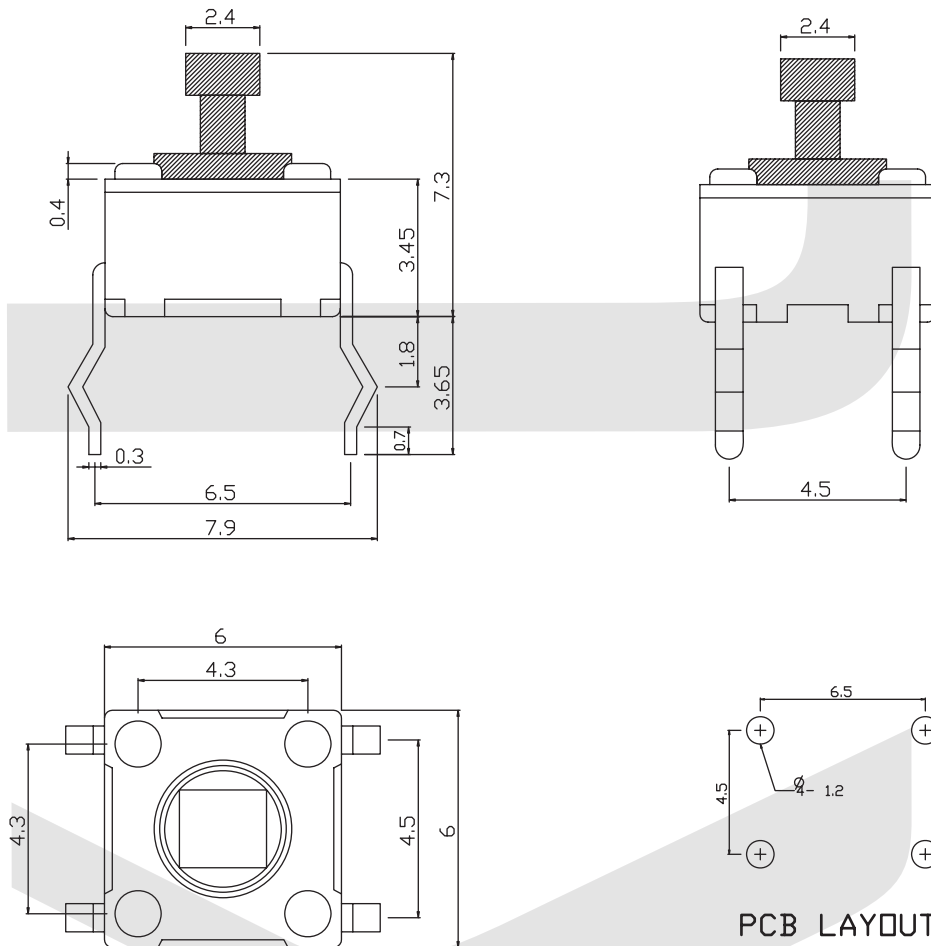

ORDER INFORMATION

KLS7-TS6603 - 180 - B

Series No. _____

Handle Color: B-Black Y-Yellow
Operating Force :180~250gf

Tact Switch Series

KLS7-TS6604 6x6 Tact Switch Series

ELECTRICAL

1. Rating: 50mA 12VDC
2. Contact Resistance : 50mΩ max(initial)
3. Insulation Resistance: 100MΩ(minDC 250V)
4. Dielectric Strength : AC250V(50/60Hz for 1minute)
5. Electrically Life: 100000cycles
6. Environment temperature: -20°C~+70°C
7. Operating Force: 180/250(±30gf)
8. Seal temperature: 260°C~ 280°C



Dimension (unit: mm)

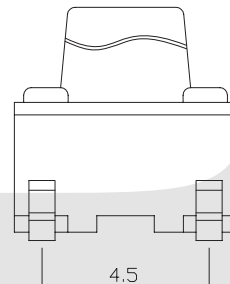
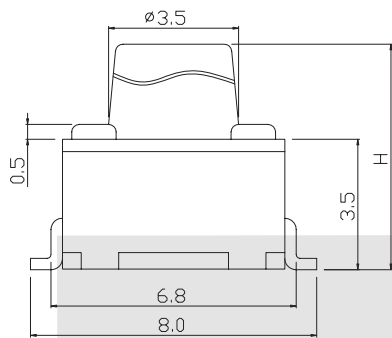

H
4.3
5.0
6.0
7.0
8.0

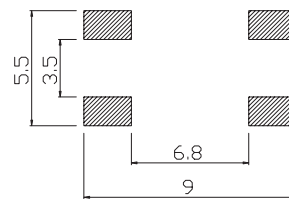
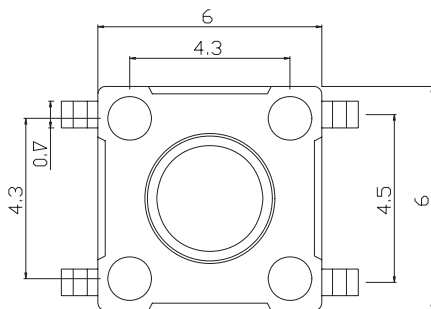

PCB LAYOUT

ORDER INFORMATION

KLS7-TS6604 -4.3- 180- T

Series No. _____ Packing: B=Bulk T=Tape
 Hight: 4.3mm/5.0mm/6.0mm/
 7.0mm/8.0mm Operating Force : 180~250gf

Tact Switch Series

KLS7-TS6604B 6x6 Tact Switch Series

ELECTRICAL

1. Rating: 50mA 12VDC
2. Contact Resistance : 50mΩ max(initial)
3. Insulation Resistance: 100MΩ(minDC 250V)
4. Dielectric Strength : AC250V(50/60Hz for 1minute)
5. Electrically Life: 100000cycles
6. Environment temperature: -20°C~+70°C
7. Operating Force: 180/250(±30gf)
8. Seal temperature: 260°C~ 280°C

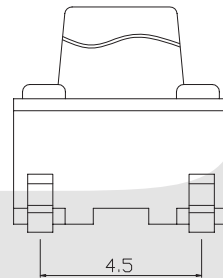
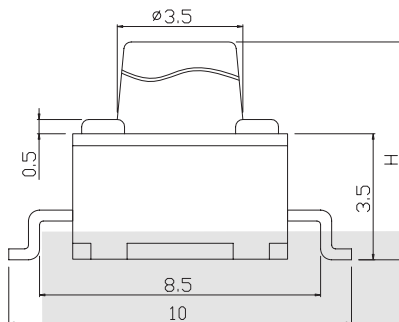

H
4.3
5.0
6.0
7.0
8.0

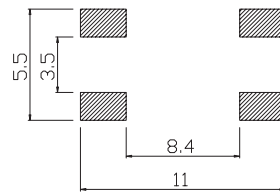
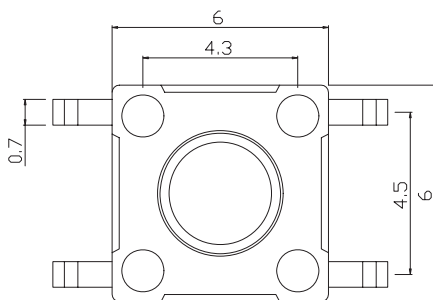

PCB LAYOUT

ORDER INFORMATION

KLS7-TS6604B -4.3- 180- T

Series No. _____ Packing: B=Bulk T=Tape
 High: 4.3mm/5.0mm/6.0mm/
 7.0mm/8.0mm Operating Force : 180~250gf

Tact Switch Series

KLS7-TS6605 6x6 Tact Switch Series

ELECTRICAL

- 1.Rating: 50mA 12VDC
- 2.Contact Resistance : 50mΩ max(initial)
- 3.Insulation Resistance: 100MΩ(minDC 250V)
- 4.Dielectric Strength : AC250V(50/60Hz for 1minute)
- 5.Electrically Life: 100000cycles
- 6.Environment temperature:-20°C~+70°C
- 7.Operating Force: 180/250(±30gf)
- 8.Seal temperature:260°C~ 280°C

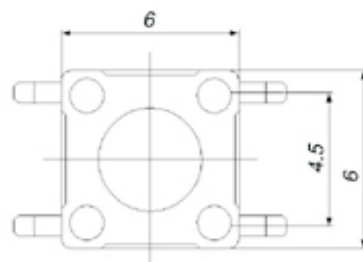
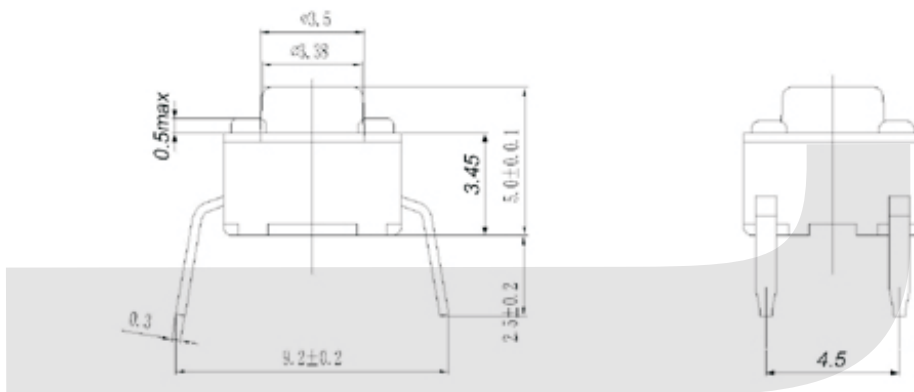

ORDER INFORMATION

KLS7-TS6605 - H1 - 180 -B

Part Number

Packing: B-Bulk

Operating Force :180~250gf

Hight: H1=4.3mm H2=5.0mm H3=6.0mm
H4=7.0mm H5=8.0mm H6=9.5mm

Tact Switch Series

KLS7-TS6606 6x6 Tact Switch Series

ELECTRICAL

1. Rating: 50mA 12VDC
2. Contact Resistance : 50mΩ max(initial)
3. Insulation Resistance: 100MΩ(minDC 250V)
4. Dielectric Strength : AC250V(50/60Hz for 1minute)
5. Electrically Life: 100000cycles
6. Environment temperature: -20°C~+70°C
7. Operating Force: 180/250(±30gf)
8. Seal temperature: 260°C~ 280°C



Dimension (unit: mm)

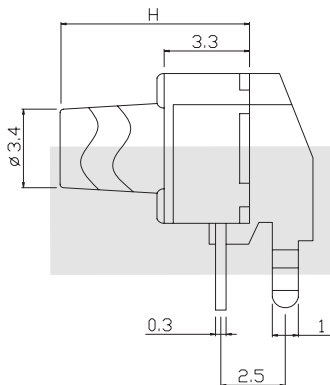

H
4.3
5.0
6.0
7.0
8.0
13.0

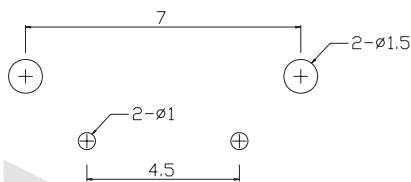
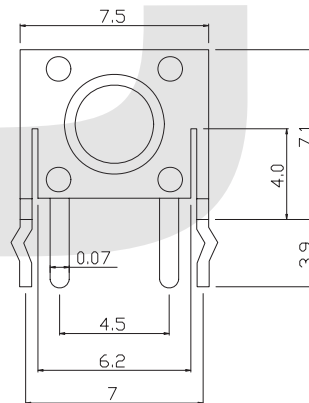

PCB LAYOUT

ORDER INFORMATION

KLS7-TS6606 -4.3-180

Series No. _____ Operating Force :180~250gf
 Hight: 4.3mm/5.0mm/6.0mm/
 7.0mm/8.0mm/13.0mm

Tact Switch Series

KLS7-TS6606A-H2-160gf 6x6 Long life Tact switch Series

ELECTRICAL

1. Rating: 50mA 12VDC
2. Contact Resistance: 100 mΩ max
3. Insulation Resistance: 100MΩ min DC250V
4. Dielectric Strength : AC250V(50/60Hz for 1minute)
5. Electrically Life: 1000000 cycles
6. Environment temperature: -30°C~+80°C
7. Operating Force: 160 (±30gf)
8. Seal temperature: 260°C~ 280°C

Materials

- Cover :Stainless steel or spcc
- Base:UL94V-0 Nylon Thermoplastic (Black)
- Stem:UL94V-0 Nylon Thermoplastic
- Contact Disc :Phosphor bronze with silver cladding
- Terminal:Brass with silver cladding

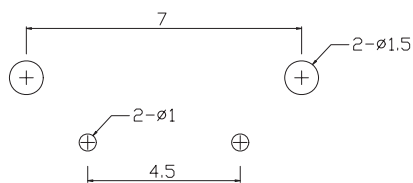
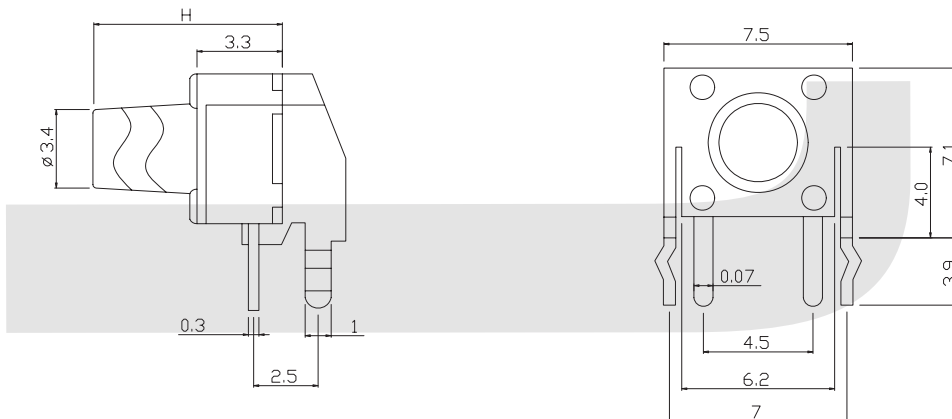

PCB LAYOUT

H1=4.3mm
H2=5.0mm
H3=7.0mm
H4=7.5mm
H5=9.5mm
H6=13mm

ORDER INFORMATION

KLS7-TS6606A - H2 - 160

Part Number

Operating Force :160~250gf

Hight: H1=4.3mm H2=5.0mm H3=7.0mm
H4=7.5mm H5=9.5mm H6=13mm

Switch

Tact Switch Series

KLS7-TS6607 6x6mm Tact Switch Series

ELECTRICAL

1. Rating: 50mA 12VDC
2. Contact Resistance : 50mΩ max(initial)
3. Insulation Resistance: 100MΩ(minDC 250V)
4. Dielectric Strength : AC250V(50/60Hz for 1minute)
5. Electrically Life: 100000cycles
6. Environment temperature: -20°C~+70°C
7. Operating Force: 180/250(±30gf)
8. Seal temperature: 260°C~ 280°C

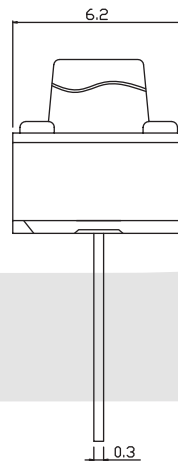
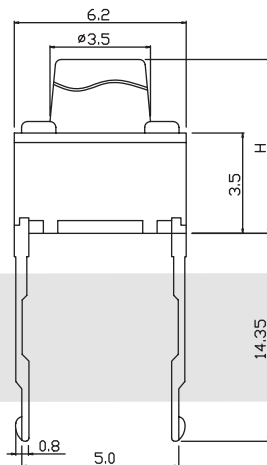

H
4.3
5.0
6.0
7.0
8.0

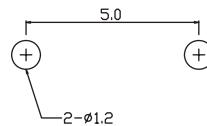
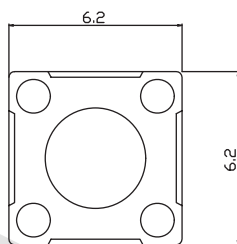

PCB LAYOUT

ORDER INFORMATION

KLS7-TS6607 - 4.3 - 180 - B

Series No. _____ Packing: B=Bulk T=Tape
Hight: 4.3mm/5.0mm/6.0mm/
7.0mm/8.0mm Operating Force : 180~250gf

Tact Switch Series

KLS7-TS6608 6x6mm Tact Switch Series

ELECTRICAL

1. Rating: 50mA 12VDC
2. Contact Resistance : 50mΩ max(initial)
3. Insulation Resistance: 100MΩ(minDC 250V)
4. Dielectric Strength : AC250V(50/60Hz for 1minute)
5. Electrically Life: 100000cycles
6. Environment temperature: -20°C~+70°C
7. Operating Force: 180/250(±30gf)
8. Seal temperature: 260°C~ 280°C

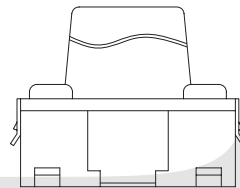
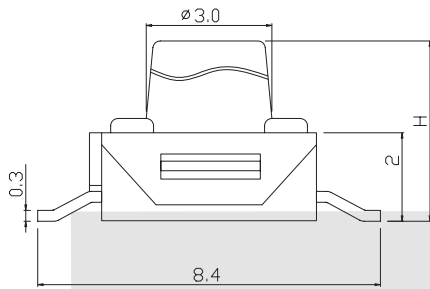
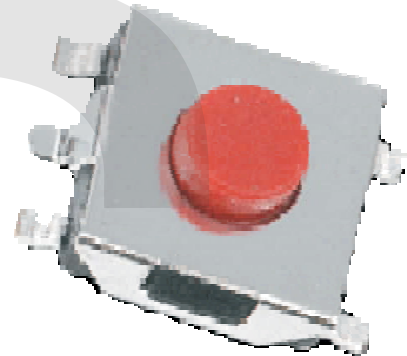

H
2.5
2.7
3.1
3.7
5.1

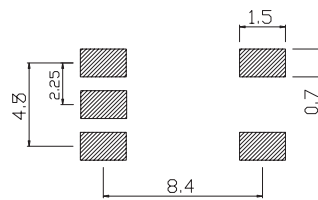
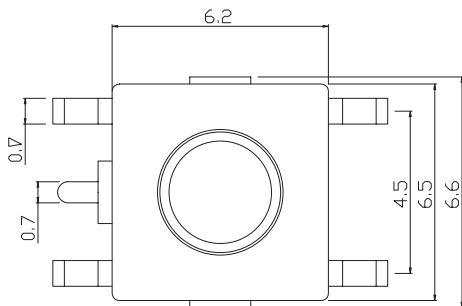

PCB LAYOUT

ORDER INFORMATION

KLS7-TS6608 - 2.5 - 180 - B

Series No. _____
Hight: 2.5mm/2.7mm/3.1mm/
3.7mm/5.1mm

Packing: B=Bulk T=Tape
Operating Force : 180~250gf

Tact Switch Series

KLS7-TS6609 6x6mm Tact Switch Series

ELECTRICAL

1. Rating: 50mA 12VDC
2. Contact Resistance : 50mΩ max(initial)
3. Insulation Resistance: 100MΩ(minDC 250V)
4. Dielectric Strength : AC250V(50/60Hz for 1minute)
5. Electrically Life: 100000cycles
6. Environment temperature: -20°C~+70°C
7. Operating Force: 180/250(±30gf)
8. Seal temperature: 260°C~ 280°C

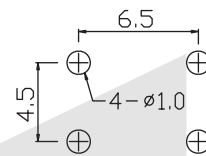
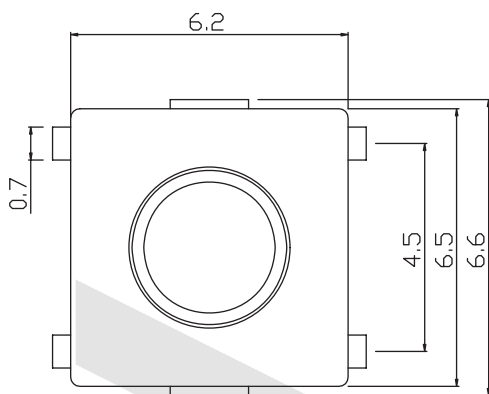
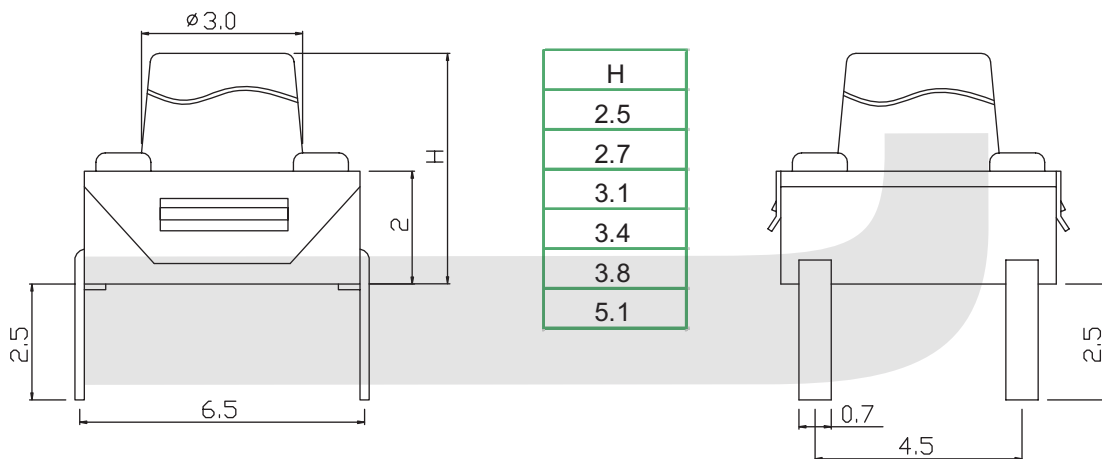

PCB LAYOUT

ORDER INFORMATION

KLS7-TS6609 - 2.5 - 180

Series No. _____

Hight: 2.5mm/2.7mm/3.1mm/
3.4mm/3.8mm/5.1mm

Operating Force : 180~250gf

Tact Switch Series

KLS7-TS6611 6x6 Tact Switch Series

ELECTRICAL

1. Rating: 50mA 12VDC
2. Contact Resistance : 50mΩ max(initial)
3. Insulation Resistance: 100MΩ(minDC 250V)
4. Dielectric Strength : AC250V(50/60Hz for 1minute)
5. Electrically Life: 100000cycles
6. Environment temperature: -20°C~+70°C
7. Operating Force: 180/250(±30gf)
8. Seal temperature: 260°C~ 280°C



H
1.5
1.7
1.9

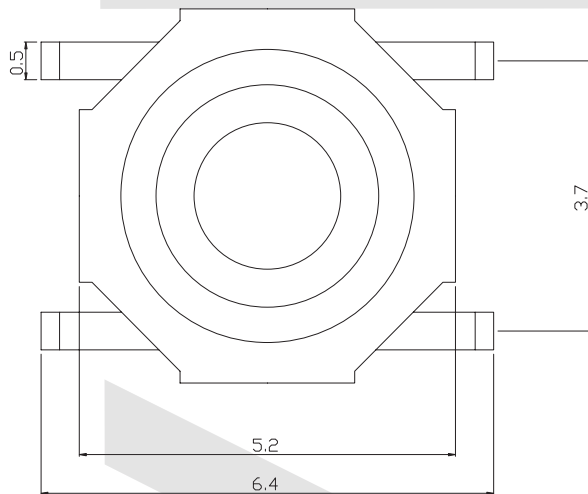
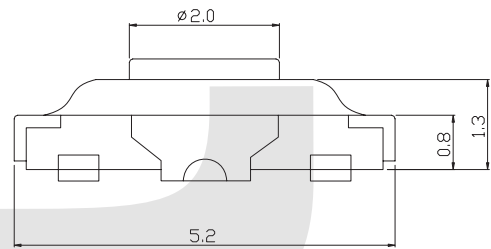
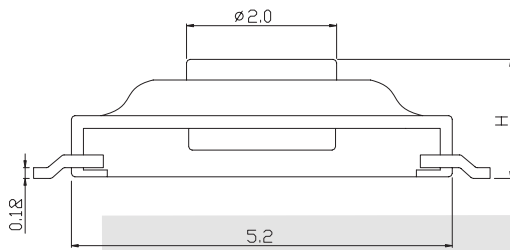

H1=1.5mm
H2=1.7mm
H3=1.9mm

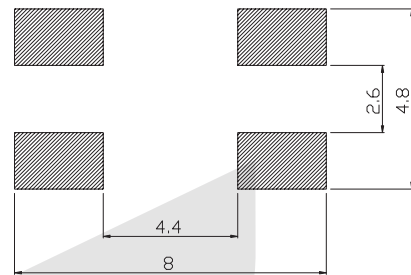

PCB LAYOUT

ORDER INFORMATION

KLS7-TS6611 - 1.5 - 180 -T

Series No.

Hight: 1.5mm/1.7mm/1.9mm

Packing: B-Bulk T-Tape

Operating Force : 180~250gf

Switch

Tact Switch Series

KLS7-TS6611B 5.20 x 5.20mm Tact Switch Series

ELECTRICAL

- 1.Rating: 20mA 12Vdc
- 2.Contact Resistance : 50mΩ Max.
- 3.Insulation Resistance: 100MΩ Min.
- 4.Dielectric Strength : AC250V(50/60Hz for 1minute)
- 5.Electrically Life: 100, 000cycles
- 6.Environment temperature:-25°C~+70°C
- 7.Operating Force: 180~250±30gf
- 8.Seal temperature:260°C~ 280°C



VII

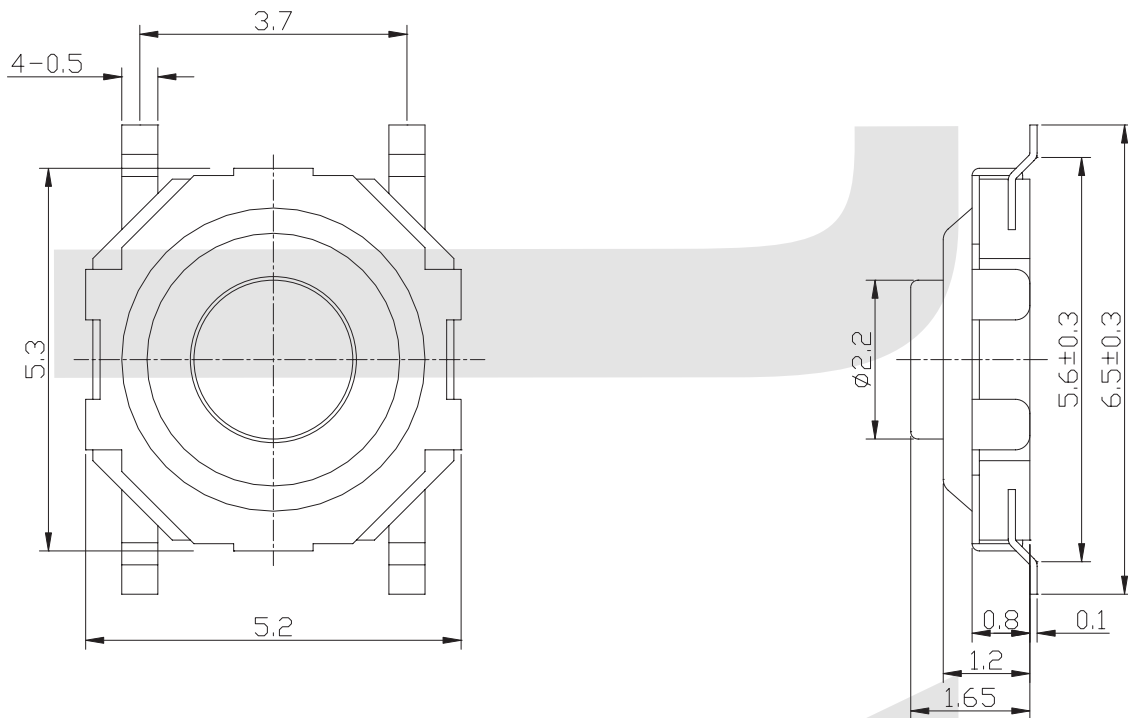

ORDER INFORMATION

KLS7-TS6611B - 180 -B

Series No.

Packing: B-Bulk T-Tape
Operating Force :180±30gf

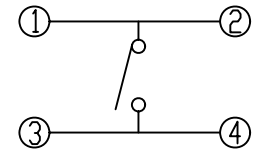
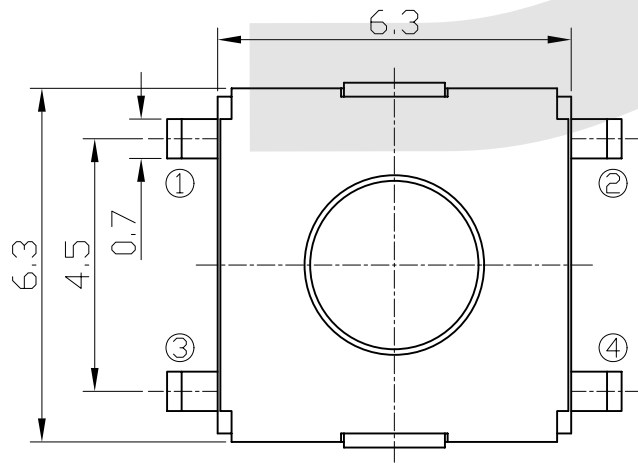

SCHEMATIC

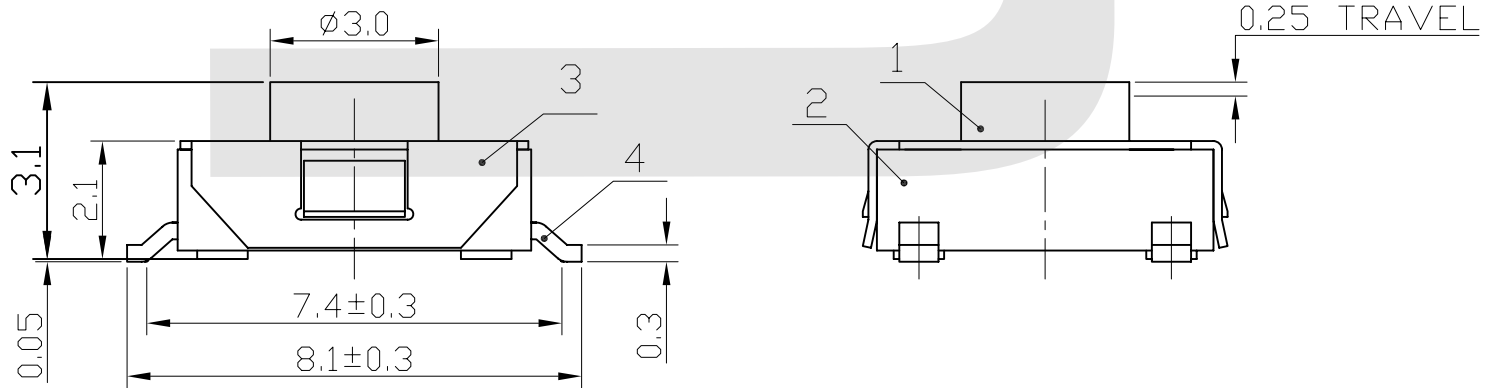

KLS ELECTRONIC CO.,LTD

KLS7-TS6612-H3.1

UNIT :	MM	DWN.	陈镇铭	DATE	2010-04-10	TOLERANCE	ANGLE TOL
SCALE :	6 : 1	CHK'D	侯美萍	DATE	2010-04-10	<=1.5mm ±0.1	±2°
VERSION	01	APPD.	周丽琼	DATE	2010-04-10	> 1.5mm ±0.2	

NO.	PART NAME	MATERIAL	QTY	FINISHING
5	CONTACT	PBS STRIP	1	Ag CLAD
4	TERMINAL	BRASS STRIP	4	Ag PLATED
3	COVER	SUS	1	Ag PLATED
2	CASE	NYLON	1	BLACK
1	KNOB	NYLON	1	BLACK

Switch

Tact Switch Series

KLS7-TS6613 6x6mm Tact Switch Series

ELECTRICAL

1. Rating: 50mA 12VDC
2. Contact Resistance : 50mΩ max(initial)
3. Insulation Resistance: 100MΩ(minDC 250V)
4. Dielectric Strength : AC250V(50/60Hz for 1minute)
5. Electrically Life: 100000cycles
6. Environment temperature: -20°C~+70°C
7. Operating Force: 180/250(±30gf)
8. Seal temperature: 260°C~ 280°C

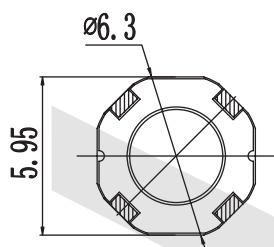
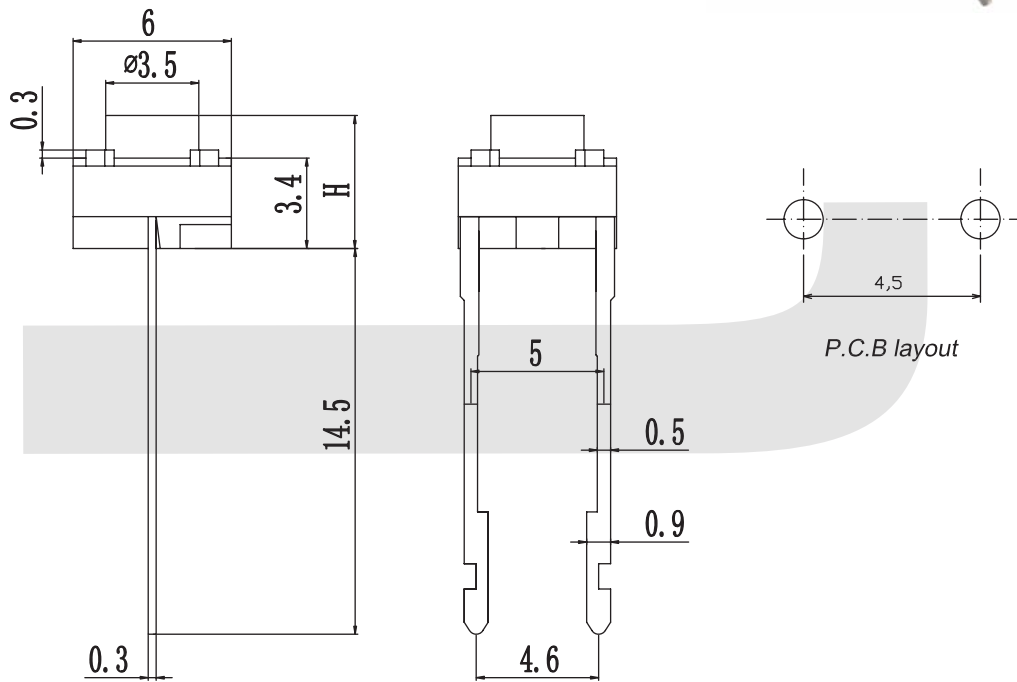

H
4.3
5.0

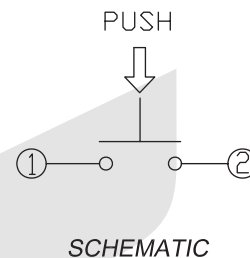

ORDER INFORMATION

KLS7-TS6613 - 4.3 - 180 - B

Series No.

Height: 4.3mm/5.0mm

Packing: B=Bulk T=Tape

Operating Force : 180~250gf

Tact Switch Series

KLS7-TS6615 6x6 Tact Switch Series

ELECTRICAL

1. Rating: 50mA 12VDC
2. Contact Resistance : 50mΩ max(initial)
3. Insulation Resistance: 100MΩ(minDC 250V)
4. Dielectric Strength : AC250V(50/60Hz for 1minute)
5. Electrically Life: 100000cycles
6. Environment temperature: -20°C~+70°C
7. Operating Force: 180/250(±30gf)
8. Seal temperature: 260°C~ 280°C

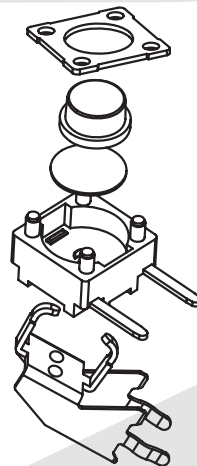
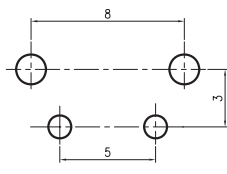
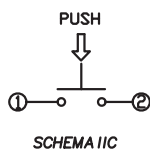
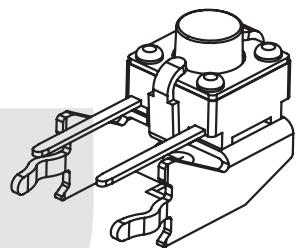
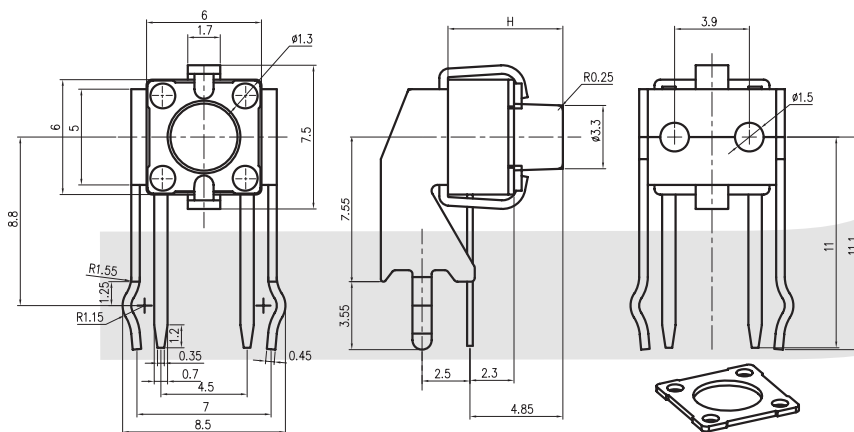

ORDER INFORMATION

KLS7-TS6615 - H1 - 180 -B

Part Number

Packing: B-Bulk

Operating Force :180~250gf

Hight: H1=4.3mm H2=5.0mm H3=6.0mm
H4=7.0mm

Tact Switch Series

KLS7-TS6616 6x6 Tact Switch Series

ELECTRICAL

1. Rating: 50mA 12VDC
2. Contact Resistance : 50mΩ max(initial)
3. Insulation Resistance: 100MΩ(minDC 250V)
4. Dielectric Strength : AC250V(50/60Hz for 1minute)
5. Electrically Life: 100000cycles
6. Environment temperature: -20°C~+70°C
7. Operating Force: 180/250(±30gf)
8. Seal temperature: 260°C~ 280°C

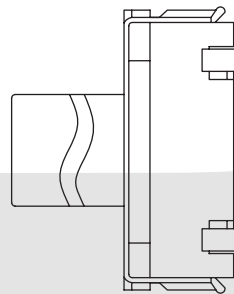
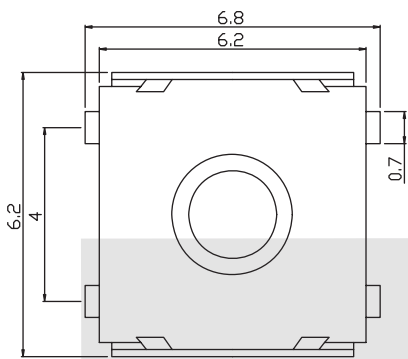
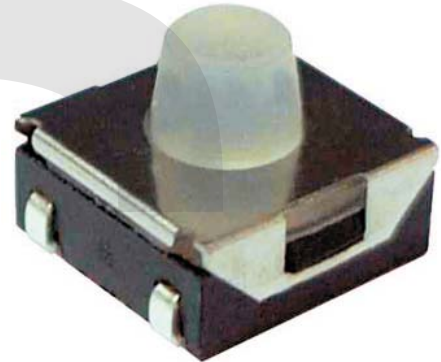

H	A
3.4	2.9
5.1	2.5

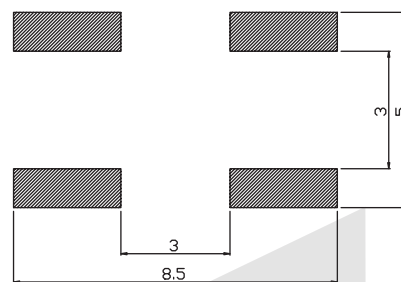
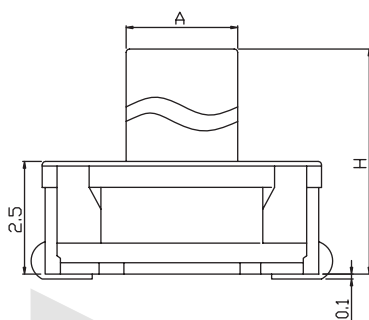

PCB LAYOUT

ORDER INFORMATION

KLS7-TS6612 - 3.4 - 180 - B

Series No.

Hight: 3.4mm/5.1mm

Packing: B=Bulk T=Tape

Operating Force :180~250gf

Tact Switch Series

KLS7-TS6651 6x6 Tact Switch Series

ELECTRICAL

- 1.Rating: 50mA 12VDC
- 2.Contact Resistance : 50mΩ max(initial)
- 3.Insulation Resistance: 100MΩ(minDC 250V)
- 4.Dielectric Strength : AC250V(50/60Hz for 1minute)
- 5.Electrically Life: 100000cycles
- 6.Environment temperature:-20°C~+70°C
- 7.Operating Force: 180/250(±30gf)
- 8.Seal temperature:260°C~ 280°C

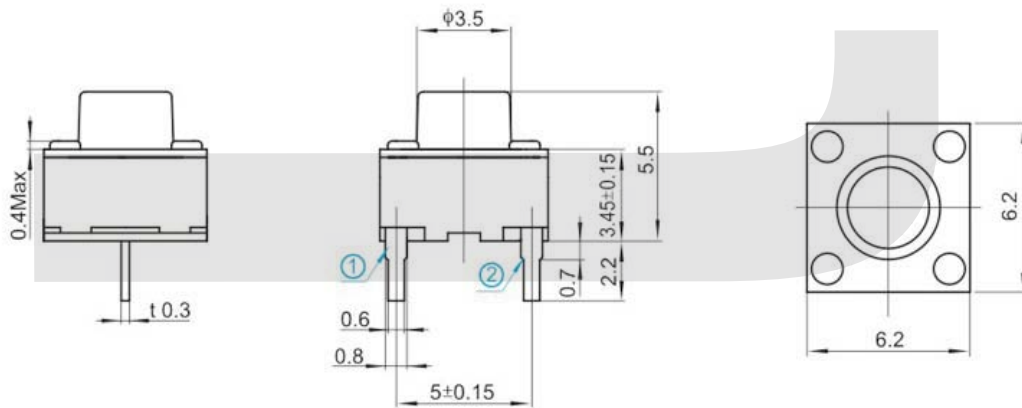

ORDER INFORMATION

KLS7-TS6651 - H1 - 180 -B

Part Number

Packing: B-Bulk

Operating Force :180~250gf

Hight: H1=4.3mm H2=5.0mm H3=6.0mm
H4=7.0mm H5=7.5mm

Tact Switch Series

KLS7-TS6652 6x6 Tact Switch Series

ELECTRICAL

- 1. Rating: 50mA 12VDC
- 2. Contact Resistance : 50mΩ max(initial)
- 3. Insulation Resistance: 100MΩ(minDC 250V)
- 4. Dielectric Strength : AC250V(50/60Hz for 1minute)
- 5. Electrically Life: 100000cycles
- 6. Environment temperature: -20°C~+70°C
- 7. Operating Force: 180/250(±30gf)
- 8. Seal temperature: 260°C~ 280°C

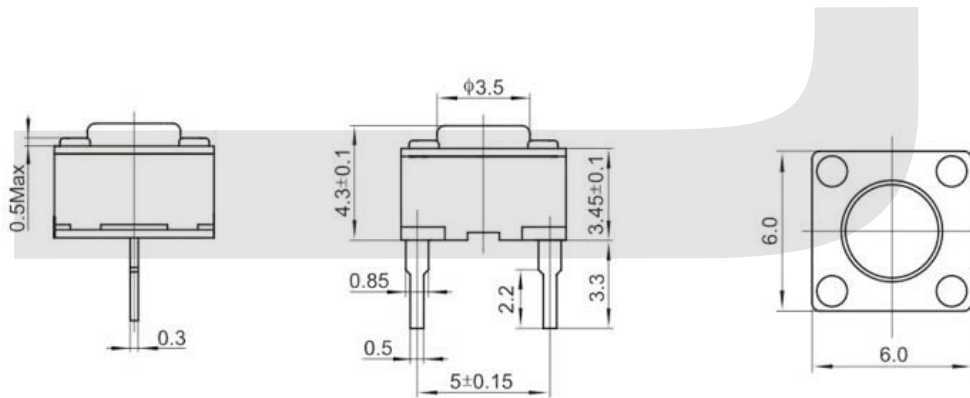

ORDER INFORMATION

KLS7-TS6652 - H1 - 180 -B

Part Number

Packing: B-Bulk

Operating Force :180~250gf

Hight: H1=4.3mm H2=5.0mm H3=6.0mm
H4=7.0mm H5=7.5mm

Tact Switch Series

KLS7-TS6653 6x6 Tact Switch Series

ELECTRICAL

1. Rating: 50mA 12VDC
2. Contact Resistance : 50mΩ max(initial)
3. Insulation Resistance: 100MΩ(minDC 250V)
4. Dielectric Strength : AC250V(50/60Hz for 1minute)
5. Electrically Life: 100000cycles
6. Environment temperature: -20°C~+70°C
7. Operating Force: 180/250(±30gf)
8. Seal temperature: 260°C~ 280°C

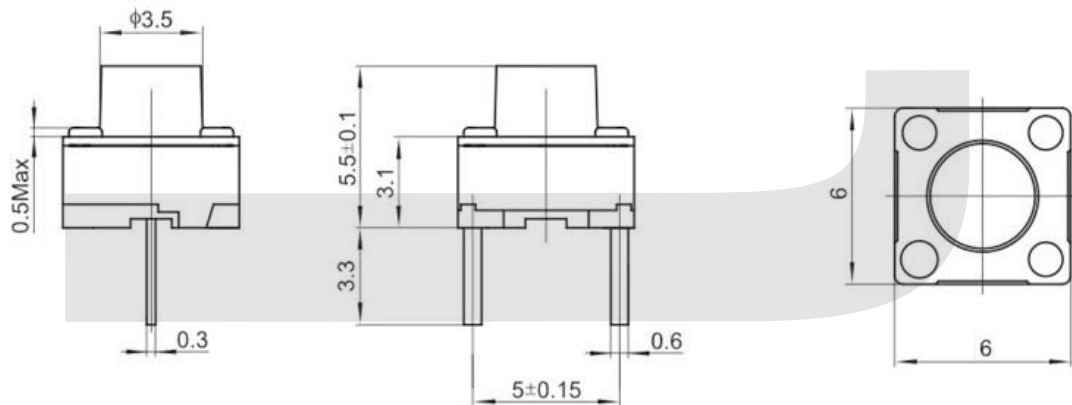

ORDER INFORMATION

KLS7-TS6653 - H1 - 180 -B

Part Number

Packing: B-Bulk

Operating Force :180~250gf

Hight: H1=4.3mm H2=5.0mm H3=6.0mm
H4=7.0mm H5=7.5mm

Tact Switch Series

KLS7-TS6654 6x6 Tact Switch Series

ELECTRICAL

1. Rating: 50mA 12VDC
2. Contact Resistance : 50mΩ max(initial)
3. Insulation Resistance: 100MΩ(minDC 250V)
4. Dielectric Strength : AC250V(50/60Hz for 1minute)
5. Electrically Life: 100000cycles
6. Environment temperature: -20°C~+70°C
7. Operating Force: 180/250(±30gf)
8. Seal temperature: 260°C~ 280°C

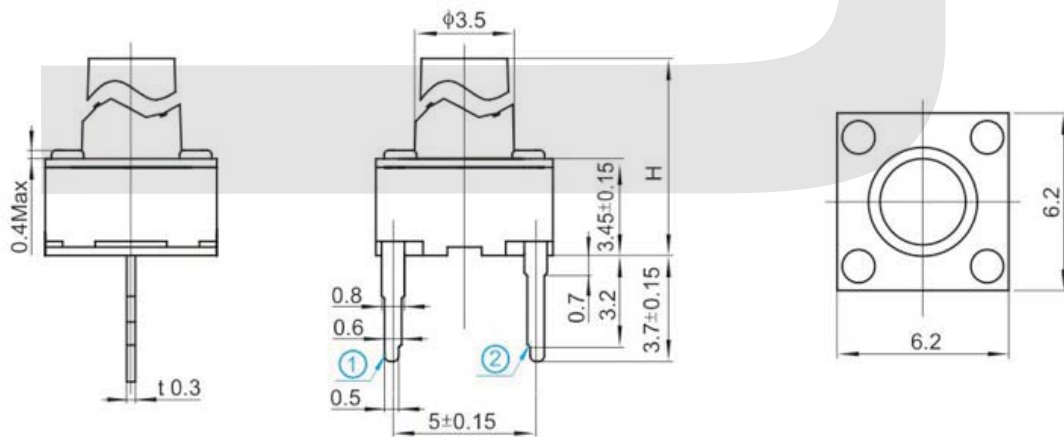

ORDER INFORMATION

KLS7-TS6654 - H1 - 180 -B

Part Number

Packing: B-Bulk

Operating Force :180~250gf

Hight: H1=4.3mm H2=5.0mm H3=6.0mm
H4=7.0mm H5=7.5mm

Tact Switch Series

KLS7-TS6657 6x6 Tact Switch Series

ELECTRICAL

1. Rating: 50mA 12VDC
2. Contact Resistance : 50mΩ max(initial)
3. Insulation Resistance: 100MΩ(minDC 250V)
4. Dielectric Strength : AC250V(50/60Hz for 1minute)
5. Electrically Life: 100000cycles
6. Environment temperature: -20°C~+70°C
7. Operating Force: 180/250(±30gf)
8. Seal temperature: 260°C~ 280°C

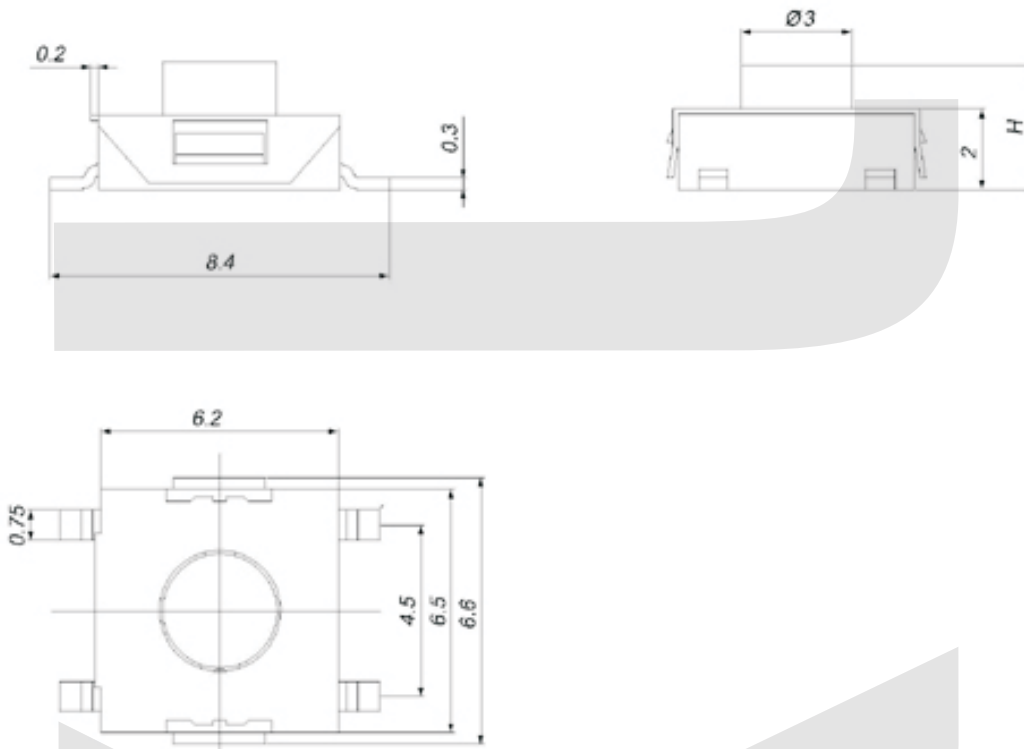

ORDER INFORMATION

KLS7-TS6657 - H1 - 180 -B

Part Number

Packing: B-Bulk

Operating Force :180~250gf

Hight: H1=2.5mm H2=2.7mm H3=3.1mm
H4=3.4mm H5=3.7mm H6=5.1mm
H7=5.5mm

Tact Switch Series

KLS7-TS6660 6x6 Tact Switch Series

ELECTRICAL

- 1.Rating: 50mA 12VDC
- 2.Contact Resistance : 50mΩ max(initial)
- 3.Insulation Resistance: 100MΩ(minDC 250V)
- 4.Dielectric Strength : AC250V(50/60Hz for 1minute)
- 5.Electrically Life: 100000cycles
- 6.Environment temperature:-20°C~+70°C
- 7.Operating Force: 180/250(±30gf)
- 8.Seal temperature:260°C~ 280°C

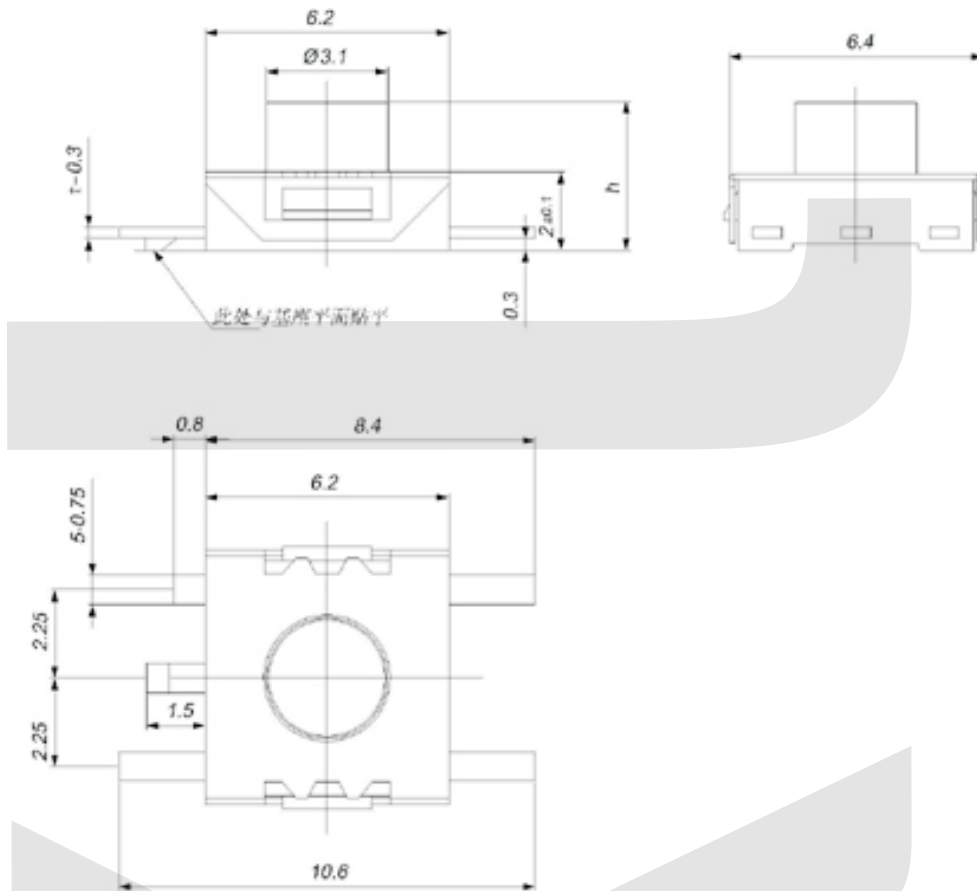

ORDER INFORMATION

KLS7-TS6660 - H1 - 180 -B

Part Number

Packing: B-Bulk T-Tape

Operating Force :180~250gf

Hight: H1=2.5mm H2=3.8mm H3=4.3mm

Tact Switch Series

KLS7-TS6661 6x6 Tact Switch Series

ELECTRICAL

1. Rating: 50mA 12VDC
2. Contact Resistance : 50mΩ max(initial)
3. Insulation Resistance: 100MΩ(minDC 250V)
4. Dielectric Strength : AC250V(50/60Hz for 1minute)
5. Electrically Life: 100000cycles
6. Environment temperature: -20°C~+70°C
7. Operating Force: 180/250(±30gf)
8. Seal temperature: 260°C~ 280°C

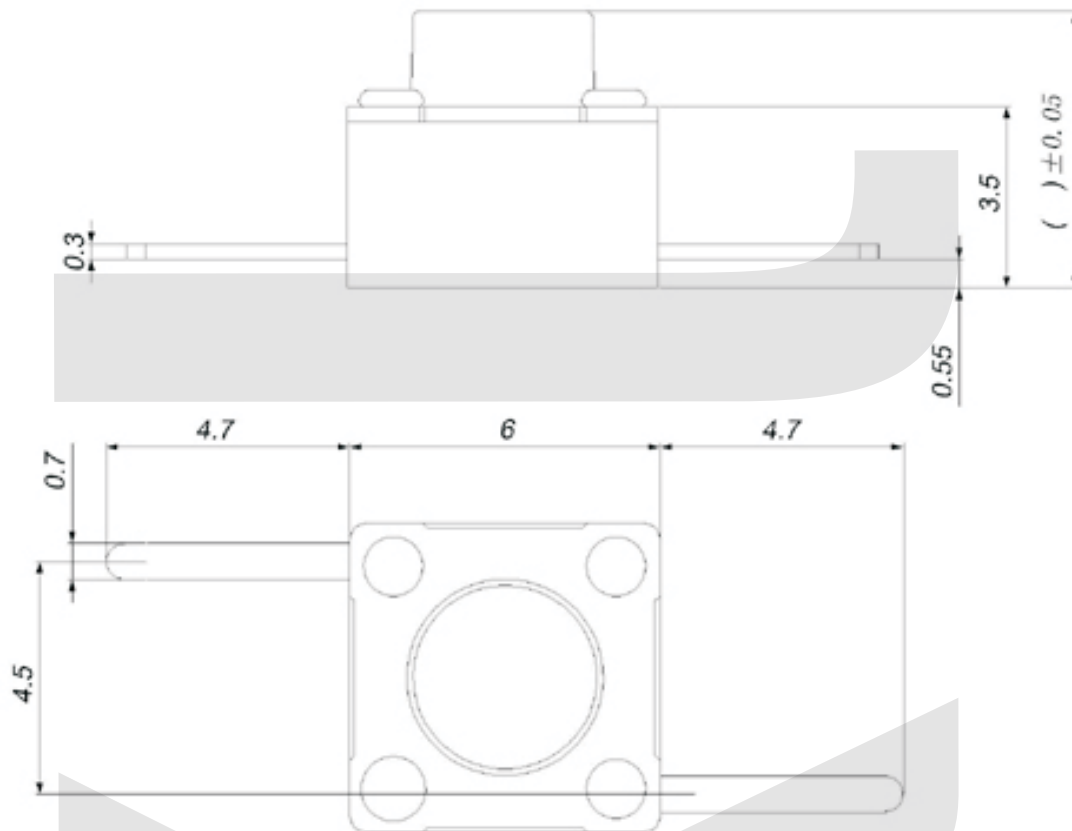
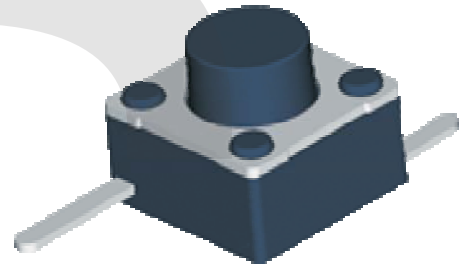

ORDER INFORMATION

KLS7-TS6661 - H1 - 180 -B

Part Number

Packing: B-Bulk

Operating Force :180~250gf

Hight: H1=4.3mm H2=5.0mm H3=6.0mm
H4=7.0mm

Switch

Tact Switch Series

KLS7-TS3618 6.20 x 6.20mm Tact Switch Series

ELECTRICAL

1. Rating: 50mA 12Vdc
2. Contact Resistance : 50mΩ Max.
3. Insulation Resistance: 100MΩ Min.
4. Dielectric Strength : AC250V(50/60Hz for 1minute)
5. Electrically Life: 100, 000cycles
6. Environment temperature: -25°C~+70°C
7. Operating Force: 180±30gf
8. Seal temperature: 260°C~ 280°C



VII

Dimension (unit: mm)

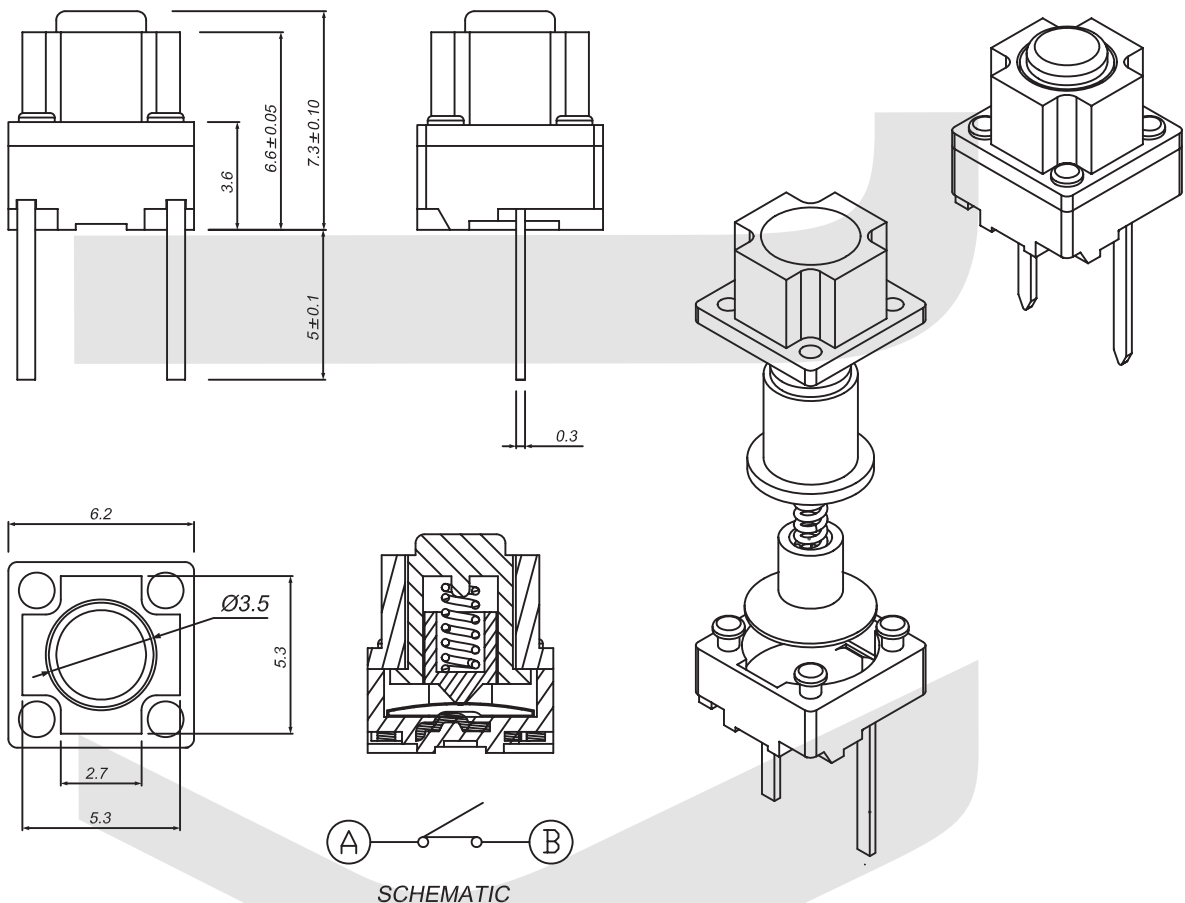

ORDER INFORMATION

KLS7-TS3618 - 70 -B
Series No. _____ Packing: B-Bulk
Operating Force : 70±30gf